

SOHO RETAIL

452 BROADWAY

FOR LEASE



FOR MORE INFORMATION ABOUT 452 BROADWAY:  
GREG KIM | 646.470.1717 | greg@sequoiapg.com

**SEQUOIA**  
PROPERTY GROUP



# FLOOR PLANS

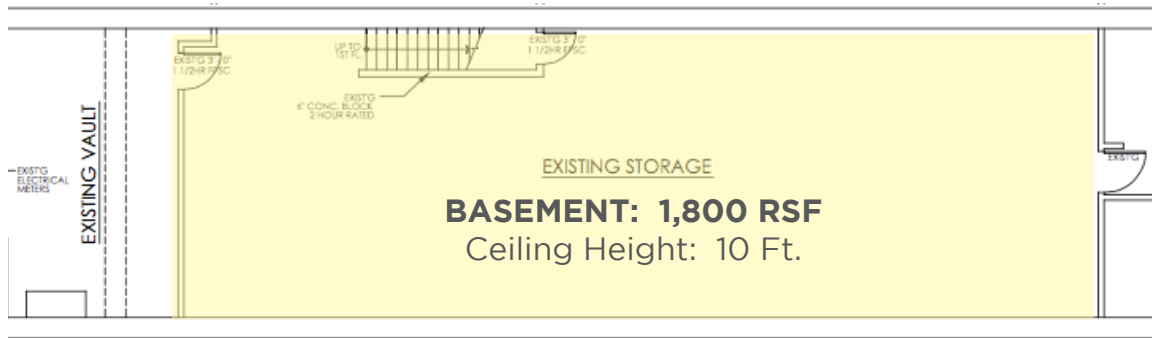
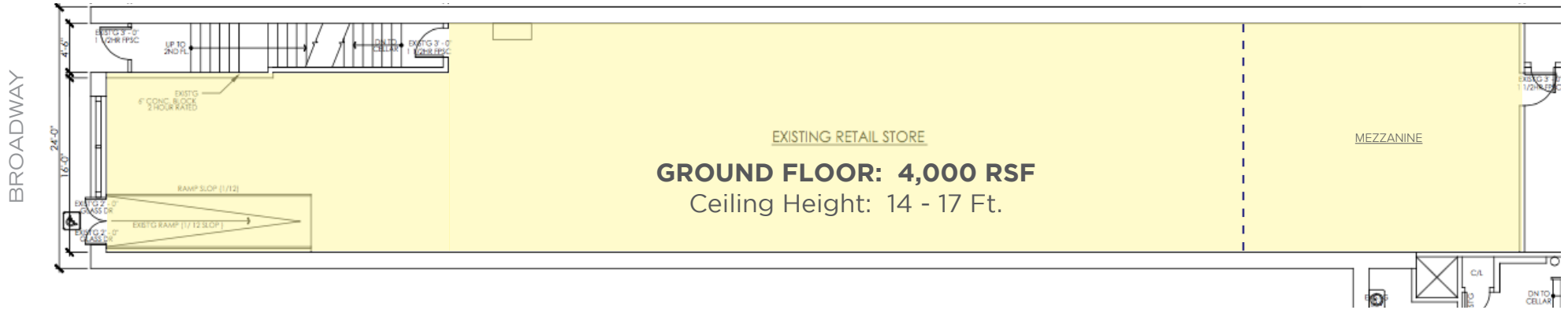

FLOOR AREA	
Ground:	4,000 SF
Basement:	1,800 SF
Mezzanine:	500 SF
<b>TOTAL:</b>	<b>6,300 SF</b>

FOR MORE INFORMATION ABOUT 452 BROADWAY:  
GREG KIM | 646.470.1717 | [greg@sequoiapg.com](mailto:greg@sequoiapg.com)

© Sequoia Property Group. All rights reserved. All information contained herein is from sources deemed reliable; however, no representation or warranty is made to the accuracy thereof.

# RETAILER MAP



BROOME ST

U.S. POLO ASSN.  
BROADWAY MARKET  
LULULEMON

MADEWELL  
J. CREW MEN'S SHOP  
TOPSHOP  
CITIBANK  
TIMBERLAND  
ALDO

GRAND ST

STARBUCKS  
BOSE  
WELLS FARGO  
DUANE READE /  
YOGAWORKS  
MUJI  
CB2

BROADWAY

NEW RETAIL  
SABON  
SAGA SHOES  
MYSTIQUE BOUTIQUE  
**452 BROADWAY**  
VALLEY NATIONAL BANK

NECESSARY CLOTHING  
GSTAR RAW

NECESSARY CLOTHING  
FOOT LOCKER  
MUJI POP-UP

HOWARD ST

SOHO ECLECTIC



FOR MORE INFORMATION ABOUT 452 BROADWAY:  
GREG KIM | 646.470.1717 | [greg@sequoiapg.com](mailto:greg@sequoiapg.com)

**SEQUOIA**  
PROPERTY GROUP



# 452 BROADWAY

SOHO, NYC

**BEST RENTAL VALUE ON BROADWAY SOHO**

**GRADE LEVEL ENTRANCE AND INTERIOR ADA RAMP**

**NEIGHBORS INCLUDE NATIONAL & INTERNATIONAL RETAILERS**

**SITUATED ON ONE OF NYC'S TOP RETAIL CORRIDORS**

**COLUMN-FREE GROUND FLOOR INTERIOR**

**AVAILABLE JANUARY 2018**

FOR MORE INFORMATION ABOUT 452 BROADWAY:  
GREG KIM | 646.470.1717 | [greg@sequoiapg.com](mailto:greg@sequoiapg.com)

**SEQUOIA**  
PROPERTY GROUP