

FOR LEASE | 1ST FLOOR RETAIL

KAMAOLE SHOPPING CENTER

2463

SOUTH KIHEI ROAD

Kihei, HI 96753



PROPERTY DESCRIPTION

Kamaole Shopping Center is located on Kihei's Gold Coast and enjoys great foot traffic from the surrounding resort and residential communities. Long term tenants such as: Whaler's General Store, Maui Clothing Company, Subway, Maui Ocean Arts, The Cinnamon Roll Place, Kihei Aloha Ice Cream, Take Home Treasures, Maui Nail Spa, Aloha Motorsport, and our newest tenants, Wyndham Vacation Resorts and Maui Gift Outlets.

- + Space Available:
 - + *Unit B-24 - 5,400 SF (Restaurant)
 - + *Unit C-21 - 5,100 SF (Restaurant)
 - + Retail Kiosk - 100 SF - \$7,500/Month NNN
- + *Base Rent: \$2.50 PSF/Month (Estimated)
- + Percentage Rent: 8%-10%
- + Operating Expenses: \$1.06 PSF/Month
- + Term: 5 Years



KEY FEATURES

- + Only one retail unit available on 2nd Floor
- + Heavy traffic and great visibility from Kihei Road
- + Walking distance to resort condominiums and Kihei's best beaches



CONTACT US

SCOTT A. CROCKFORD (B)

Vice President

+1 808 446 8771

scott.crockford@cbre.com

MOE A. SEARS (B), MBA

Associate

+1 808 214 7776

moe.sears@cbre.com

www.cbre.com/hawaii

CBRE

FOR LEASE KAMAOLE SHOPPING CENTER

2463
SOUTH KIHEI ROAD
KIHEI, HI 96753

THE LOCATION

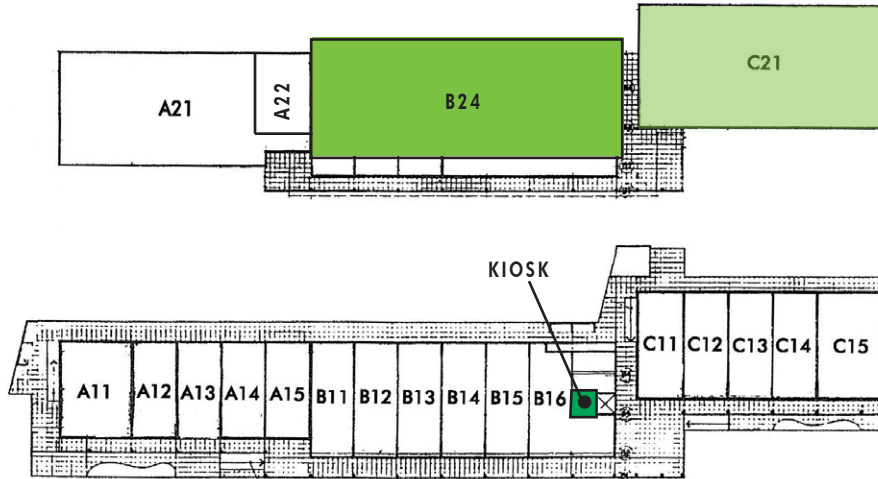

MAUI VISITORS (By Air)							
	2010	2011	2012	2013	2014	2015	2016*
Domestic U.S. Visitor	1,638,001	1,654,255	1,732,160	1,921,362	1,970,516	2,071,931	2,173,346
International Visitors	454,068	514,230	577,032	437,421	426,791	647,322	867,852
Total	2,092,069	2,075,800	2,309,192	2,358,783	2,397,307	2,719,253	3,041,198
Average Length of Stay in Hawaii							
	2010	2011	2012	2013	2014	2015	2016*
Domestic U.S. Visitor	10.04	10.11	10.09	10.08	10.02	10.5	10.97
International Visitors	7.74	7.81	7.78	7.54	7.44	7.86	8.28
Total Visitors (by air)	9.39	9.45	9.36	9.25	9.17	9.41	9.64
Per Person Per Day Spending Maui							
2016*	\$192						
2015	\$194						
2014	\$197						
2013	\$194						
2012	\$186						
2011	\$174						
2010	\$172						

Source: EBEDT
*Preliminary Data

© 2017 CBRE, Inc. This information has been obtained from sources believed reliable. We have not verified it and make no guarantee, warranty or representation about it. Any projections, opinions, assumptions or estimates used are for example only and do not represent the current or future performance of the property. You and your advisors should conduct a careful, independent investigation of the property to determine to your satisfaction the suitability of the property for your needs. Photos herein are the property of their respective owners and use of these images without the express written consent of the owner is prohibited. CBRE and the CBRE logo are service marks of CBRE, Inc. and/or its affiliated or related companies in the United States and other countries. All other marks displayed on this document are the property of their respective owners.
MS:RMP_RE74KamaoleSC_06.15.17