



For Lease

Kildeer Court

Retail and Office Space

3900 W Brown Deer Road Brown Deer, WI

Property Features

- Outparcel of 400,000 SF Marketplace of Brown Deer shopping center
- Great visibility from Brown Deer Road
- Office tenants pay only electrical and in-suite janitorial service in addition to rent

Building Size	29,449 SF
Available Retail Space	1,200 SF & 2,765 SF
Available Office Space	1,400 SF
Parking	141 Spaces
Signage	Building Façade
Traffic Counts	22,000 on Brown Deer Rd 21,200 on Green Bay Rd
Retail Lease Rate	\$14.00 PSF NNN
NNN Rate	\$5.10 PSF (CAM: \$3.28, Tax: \$1.66, Ins: \$0.16)
Office Lease Rate	\$13.00 PSF (Modified Gross)

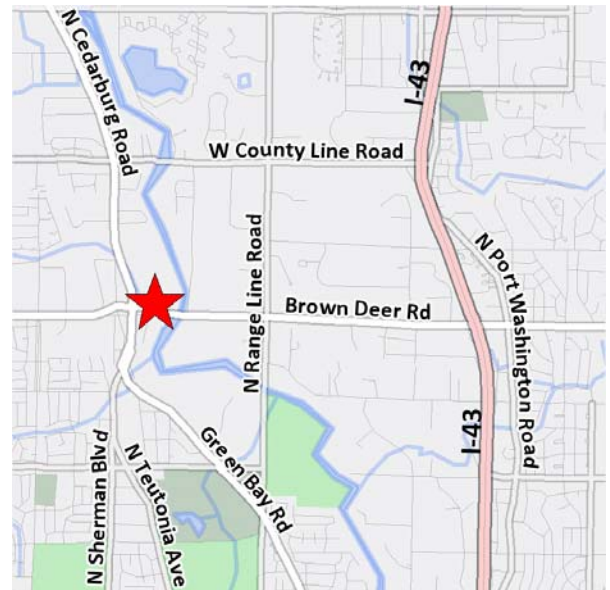

Demographics

	1 Mile	3 Miles	5 Miles
Population	4,454	50,119	145,062
Households	2,107	21,827	57,228
Median HH Inc.	\$49,287	\$56,863	\$49,906
Employees	3,341	27,909	75,135

For more information

Brian Vanevenhoven

414 908 9160

bjv@mlgcommercial.com

757 North Broadway Street, Suite 700
Milwaukee, WI 53202
414 347 9400
mlgcommercial.com
Offices also in Appleton and Madison, WI

Information shown herein was provided by the Seller/Lessor and/or other third parties and has not been verified by the broker unless otherwise indicated.



Kildeer Court

1st Floor Retail Space

Suite	Tenant	Size (SF)
180	UPS	1,440
170	Available	1,200
160	French Quarter	1,200
150	Weight Watchers	1,200
140	Dr. Rioga	1,550
130	RE/MAX	858
120	Inails & Spa	1,170
110	Appe"Thai"	3,450
100	Available	2,765

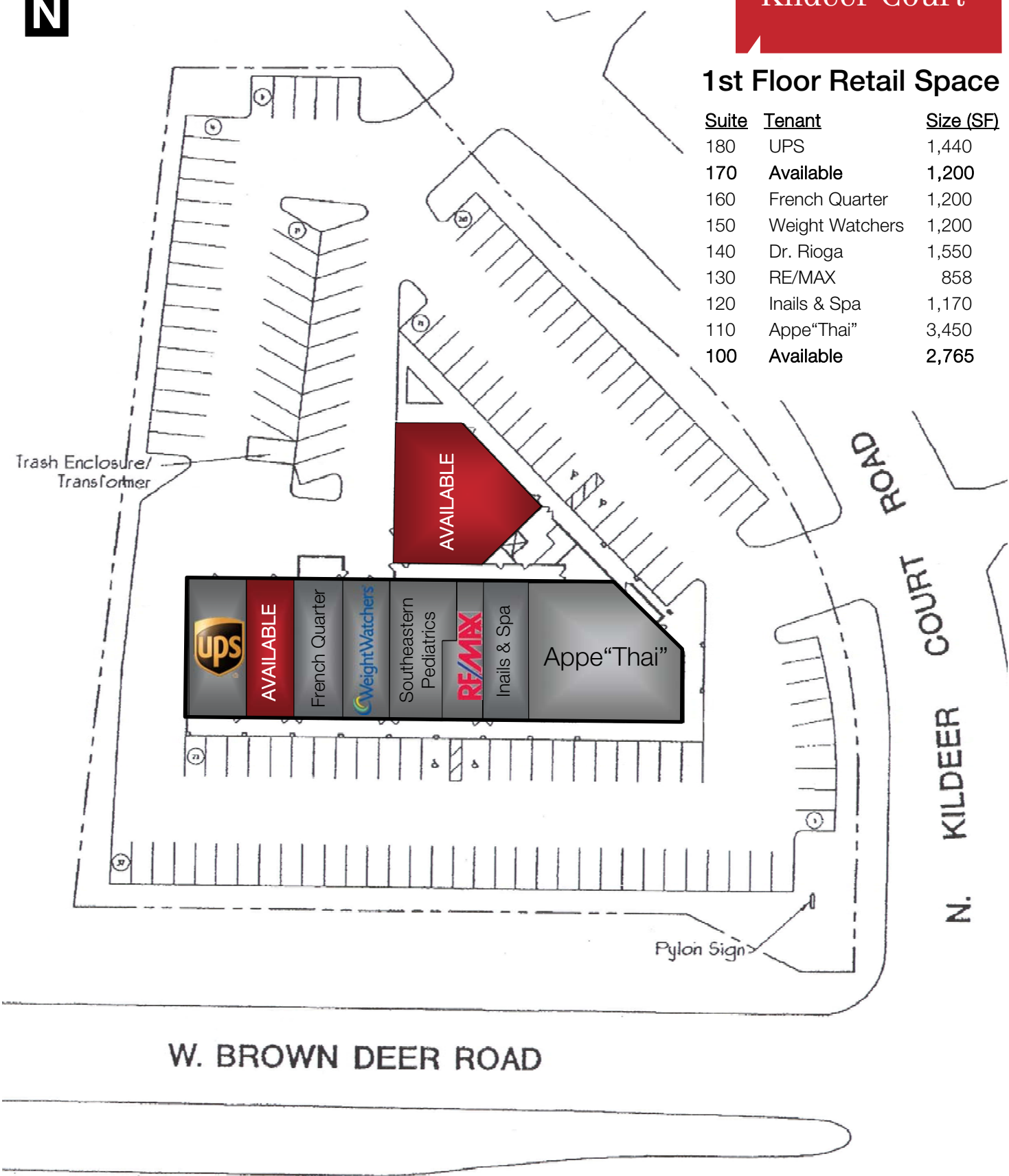

Kildeer Court



2nd Floor Office Space

Suite	Tenant	Size (SF)
200	Shorehaven	9,946
205	Available	1,400
210	Shorehaven	875
220	State Farm Ins.	2,365

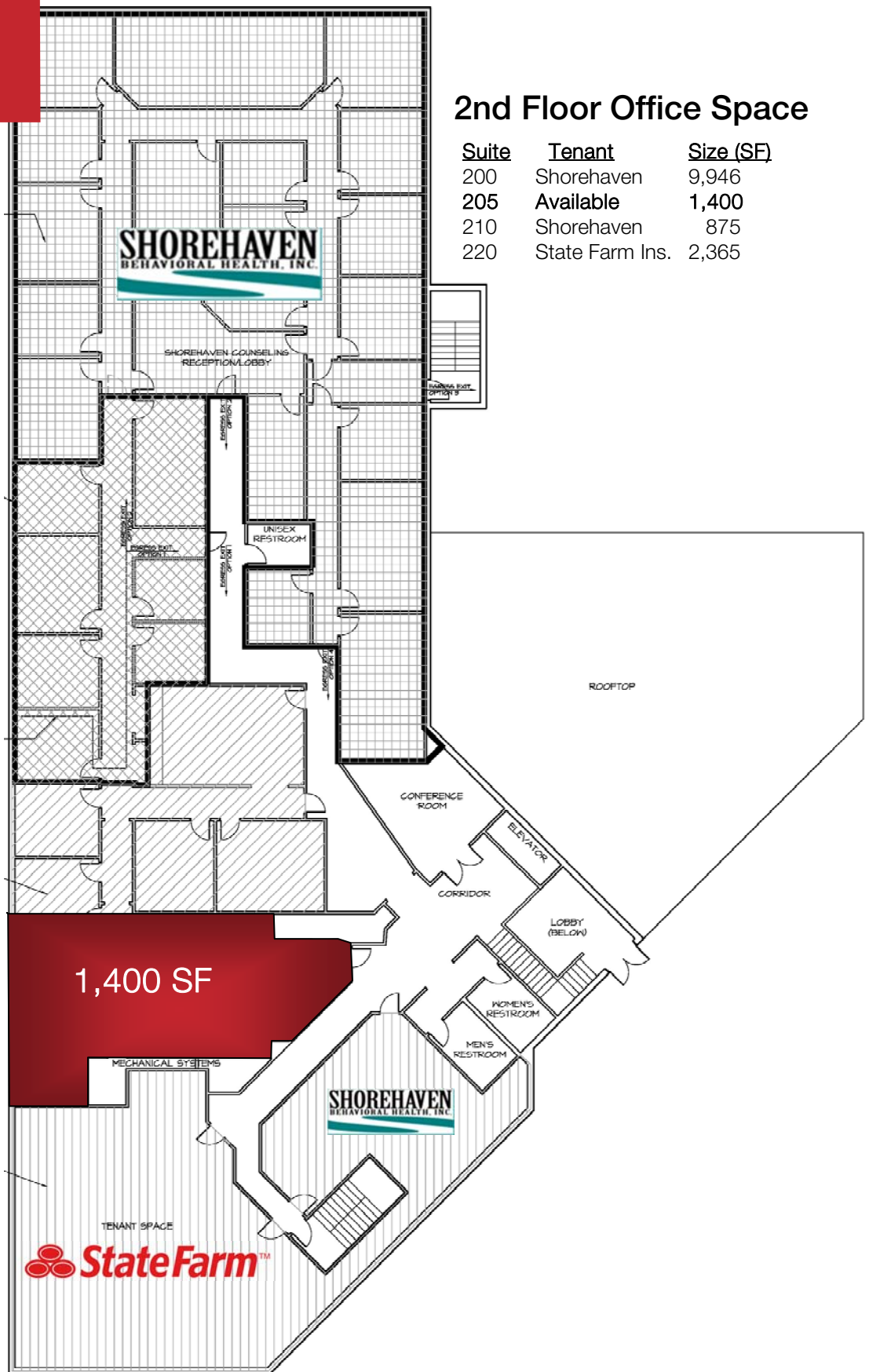

State of Wisconsin Broker Disclosure To Non-Residential Customers

Prior to negotiating on your behalf the Broker must provide you the following disclosure statement.

BROKER DISCLOSURE TO CUSTOMERS

You are the customer of the broker. The broker is either an agent of another party in the transaction or a subagent of another broker who is the agent of another party in the transaction. The broker, or a salesperson acting on behalf of the broker, may provide brokerage services to you. Whenever the broker is providing brokerage services to you, the broker owes you, the customer, the following duties:

- The duty to provide brokerage services to you fairly and honestly.
- The duty to exercise reasonable skill and care in providing brokerage services to you.
- The duty to provide you with accurate information about market conditions within a reasonable time if you request it, unless disclosure of the information is prohibited by law.
- The duty to disclose to you in writing certain material adverse facts about a property, unless disclosure of the information is prohibited by law (see "Definition of Material Adverse Facts" below).
- The duty to protect your confidentiality. Unless the law requires it, the broker will not disclose your confidential information or the confidential information of other parties (see "Confidentiality Notice To Customers" below).
- The duty to safeguard trust funds and other property the broker holds.
- The duty, when negotiating, to present contract proposals in an objective and unbiased manner and disclose the advantages and disadvantages of the proposals.

Please review this information carefully. A broker or salesperson can answer your questions about brokerage services, but if you need legal advice, tax advice, or a professional home inspection, contact an attorney, tax advisor, or home inspector.

This disclosure is required by section 452.135 of the Wisconsin statutes and is for information only. It is a plain-language summary of a broker's duties to a customer under section 452.133 (1) of the Wisconsin statutes.

CONFIDENTIALITY NOTICE TO CUSTOMERS

Broker will keep confidential any information given to broker in confidence, or any information obtained by broker that he or she knows a reasonable person would want to be kept confidential unless the information must be disclosed by law or you authorize the broker to disclose particular information. A broker shall continue to keep the information confidential after broker is no longer providing brokerage services to you.

The following information is required to be disclosed by law.

Wisconsin law requires all real estate licensees to give the following information about brokerage services to prospective customers.

1. Material adverse facts, as defined in section 452.01 (5g) of the Wisconsin statutes (see "definition of material adverse facts" below).
2. Any facts known by the broker that contradict any information included in a written inspection report on the property or real estate that is the subject of the transaction. To ensure that the broker is aware of what specific information you consider confidential, you may list that information below. At a later time, you may also provide the broker with other information that you consider to be confidential.

CONFIDENTIAL INFORMATION: _____

NON-CONFIDENTIAL INFORMATION (The following information may be disclosed by Broker): _____

(INSERT INFORMATION YOU AUTHORIZE THE BROKER TO DISCLOSE SUCH AS FINANCIAL QUALIFICATION INFORMATION)

CONSENT TO TELEPHONE SOLICITATION

I/We agree that the Broker and any affiliated settlement service providers (for example, a mortgage company or title company) may call our/my home or cell phone numbers regarding issues, goods and services related to the real estate transaction until I/we withdraw this consent in writing. List Home/Cell Numbers: _____

SEX OFFENDER REGISTRY

Notice: You may obtain information about the sex offender registry and persons registered with the registry by contacting the Wisconsin Department of Corrections on the Internet at <http://offender.doc.state.wi.us/public/> or by phone at 608-240-5830.

DEFINITION OF MATERIAL ADVERSE FACTS

A "material adverse fact" is defined in Wis. Stat. 452.01 (5g) as an adverse fact that a party indicates is of such significance, or that is generally recognized by a competent licensee as being of such significance to a reasonable party that it affects or would affect the party's decision to enter into a contract or agreement concerning a transaction or affects or would affect the party's decision about the terms of such a contract or agreement. An "adverse fact" is defined in Wis. Stat. 452.01 (1e) as a condition or occurrence that a competent licensee generally recognizes will significantly and adversely affect the value of the property, significantly reduce the structural integrity of improvements to real estate, or present a significant health risk to occupants of the property, or information that indicates that a party to a transaction is not able to or does not intend to meet his or her obligations under a contract or agreement made concerning the transaction.

No representation is made as to the legal validity of any provision or the adequacy of any provision on any specific transaction