



# Forbes Center

**Space for Lease**  
**4501 Forbes Blvd**  
Lanham, MD 20706

**Up to  
36,100 SF  
Contiguous**



**NEW Flex/ Industrial | Approximately 20,000 SF**

**Kenneth Fellows**  
kfellows@klnb.com  
301.222.0210

**Robert Pugh**  
rpugh@klnb.com  
301.222.0211

**Keiry Martinez**  
kmartinez@klnb.com  
703.334.5629

**klnb**

# Building Stats

**Suite A** 7,896 SF

**Suite B** 4,956 SF

**Suite C** 7,824 SF

**Suite A & B** 12,052 SF

**Suite B & C** 12,780 SF

---

**Total:** 19,876 SF

- 8' Wide Service/ Loading Corridor
- 3 Phase 800 Amps
- 21' Bottom of Joist
- 23' 5-5 Slab to Slab
- Approx 100' Deep x 200' Wide
- 25' x 25' Column Spacing
- Extensive Glassline 2 Stories
- Building Signage Opportunity

**FC**

**4501**  
Forbes Blvd  
Lanham, MD 20706

Kenneth Fellows  
kfellows@klnb.com  
301-222-0210

Robert Pugh  
rpugh@klnb.com  
301-222-0211

Keiry Martinez  
kmartinez@klnb.com  
703-334-5629

**klnb**

# 4501 Forbes Blvd

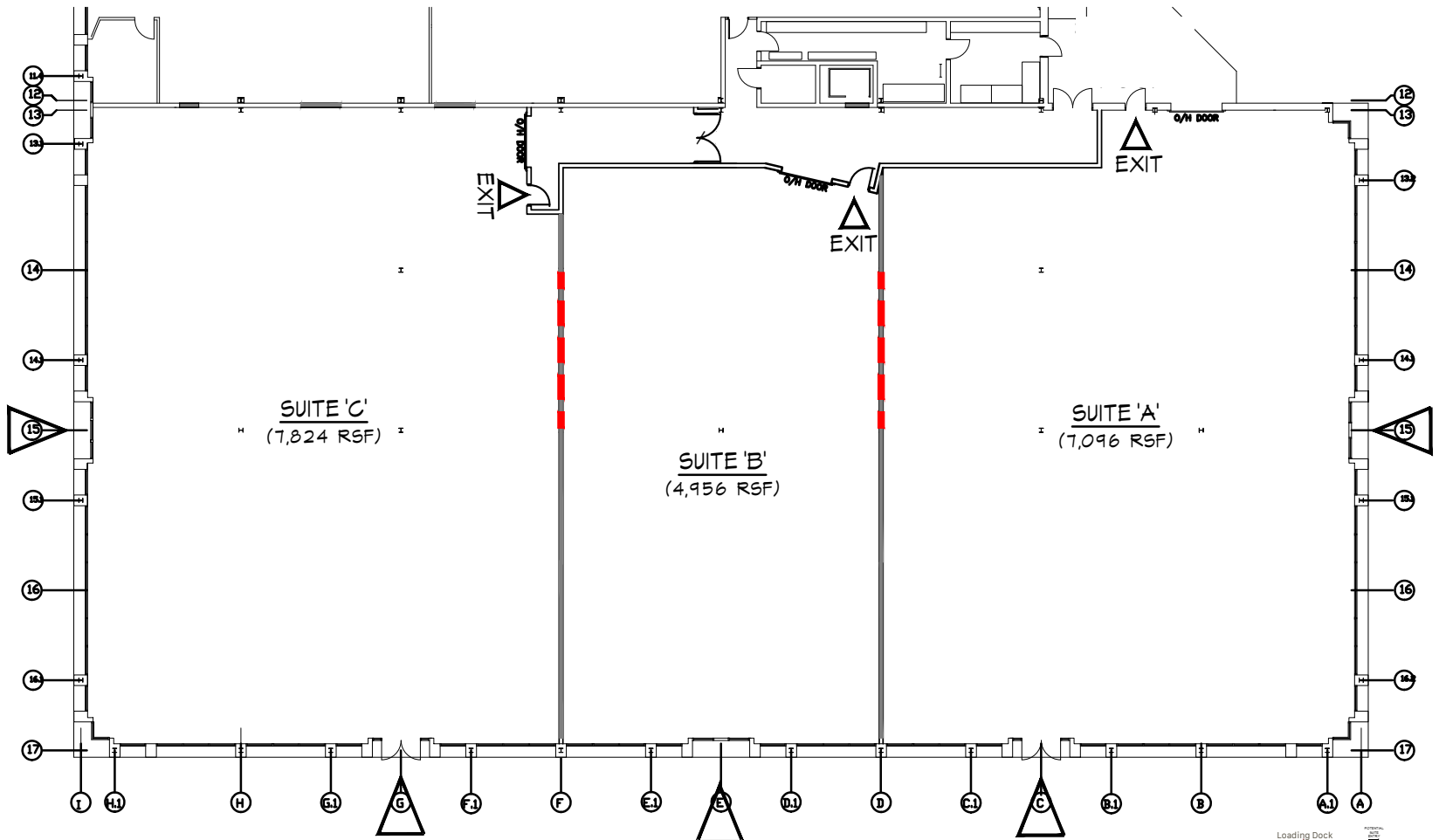

**19,876 SF**

\*Hypothetical Demising Plan

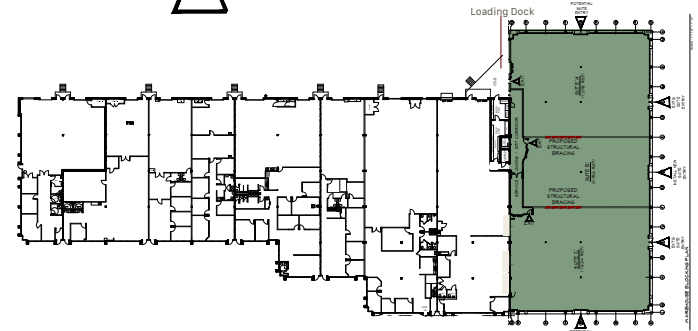

**4501**  
Forbes Blvd  
Lanham, MD 20706

Kenneth Fellows  
kfellows@klnb.com  
301-222-0210

Robert Pugh  
rpugh@klnb.com  
301-222-0211

Keiry Martinez  
kmartinez@klnb.com  
703-334-5629





# Building Amenities

(Located at 4425 Forbes Blvd)



Fitness facility



Conference center



Lounge



Outdoor seating area



On-site building engineers and property management

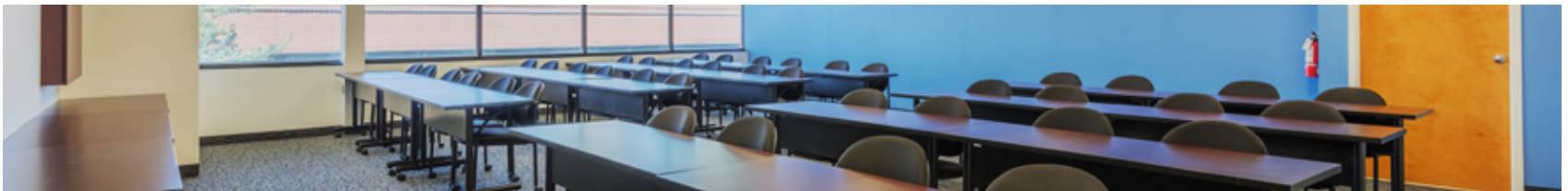

**4501**  
Forbes Blvd  
Lanham, MD 20706

**Kenneth Fellows**  
kfellows@klnb.com  
301-222-0210

**Robert Pugh**  
rpugh@klnb.com  
301-222-0211

**Keiry Martinez**  
kmartinez@klnb.com  
703-334-5629



# Accessibility

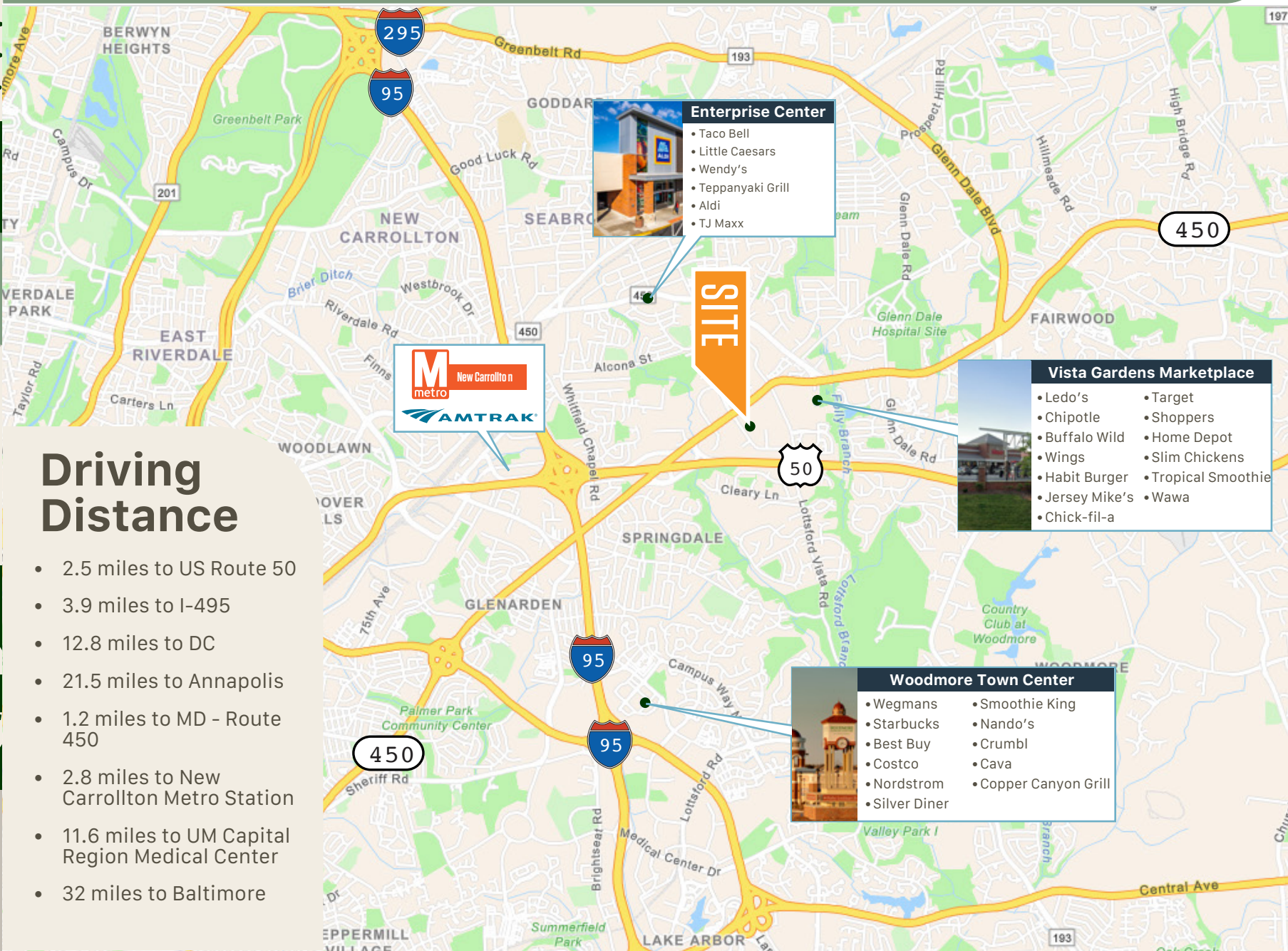

## Driving Distance

- 2.5 miles to US Route 50
- 3.9 miles to I-495
- 12.8 miles to DC
- 21.5 miles to Annapolis
- 1.2 miles to MD - Route 450
- 2.8 miles to New Carrollton Metro Station
- 11.6 miles to UM Capital Region Medical Center
- 32 miles to Baltimore

**4501**

Forbes Blvd  
Lanham, MD 20706

Kenneth Fellows  
kfellows@klnb.com  
301-222-0210

Robert Pugh  
rpugh@klnb.com  
301-222-0211

Keiry Martinez  
kmartinez@klnb.com  
703-334-5629

klnb



# Forbes Center

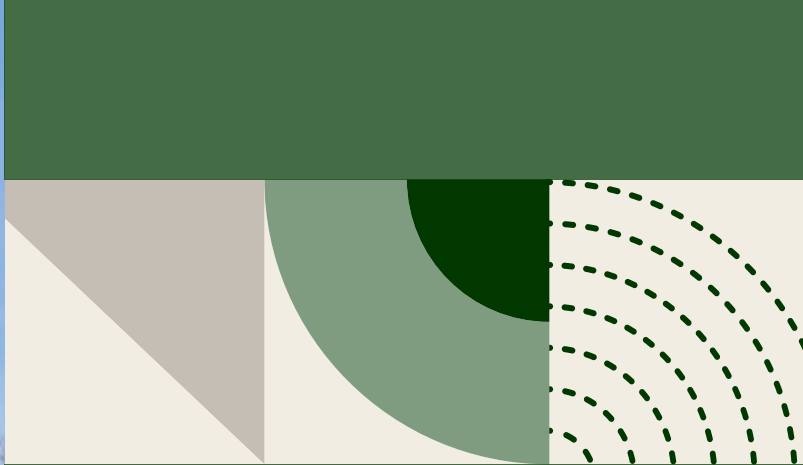

**Kenneth Fellows**  
kfellows@klnb.com  
301.222.0210

**Robert Pugh**  
rpugh@klnb.com  
301.222.0211

**Keiry Martinez**  
kmartinez@klnb.com  
703.334.5629

## klnb

12435 Park Potomac Ave  
Suite 250  
Rockville, MD 20854

301-222-0200  
klnb.com

f in @ /klnbcre

While we have no reason to doubt the accuracy of any of the information supplied, we cannot, and do not, guarantee its accuracy. All information should be independently verified prior to a purchase or lease of the property. We are not responsible for errors, omissions, misuse, or misinterpretation of information contained herein and make no warranty of any kind, express or implied, with respect to the property or any other matters.