



ROGER  
**HANNAH**  
& CO

To Let



Lock Up Units  
From 530 sq ft

**Supreme Business  
Park**  
Printworks Lane  
Levenshulme  
M19 3JP

## Self-Contained Ground Floor Lock Up Units

- 24-HOUR REMOTE CONTROLLED ACCESS
- FULL HEIGHT ROLLER SHUTTER DOOR
- SUITABLE FOR A VARIETY OF USES

**0161 817 3399**  
[www.roger-hannah.co.uk](http://www.roger-hannah.co.uk)



## LOCATION

Located just off Barlow Road, based in Supreme Business Park, Levenshulme close to the main A6 road between Stockport and Manchester.

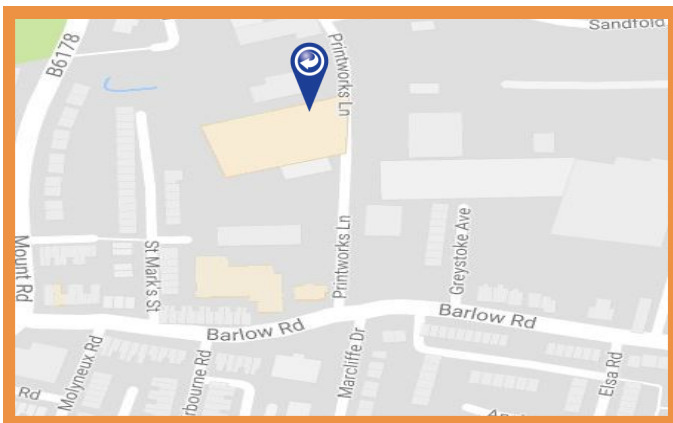

## ACCOMMODATION

26 Self-contained lock up units from 530 sq ft upwards.

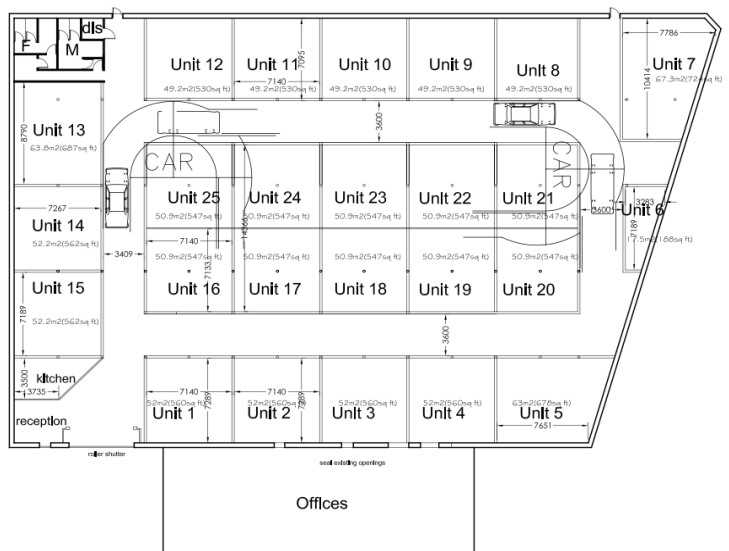

## DESCRIPTION

### Key Features of the units include:

- 24-hour Remote Controlled Access.
- Parking.
- 24-hour monitored CCTV.
- Serviced Facilities Available.
- Communal on-site Kitchen & WC facilities.
- Disabled WC facilities.

### Suitable for most trades including:

- Builders.
- Plumbers.
- Joiners.
- Electricians.
- Painter & Decorator.
- Market Traders & Car Traders.

Please note the landlord will not accept car repair or tyre operators

## LEASE

Available same day subject to a minimum six month term at £500 pcm all inclusive.

Please note all units are sub-metered so each tenant is responsible for their own electricity supply.

## VIEWING & FURTHER INFO

Please contact Roger Hannah & Co the Sole Agents:

**Tel:** 0161 817 3399

**Email:** danrogers@roger-hannah.co.uk

**Date Of Preparation:** 07/11/17