

PROLOGIS PARK

HIMS HILL

J9 M42 · BIRMINGHAM · UK

DC3

122,460 SQ FT

MANUFACTURING / DISTRIBUTION
BUILD TO SUIT OPPORTUNITY



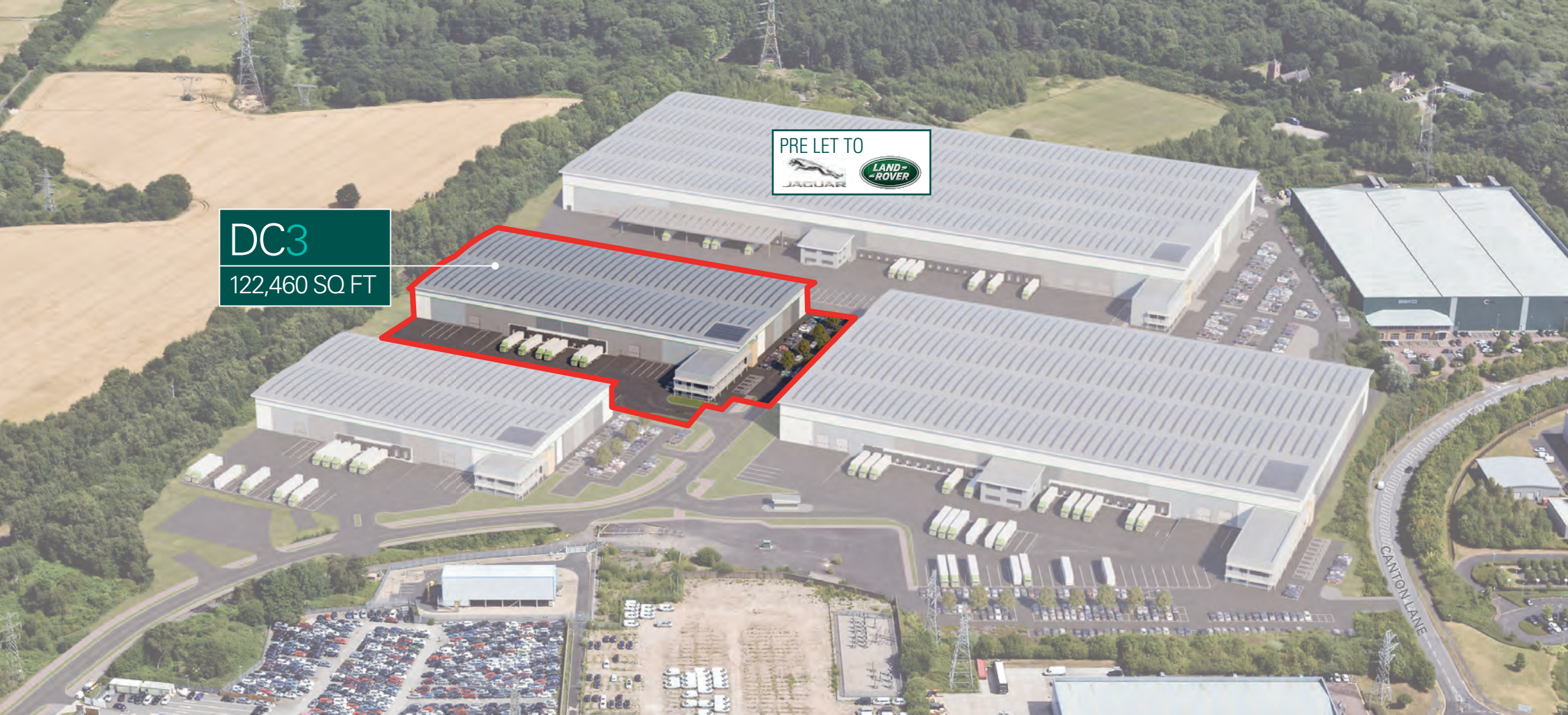

DC3
122,460 SQ FT

PRE LET TO
JAGUAR LAND ROVER

PROLOGIS PARK HAMS HALL A NEW MANUFACTURING & DISTRIBUTION HUB CENTRALLY POSITIONED IN THE WEST MIDLANDS TO SERVE THE UK AND INTERNATIONAL MARKETS

- Prologis Park Hams Hall is the final significant development opportunity within Hams Hall
- Planning consent for B2 and B8 uses
- Located to the north-east of Birmingham at the centre of the UK's national motorway network
- On-site Intermodal Rail Freight Terminal linking to three sea ports and the Channel Tunnel
- Two international airports within short drive times
- Wide labour pool drawing from Birmingham, Tamworth, Solihull and Coventry
- Hams Hall is home to several world class companies
- Prologis best in class specification and build quality

YOU'RE IN GOOD COMPANY AT PROLOGIS PARK HAMS HALL



ENVIABLE SPECIFICATION

WAREHOUSE

- FM2 category floor
- 50 kN sq m floor loading
- 12.5m clear height
- 11 dock level doors
- 2 level access doors

OFFICE

- Two-storey offices
- Mechanically ventilated system
- Suspended ceilings
- Raised access floors

EXTERNAL

- 50m service yard
- Secure fenced site
- Security lighting – office car park / service yard
- Covered cycle shelter
- 86 car parking spaces
- 39 HGV parking spaces

SUSTAINABILITY

- Target EPC rating of 'A'
- Min. BREEAM 'Very Good' (2014)
- Rooftop solar PV to deliver 10% of each buildings regulated energy use

TO VIEW ALTERNATIVE MASTERPLAN OPTIONS VISIT: PROLOGIS.CO.UK/HAMSHALL

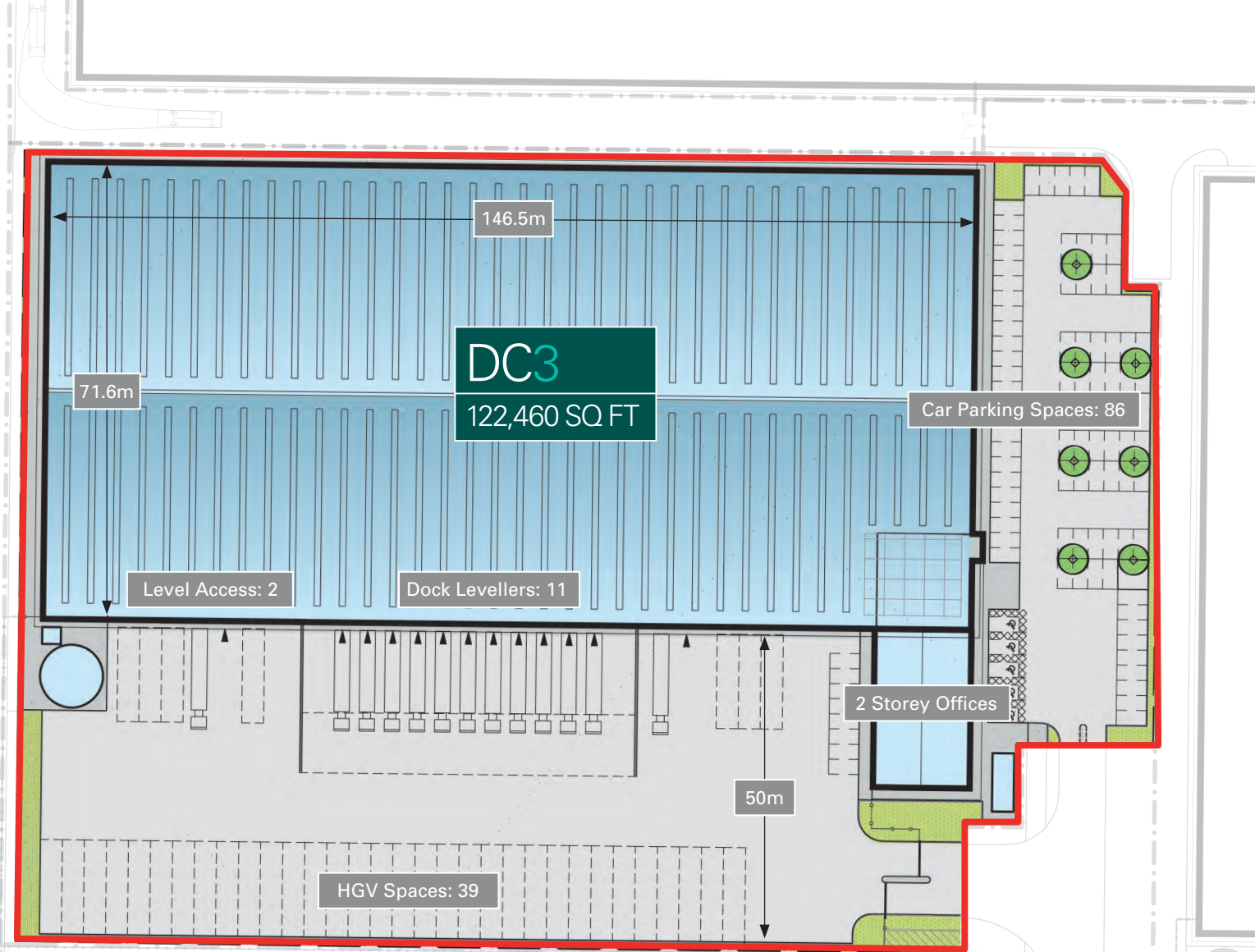

DC3	SQ M	SQ FT
Unit	10,267	110,515
Offices	1,110	11,945
TOTAL	11,377	122,460

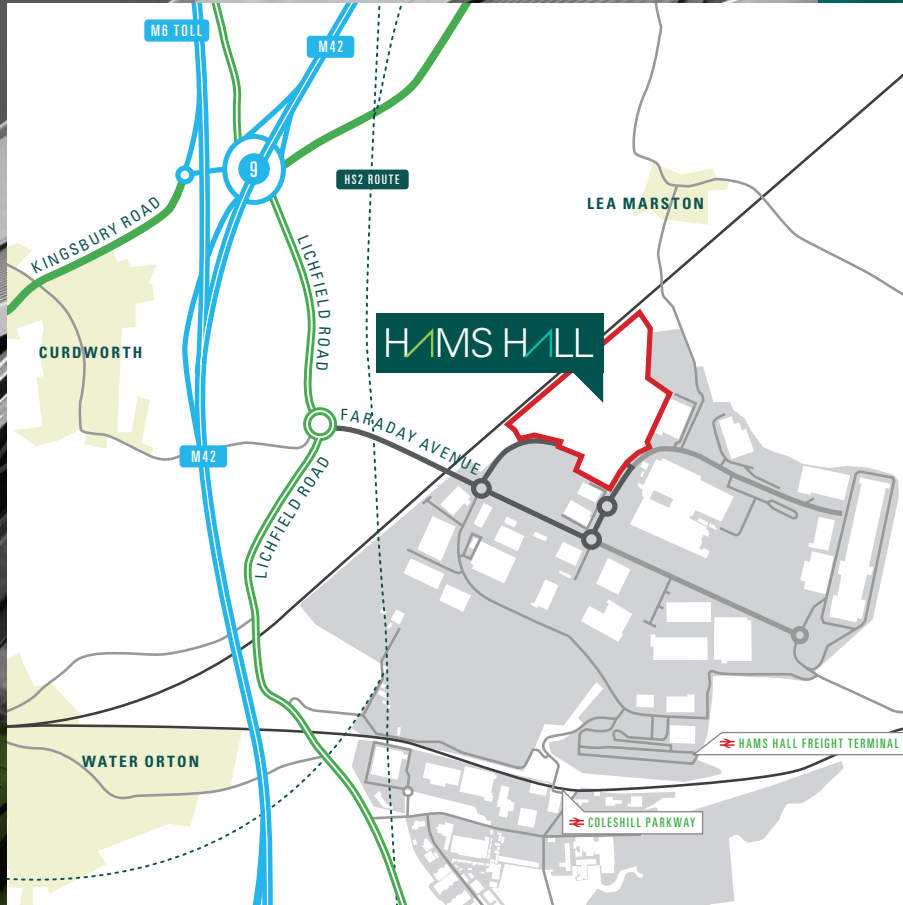

AT THE HEART
OF IT ALL —
HAMS HALL

SAT NAV: B46 1AL

PROLOGIS.CO.UK/HAMSHALL

Simon Lloyd



simon.f.lloyd@cushwake.com

Carl Durrant / Chris Clark



Carl.Durrant@eu.jll.com
Chris.Clark@eu.jll.com

Charles Spicer



CASpicer@savills.com

Conditions under which particulars are issued: Cushman & Wakefield, JLL & Savills for themselves and for the vendors or lessors of this property whose agents they are give notice that: (i) the particulars are set out as a general outline only for the guidance of intended purchasers or lessees, and do not constitute, nor constitute part of, an offer or contract; (ii) all descriptions, dimensions, reference to condition and necessary permissions for use and occupation, and other details are given without responsibility and any intending purchasers or tenants should not rely on them as statements or representations of fact but must satisfy themselves by inspection or otherwise as to the correctness of each of them; (iii) no person in the employment of Cushman & Wakefield, JLL & Savills has any authority to make or give any representation or warranty whatever in relation to this property. 10754 02.19 tasseldesign.co.uk