



73,240 SF + 26,000 SF Available

KMart Center- Flint

For Sub Lease

KMart

3083 Miller Rd, Flint Township, MI

- 99,000+ square foot multi-tenant retail community center
- 73,240+ square foot former Kmart unit adjacent to 26,000 SF former Save-A-Lot
- Strategically located in close proximity to I-75 and US 23, with good visibility from Miller Road
- Miller Road is a well-recognized regional retail corridor in the Flint/Genesee County corridor
- Opportunity for cost-effective retail or warehouse space
- Zoned C-2 General Business
- Kmart ceilings 17' clear, Save-A-Lot ceilings 18' clear

For more information, contact:

Ron Goldstone

Senior Vice President
248 351 4371
goldstone@farbman.com

Carrie Weiss

Sales & Leasing Associate
248 351 6328
weiss@farbman.com

DEMOGRAPHICS

STATS	POPULATION	AVG. HH INCOME
1 MILE	5,265	\$27,780
3 MILE	56,344	\$32,889
5 MILE	138,705	\$33,070

Figures shown represent estimates

DAILY TRAFFIC COUNTS

ROADS	DAILY TRAFFIC
I-75	88,606 DAILY
I-69	77,601 DAILY
Miller Rd	34,992 DAILY

Figures shown represent estimates



Commercial Real Estate Services, Worldwide.



WWW.FARBMAN.COM



MIDWEST EXPERTISE, GLOBAL REACH.

28400 Northwestern Hwy
Fourth Floor
Southfield, MI 48034
248 353 0500 tel
naifarbman.com



SUBJECT PROPERTY
Kmart Flint
3083 Miller Road
Flint Township, MI

For more information, contact:

Ron Goldstone

Senior Vice President
248 351 4371
goldstone@farbman.com

Carrie Weiss

Sales & Leasing Associate
248 351 6328
weiss@farbman.com

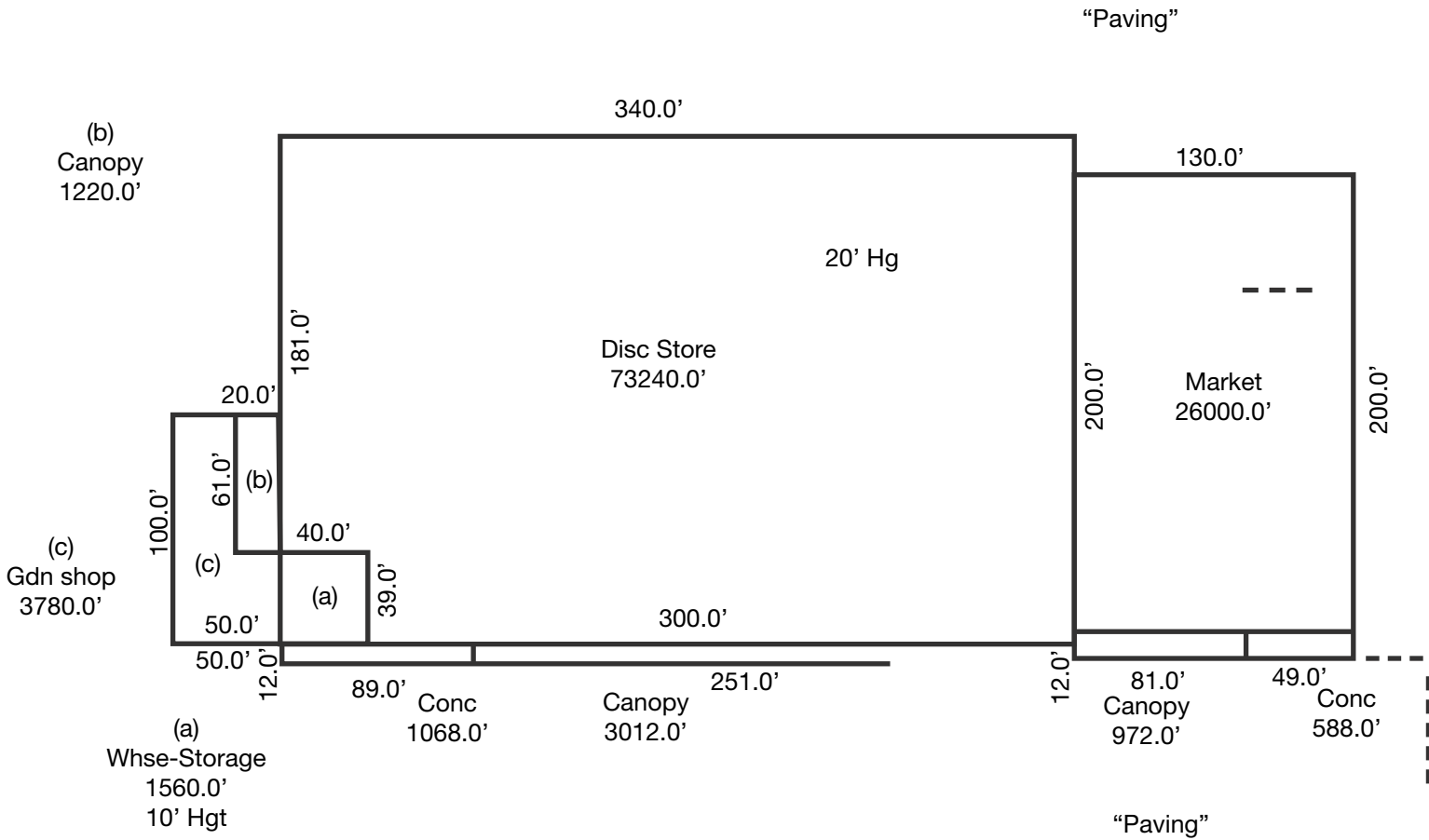

For more information, contact:

Ron Goldstone

Senior Vice President
248 351 4371
goldstone@farbman.com

Carrie Weiss

Sales & Leasing Associate
248 351 6328
weiss@farbman.com