



FERGUSON
PROPERTIES

EPOCH
DEVELOPMENTS

908 BALTIMORE *(La Rue Building)* Downtown Kansas City, MO

UP TO 25,000 SF OF OFFICE SPACE AVAILABLE FOR LEASE

Up to 10,000sf of Ground Floor Retail Space Available

DEMOGRAPHICS	1 MILE	2 MILES	3 MILES
2018 Population	11,066	28,453	80,329
Total Employees	87,599	129,048	181,475
Total Businesses	3,045	5,053	8,577

- Newly Renovated Iconic Historic Building available for lease in highly-sought after downtown Kansas City location
- Right next door to Milwaukee Deli and Banksia Coffee and Bakery Shop
- High-character, historic building located in the heart of the historic Library District
- Walking distance to new streetcar stop, numerous hotels, Power & Light Entertainment District, Crossroads District, River Market, and Sprint Center
- Office, retail, and/or flex space available
- Parking garage spaces available, with additional garage parking available across the street

**CONTACT
US TODAY**

JORDAN ZENGER

Senior Associate

913.558.5183

jzenger@fergprop.com

COLLEEN BRADBURY

Sales Associate

913.277.9445

cbradbury@fergprop.com





FERGUSON
PROPERTIES

EPOCH
DEVELOPMENTS

908 BALTIMORE BUILDING

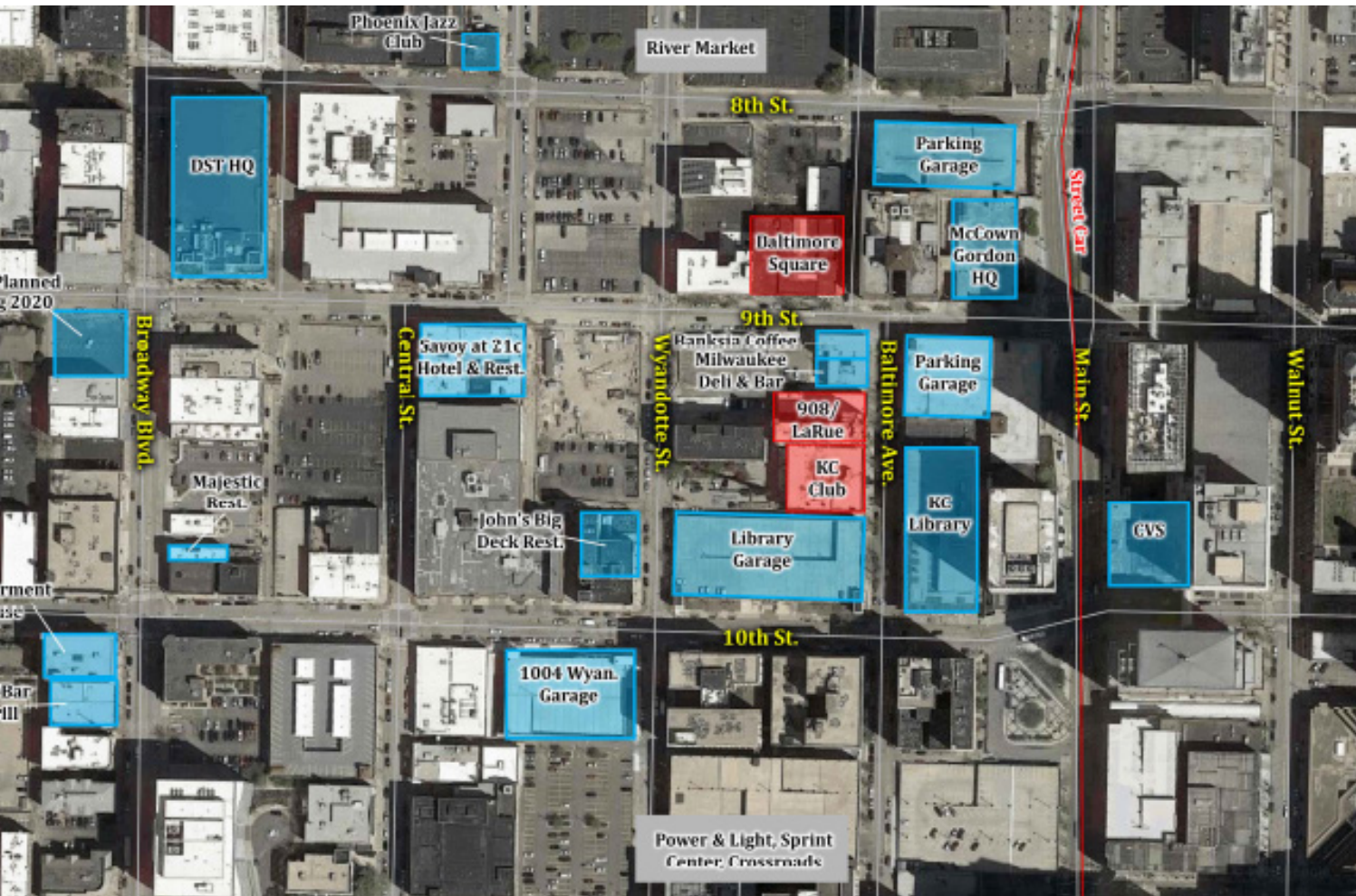

CONTACT US TODAY

JORDAN ZENGER, Senior Associate
913.558.5183 | jzenger@fergprop.com

COLLEEN BRADBURY, Sales Associate
913.277.9445 | cbradbury@fergprop.com



FERGUSON
PROPERTIES

EPOCH
DEVELOPMENTS

908 BALTIMORE BUILDING



CONTACT US TODAY

JORDAN ZENGER, Senior Associate
913.558.5183 | jzenger@fergprop.com

COLLEEN BRADBURY, Sales Associate
913.277.9445 | cbradbury@fergprop.com



FERGUSON
PROPERTIES

EPOCH
DEVELOPMENTS

908 BALTIMORE BUILDING

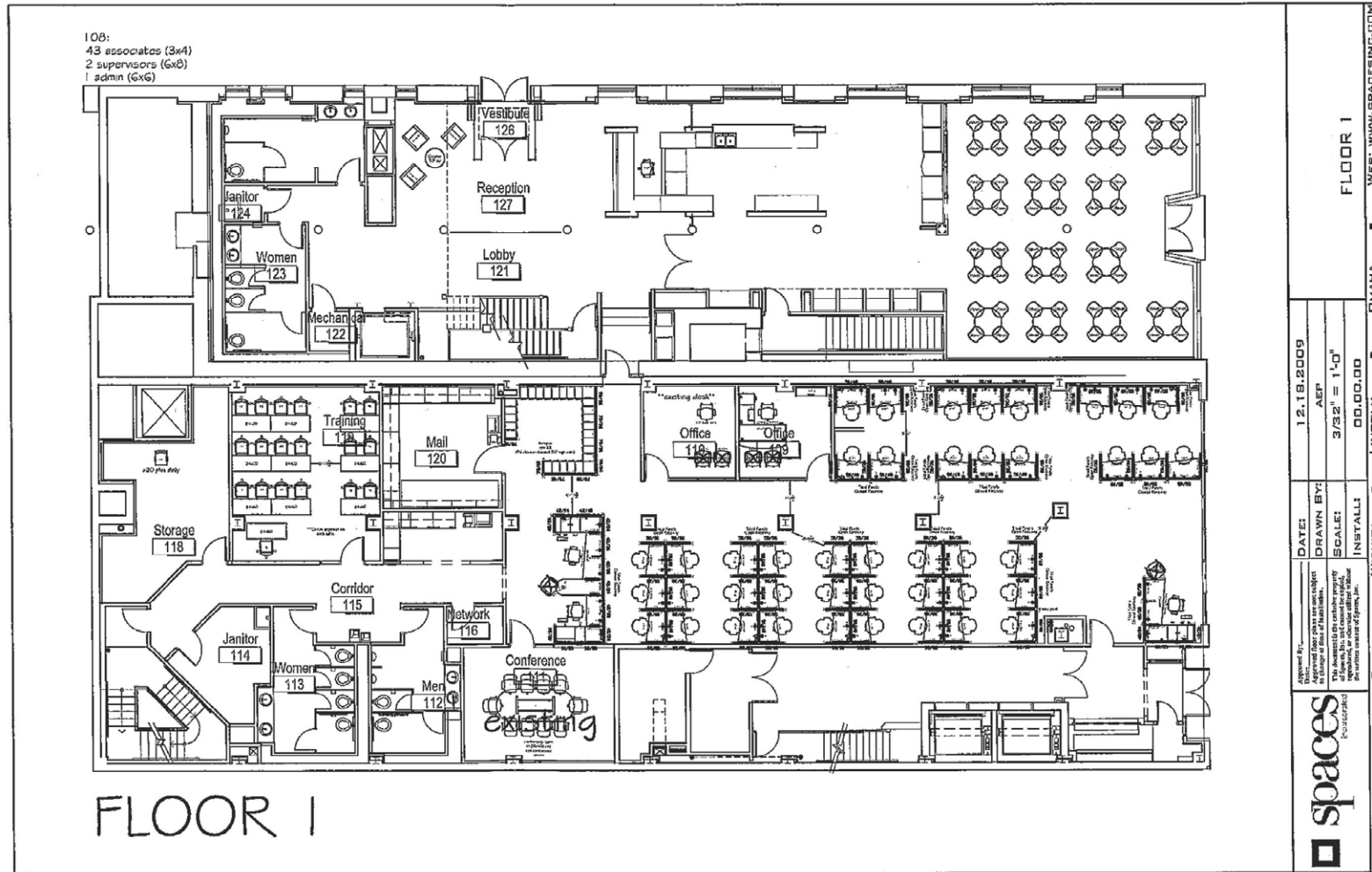

CONTACT US TODAY

JORDAN ZENGER, Senior Associate
913.558.5183 | jzenger@fergprop.com

COLLEEN BRADBURY, Sales Associate
913.277.9445 | cbradbury@fergprop.com



FERGUSON
PROPERTIES

EPOCH
DEVELOPMENTS

908 BALTIMORE BUILDING

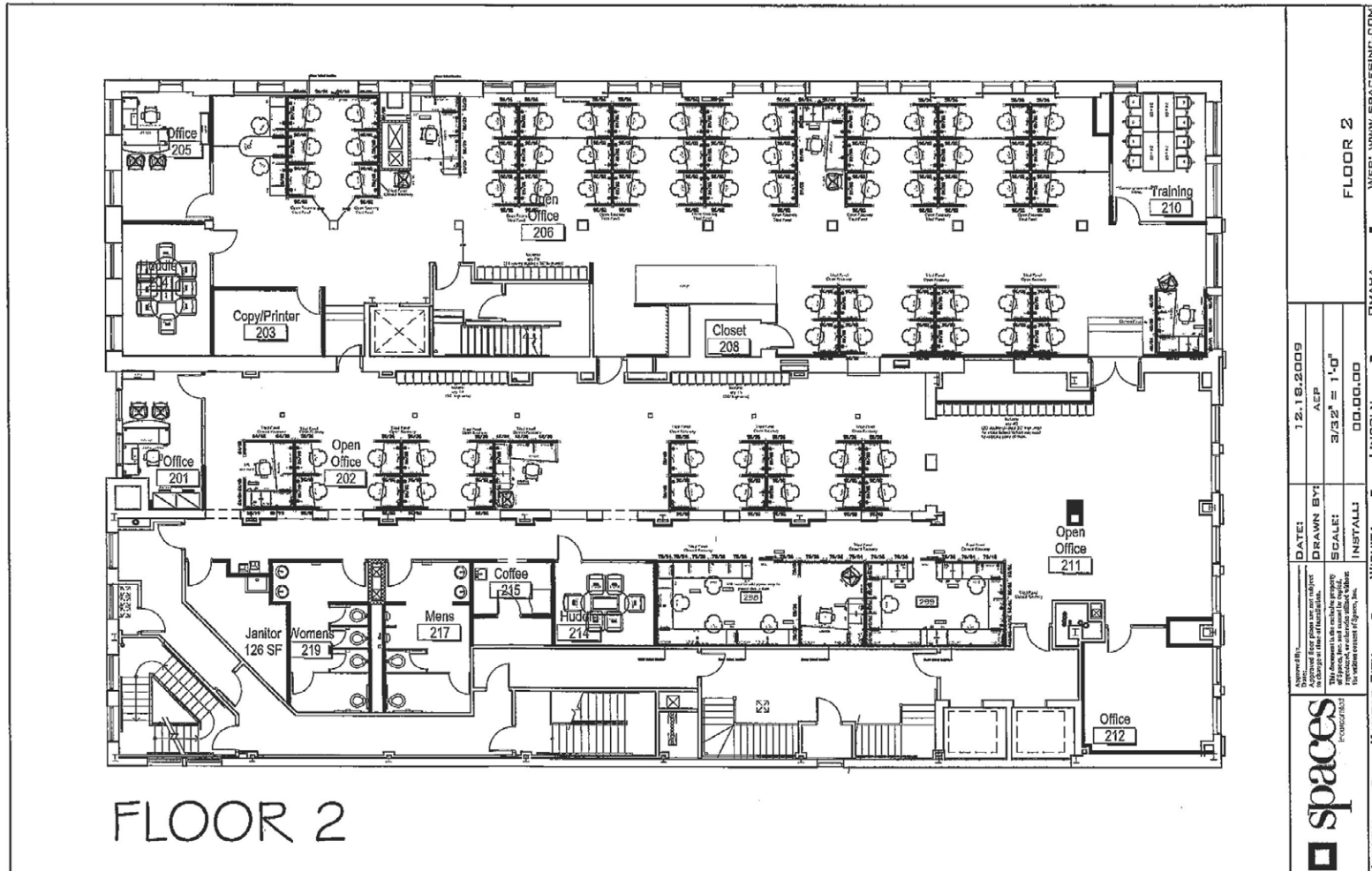

DATE:	12.16.2009	FLOOR 2
DRAWN BY:	ACP	WWW.SPACESINC.COM
SCALE:	3/32" = 1'-0"	
INSTALL:	00.00.00	
LENEKA ■ KANSAS CITY ■ WICHITA ■ LINCOLN ■ OMAHA		

CONTACT US TODAY

JORDAN ZENGER, Senior Associate
913.558.5183 | jzenger@fergprop.com

COLLEEN BRADBURY, Sales Associate
913.277.9445 | cbradbury@fergprop.com



FERGUSON
PROPERTIES

EPOCH
DEVELOPMENTS

908 BALTIMORE BUILDING

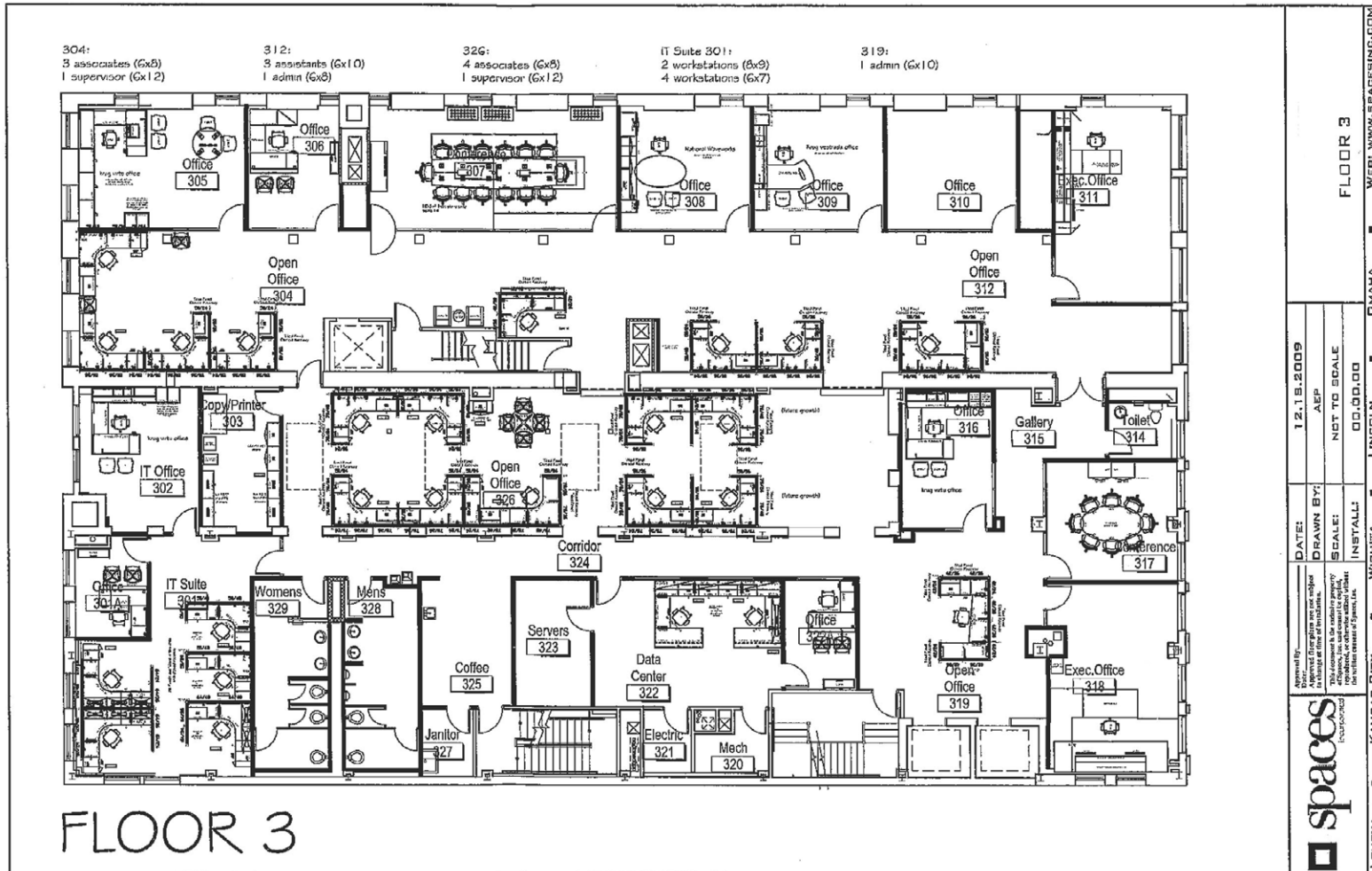

CONTACT US TODAY

JORDAN ZENGER, Senior Associate
913.558.5183 | jzenger@fergprop.com

COLLEEN BRADBURY, Sales Associate
913.277.9445 | cbradbury@fergprop.com