

HERMOSA PAVILLION

1601 PACIFIC COAST HIGHWAY | HERMOSA BEACH

OFFICE / RETAIL FOR LEASE



Hermosa Pavilion is a ±116,179 SF mixed-use office/retail building prominently located in the heart of beautiful Hermosa Beach. The location along Pacific Coast Highway offers unparalleled visibility to affluent residents of the beach cities.

HIGHLIGHTS:

- Project is anchored by 24-Hour Fitness Super Sport gym
- Attached 6-story parking structure provides 4.7/1,000 free parking
- Identity opportunity for building signage
- Ingress/egress from signalized corner on 16th Street
- Walking distance to Pier Avenue and Downtown Hermosa Beach
- Excellent access to retail, dining, banking and social amenities



ERIC LASTITION
Executive Managing Director

310.491.2047
eric.lastition@ngkf.com
CA RE Lic. #01119647

GEOFF LUDWIG
Executive Managing Director

310.491.2077
geoff.ludwig@ngkf.com
CA RE Lic. #01232244

SHARENE SEHR
Associate

310.491.2057
sharene.sehr@ngkf.com
CA RE Lic. #01716955

FLOOR PLAN | FIRST FLOOR

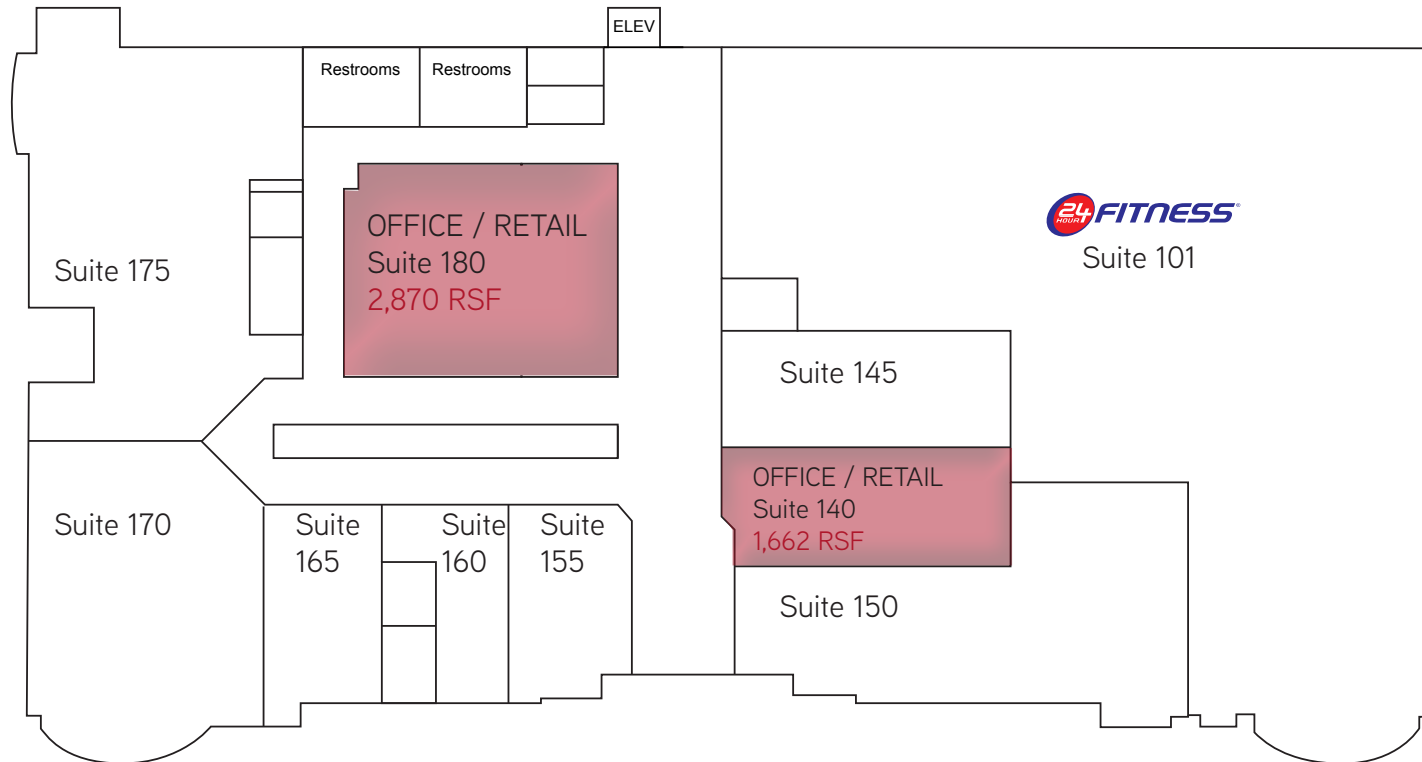

OFFICE OR RETAIL USE

- SUITE 140 :: 1,662 SF - \$2.65 MG
- SUITE 180 :: 2,870 SF - \$2.65 MG

FLOOR PLAN | SECOND FLOOR

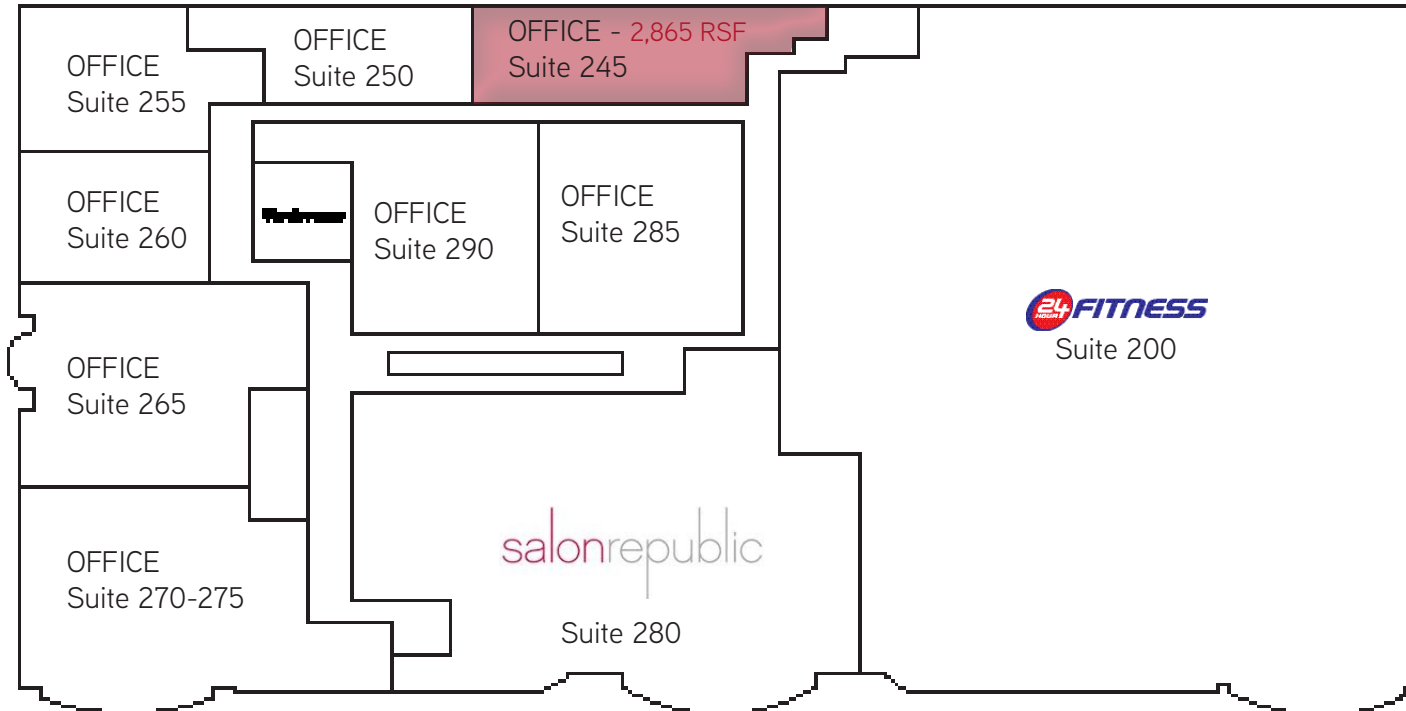

OFFICE

- SUITE 245 ::2,865 SF - \$3.50 MG
Available 9/1/2020
>Ocean views