

OFFICE SPACE FOR LEASE

# HISTORIC KOLOA PLANTATION BUILDING

3417 EAST POIPU RD, KOLOA, KAUAI 96756

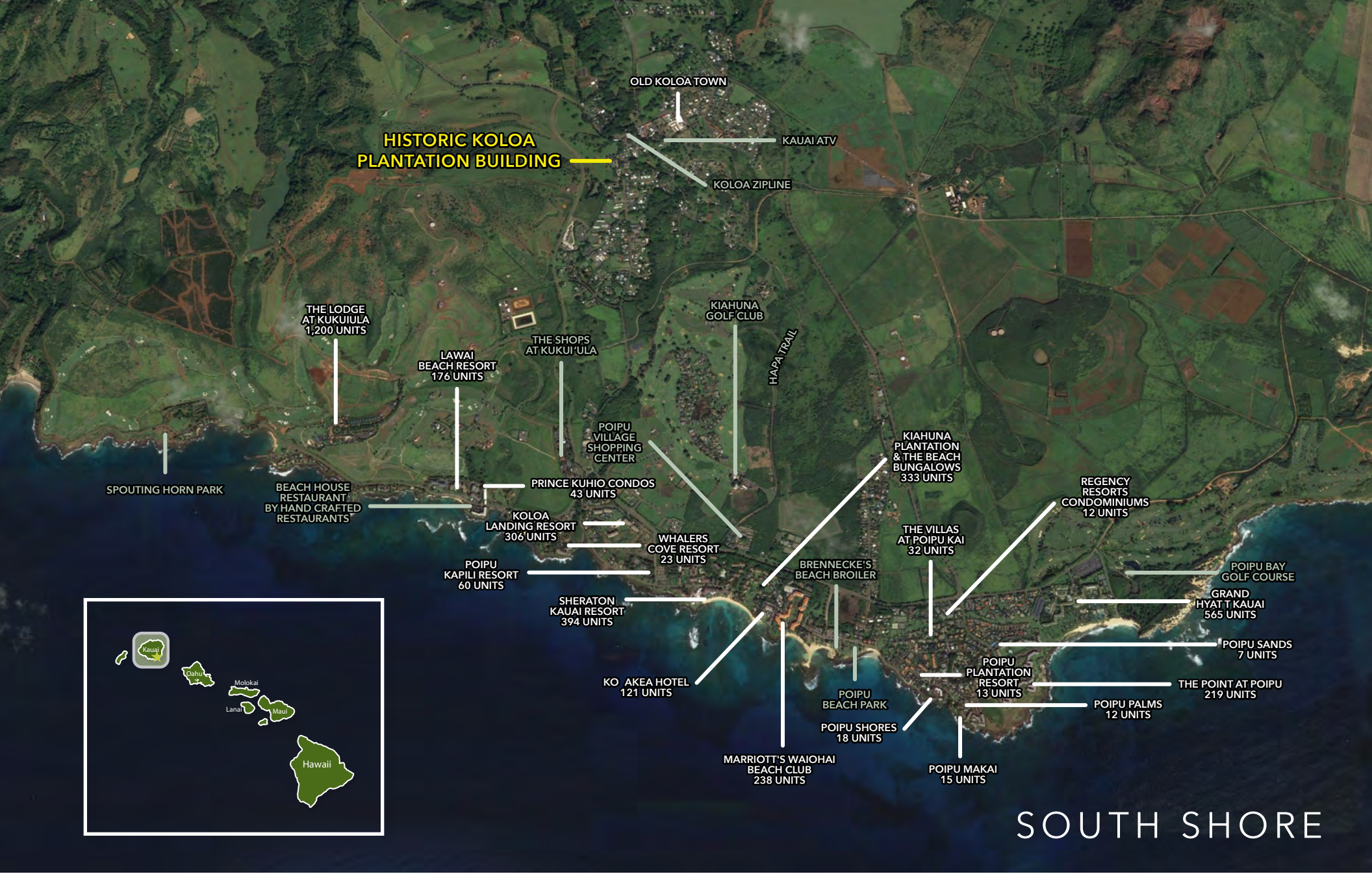



**HISTORIC KOLOA PLANTATION BUILDING**

OLD KOLOA TOWN

KAUAI ATV

KOLOA ZIPLINE

THE LODGE AT KUKUI'ULA  
1,200 UNITS

LAWAI BEACH RESORT  
176 UNITS

THE SHOPS AT KUKUI'ULA

KIAHUNA GOLF CLUB

HAPA TRAIL

SPOUTING HORN PARK

BEACH HOUSE RESTAURANT  
BY HAND CRAFTED RESTAURANTS

PRINCE KUHIO CONDOS  
43 UNITS

POIPU VILLAGE SHOPPING CENTER

KIAHUNA PLANTATION & THE BEACH BUNGALOWS  
333 UNITS

REGENCY RESORTS CONDOMINIUMS  
12 UNITS

KOLOA LANDING RESORT  
306 UNITS

WHALERS COVE RESORT  
23 UNITS

THE VILLAS AT POIPU KAI  
32 UNITS

POIPU BAY GOLF COURSE

POIPU KAPILI RESORT  
60 UNITS

BRENNECKE'S BEACH BROILER

GRAND HYATT KAUAI  
565 UNITS

SHERATON KAUAI RESORT  
394 UNITS

POIPU SANDS  
7 UNITS

KO AKEA HOTEL  
121 UNITS

POIPU BEACH PARK

POIPU PLANTATION RESORT  
13 UNITS

THE POINT AT POIPU  
219 UNITS

POIPU SHORES  
18 UNITS

POIPU PALMS  
12 UNITS

MARRIOTT'S WAIIOHAI BEACH CLUB  
238 UNITS

POIPU MAKAI  
15 UNITS

**SOUTH SHORE**



# LOCATION



# FLOOR PLAN & LEASING DETAILS

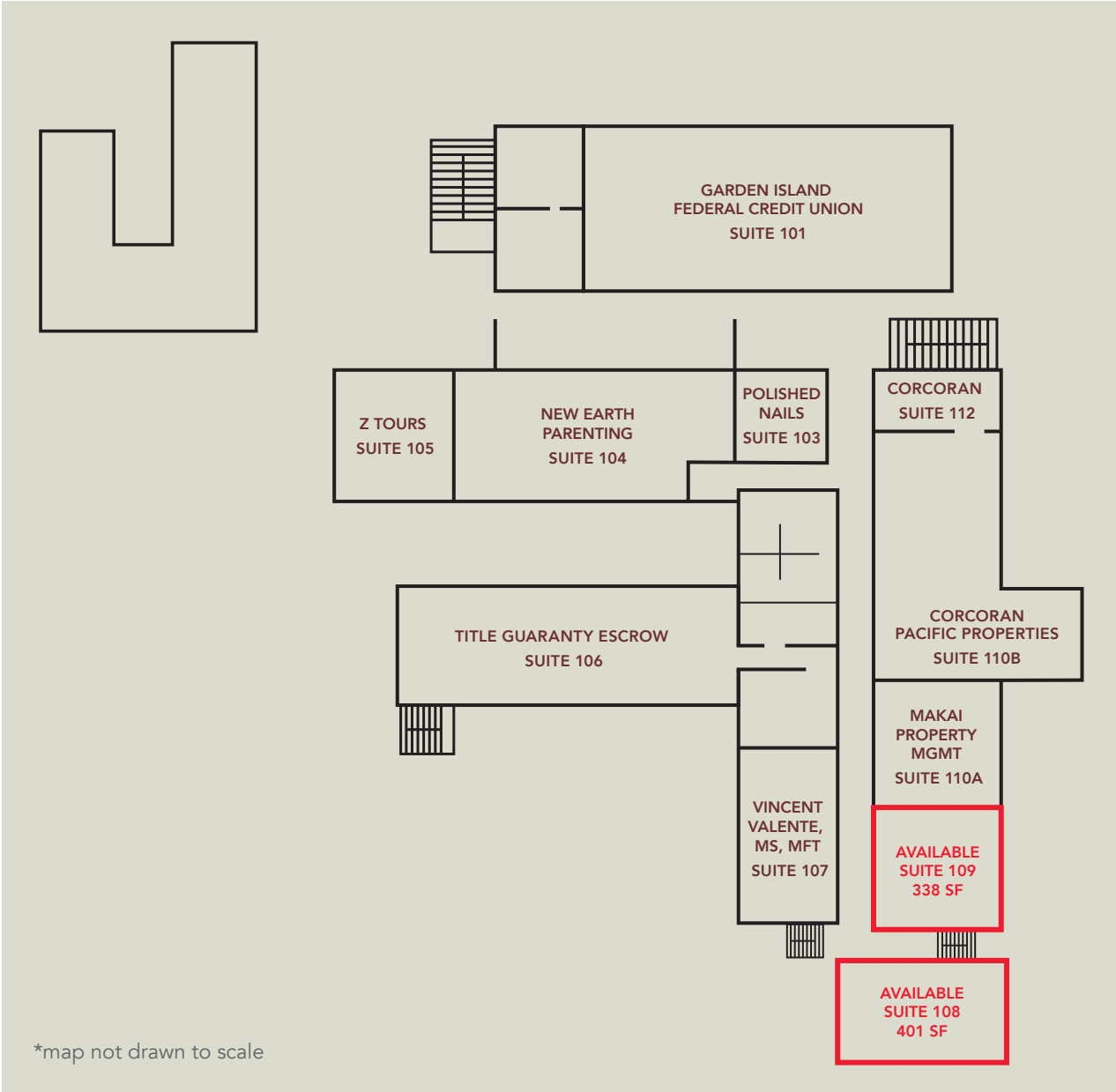

<b>SPACE AVAILABLE</b>	Suite 108 - 401 SF Suite 109 - 338 SF
<b>DATE AVAILABLE</b>	Immediately
<b>TERM</b>	Negotiable
<b>BASE RENT</b>	\$4.00/SF/Month
<b>CAM</b>	\$1.80/SF/Month
<b>HIGHLIGHTS</b>	<ul style="list-style-type: none"> <li>• Excellent visibility on Poipu Road, a main thoroughfare</li> <li>• Walking distance to many shops and eateries in Old Koloa Town</li> </ul>



**DANIEL METSCH (B), VICE PRESIDENT - ASSET MANAGEMENT**  
 (808) 652-9205  
 DAN@THEBEALLCORPORATION.COM

This document has been prepared by The Beall Corporation for advertising and general information only. The Beall Corporation makes no guarantees, representations or warranties of any kind, expressed or implied, regarding the information including, but not limited to, warranties of content, accuracy and reliability. Any interested party should undertake their own inquiries as to the accuracy of the information. The Beall Corporation excludes unequivocally all inferred or implied terms, conditions and warranties arising out of this document and excludes all liability for loss and damages arising there from. This publication is the copyrighted property of The Beall Corporation and/or its licensors(s). © Copyright 2026, All rights reserved.