

FOR SALE OR LEASE > LAND

San Antonio Dr Commercial Pad Sites

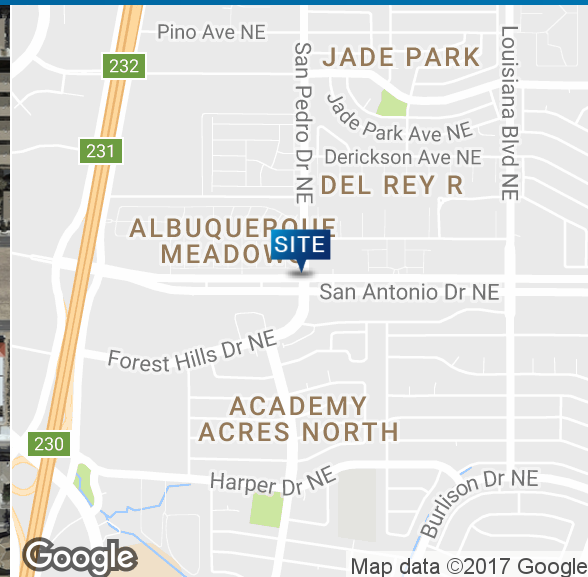

SWC & SEC SAN ANTONIO DR AND SAN PEDRO DR, ALBUQUERQUE, NM 87109

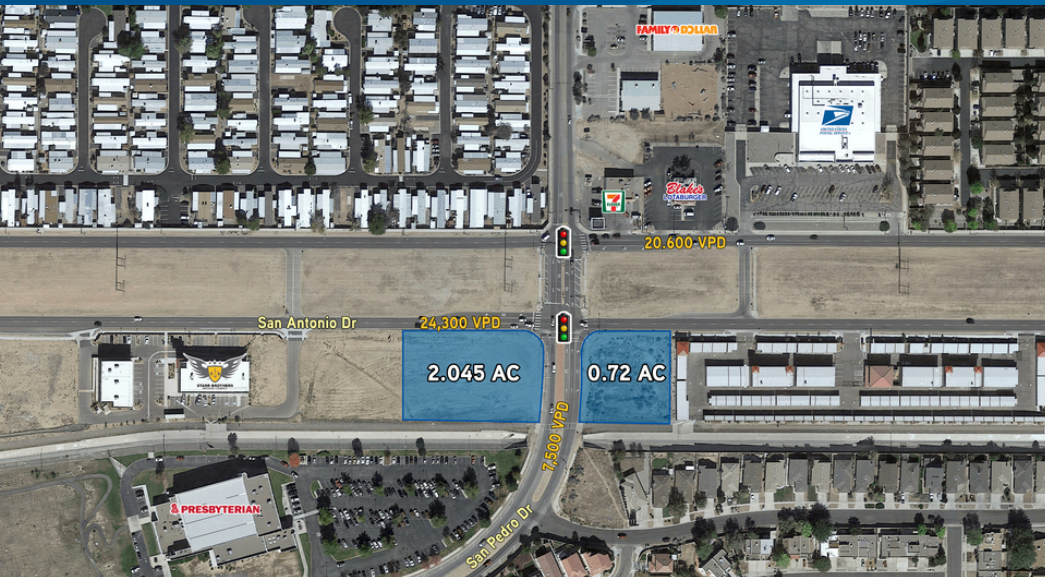

Details

- > Sales Price: \$15.00 SF
- > Lease Rate: \$1.50 SF / YR
- > Lot Size: 0.72 AC - 2.045 AC
- > Zoning: SU-1 For C-1 Uses

Property Features

- > Hard corner commercial pad sites available at the signalized intersection of San Antonio Dr and San Pedro Dr
- > Available for sale, ground lease, or build to suit
- > Ideal site for fuel station, convenience store, restaurant, or medical uses

Area Tenants



Contact Us

BEN PERICH
ASSOCIATE BROKER
+1 505.880.7054
NM LIC.#45966
ALBUQUERQUE, NM 87109
ben.perich@colliers.com

BO GALLES
ASSOCIATE BROKER
+1 505.880.7051
NM LIC.#48318
ALBUQUERQUE, NM 87109
bo.galles@colliers.com

Independently Owned And Operated

The information contained herein was obtained from sources believed reliable, however, Colliers International makes no guarantees, warranties, or representations as to the completeness or accuracy thereof. The presentation of this property is submitted subject to errors, omissions, change of price or conditions prior to sale or lease, or withdrawal without notice.

COLLIERS INTERNATIONAL
+1 505 883 7676 Main
5051 Journal Center Blvd NE, Suite 200
Albuquerque, NM 87109
colliers.com/en-us/newmexico

Aerial Map

SWC & SEC SAN ANTONIO DR AND SAN PEDRO DR, ALBUQUERQUE, NM 87109

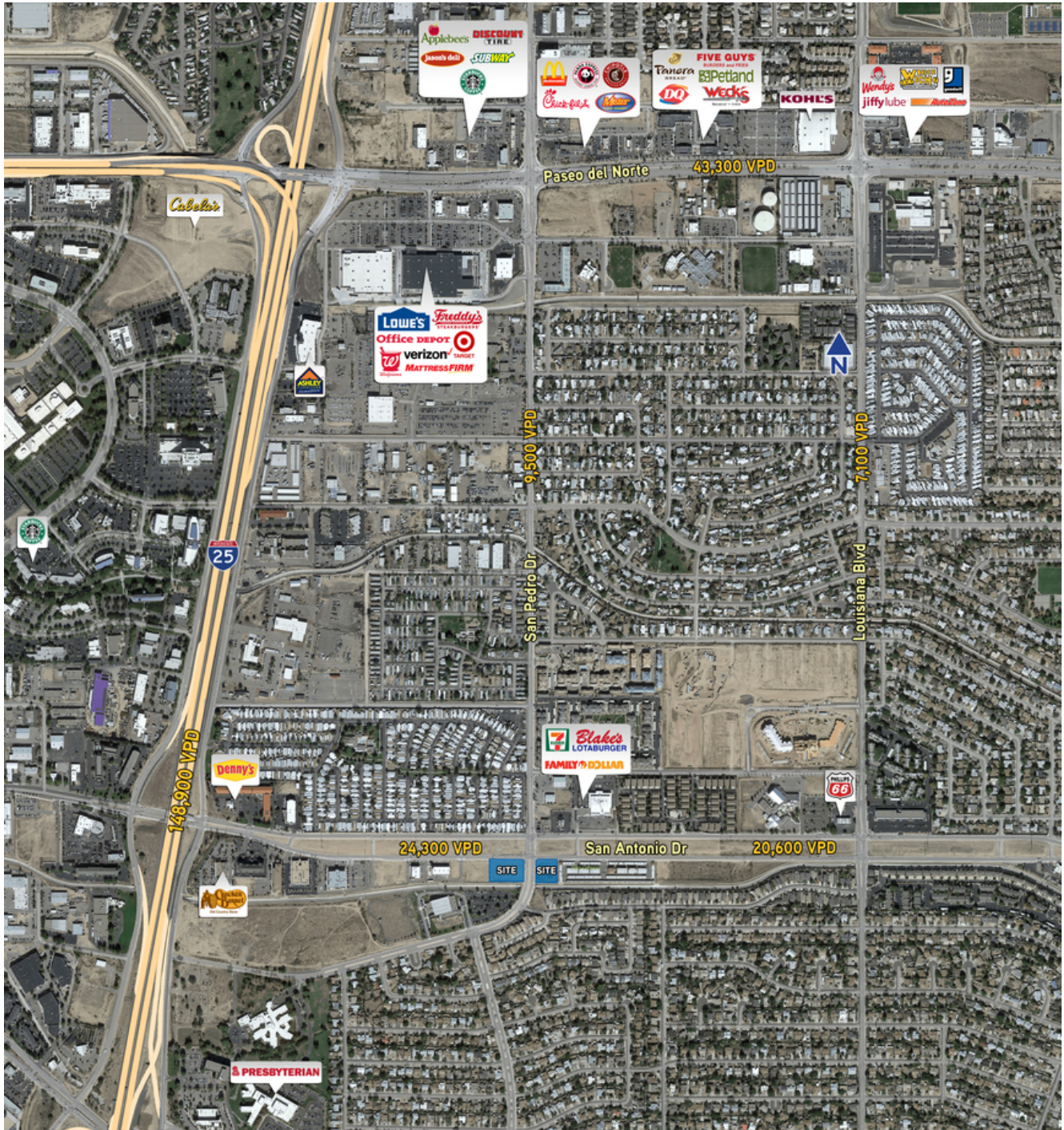

BEN PERICH
+1 505.880.7054
ben.perich@colliers.com
NM Lic.#45966

BO GALLES
+1 505.880.7051
bo.galles@colliers.com
NM Lic.#48318

COLLIERS NEW MEXICO
505.883.7676
5051 Journal Center Blvd NE, Suite 200
Albuquerque, NM 87109
colliers.com/en-us/newmexico

Intersection Aerial Map

SWC & SEC SAN ANTONIO DR AND SAN PEDRO DR, ALBUQUERQUE, NM 87109

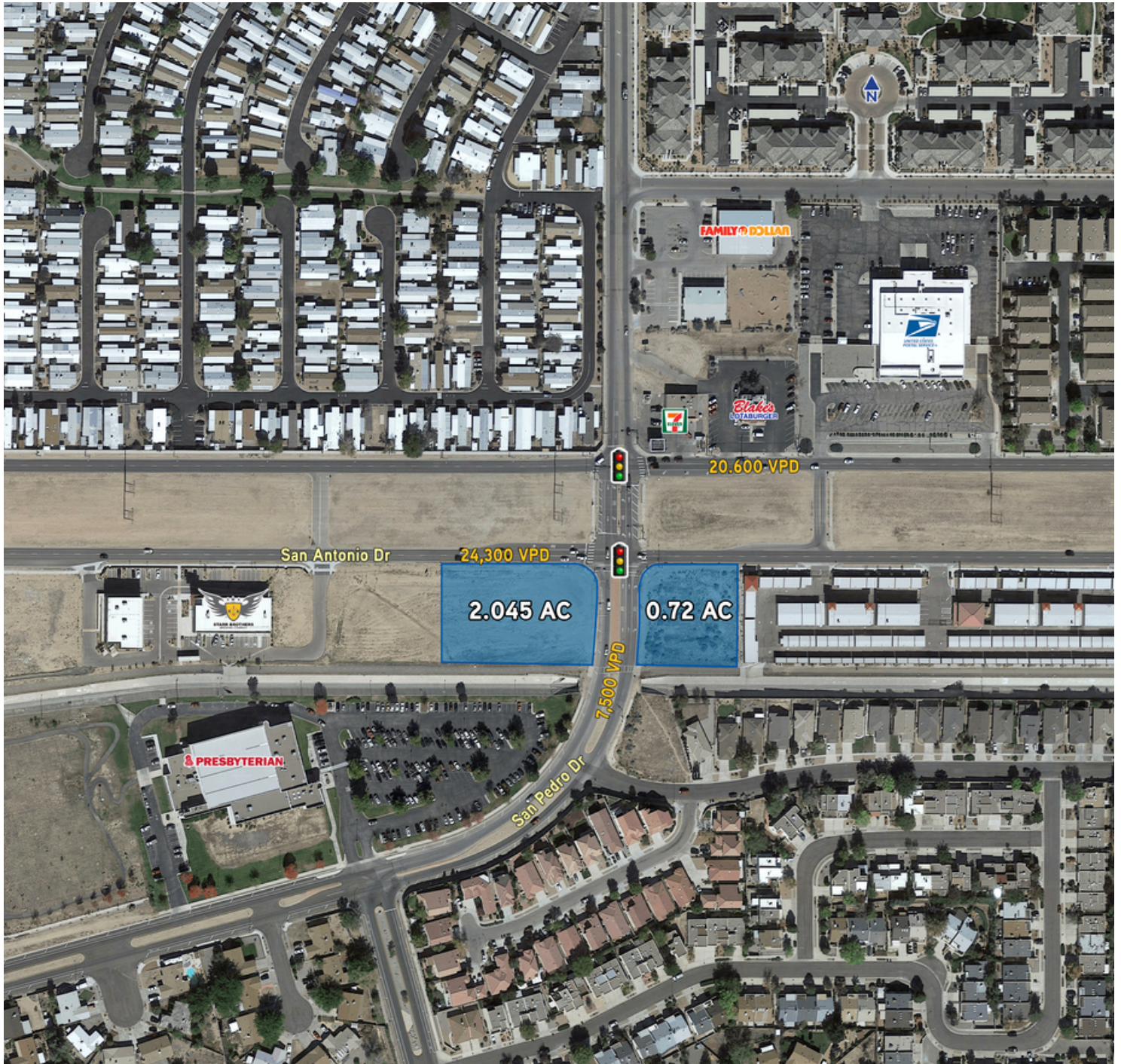

BEN PERICH
+1 505.880.7054
ben.perich@colliers.com
NM Lic.#45966

BO GALLES
+1 505.880.7051
bo.galles@colliers.com
NM Lic.#48318

COLLIERS NEW MEXICO
505.883.7676
5051 Journal Center Blvd NE, Suite 200
Albuquerque, NM 87109
colliers.com/en-us/newmexico

Demographics

SWC & SEC SAN ANTONIO DR AND SAN PEDRO DR, ALBUQUERQUE, NM 87109

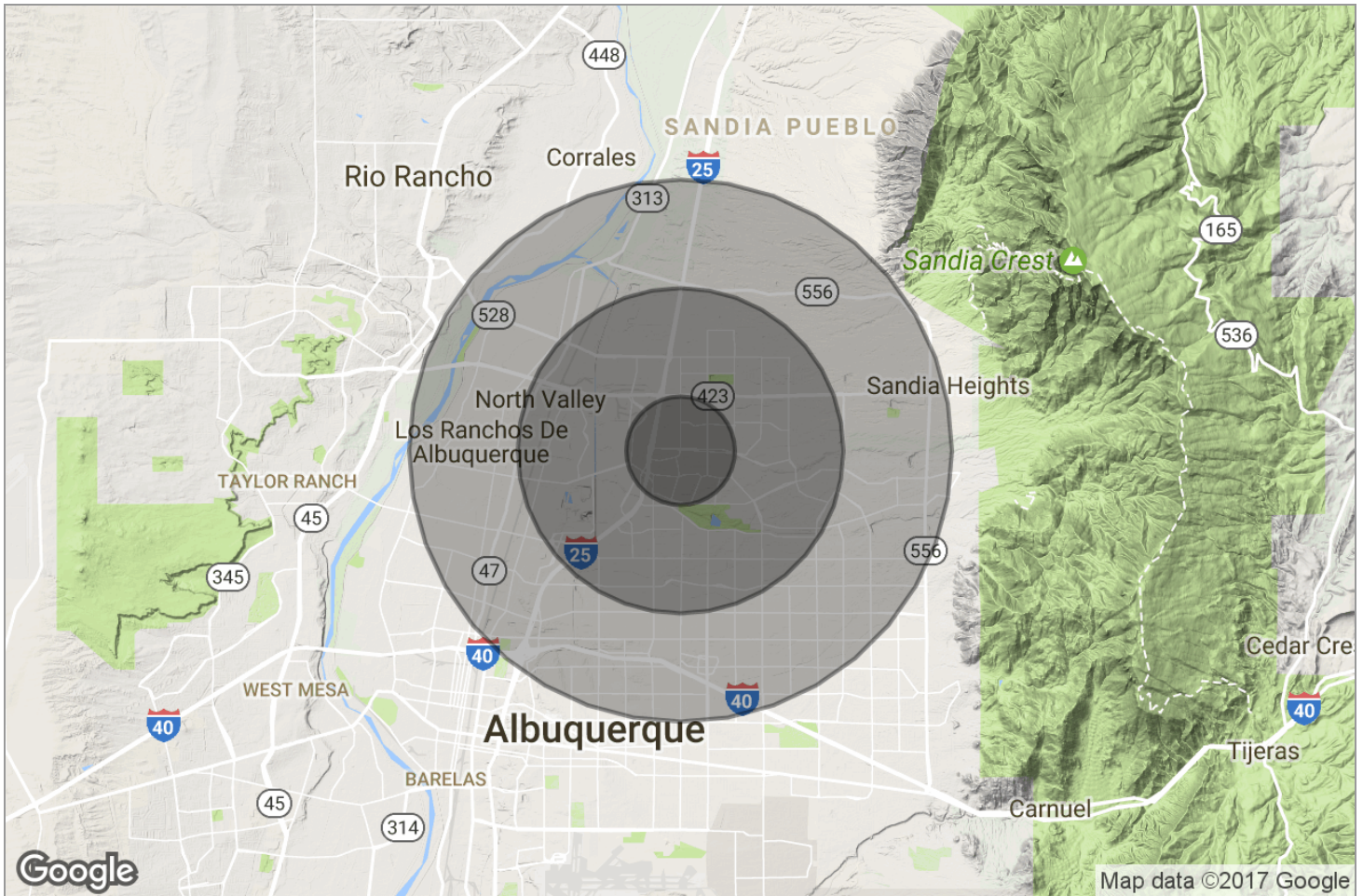

POPULATION

	1 MILE	3 MILES	5 MILES
TOTAL POPULATION	12,887	90,474	216,171
MEDIAN AGE	43.7	40.3	40.7
MEDIAN AGE (MALE)	40.9	38.2	39.2
MEDIAN AGE (FEMALE)	46.3	42.1	42.2

HOUSEHOLDS & INCOME

	1 MILE	3 MILES	5 MILES
TOTAL HOUSEHOLDS	6,131	40,091	95,307
# OF PERSONS PER HH	2.1	2.3	2.3
AVERAGE HH INCOME	\$56,407	\$68,788	\$69,202
AVERAGE HOUSE VALUE	\$145,156	\$246,080	\$245,798

* Demographic data derived from 2010 US Census

BEN PERICH
+1 505.880.7054
ben.perich@colliers.com
NM Lic.#45966

BO GALLES
+1 505.880.7051
bo.galles@colliers.com
NM Lic.#48318

COLLIERS NEW MEXICO
505.883.7676
5051 Journal Center Blvd NE, Suite 200
Albuquerque, NM 87109
colliers.com/en-us/newmexico