

FOR LEASE | ±8,640 SF

1818 NORTH CASE STREET | ORANGE | CALIFORNIA

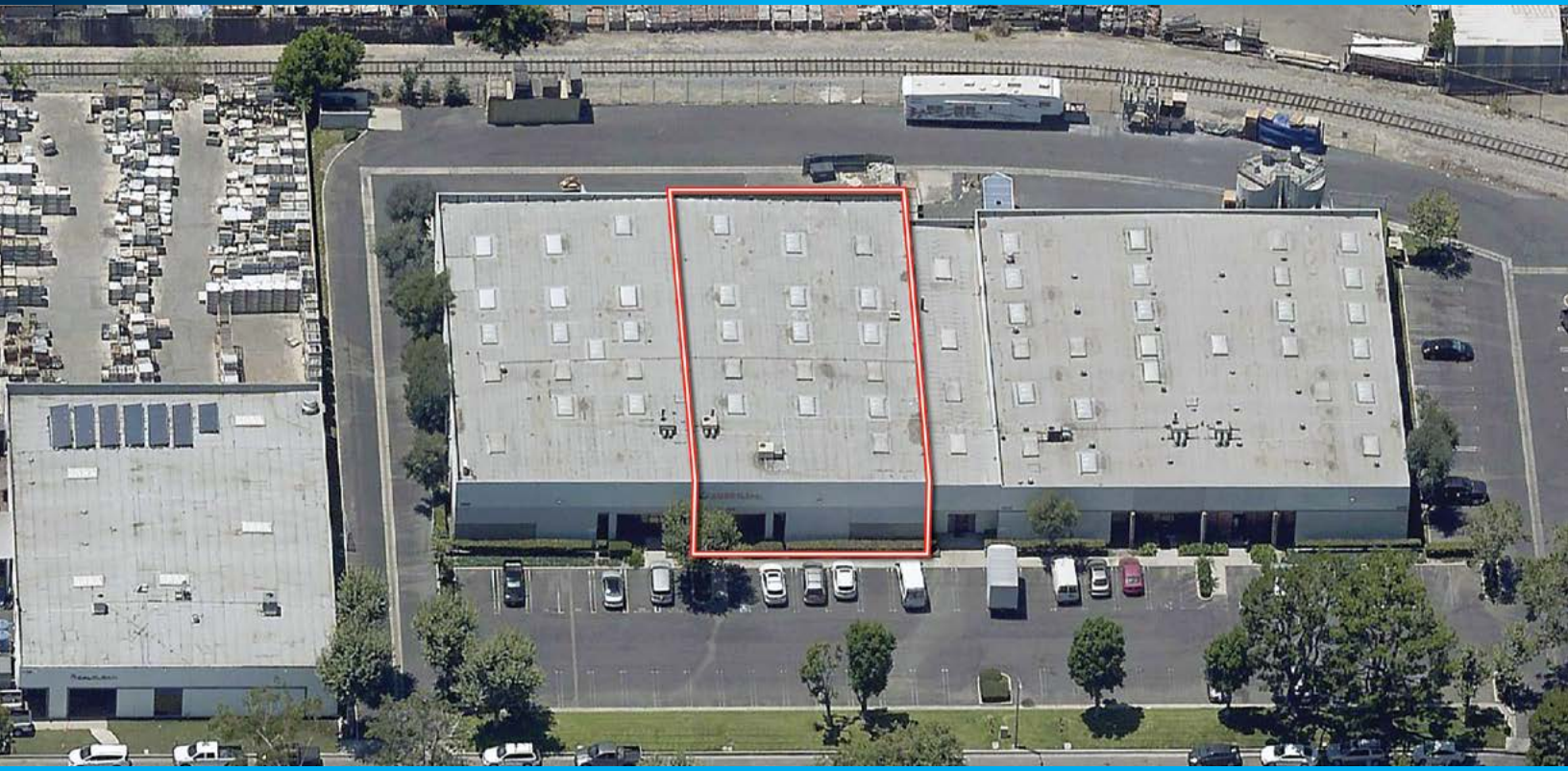

PROPERTY FEATURES

- 1,500 Sq. Ft. of Office Area
- One (1) Ground Level Door
- One (1) Dock High Door
- Fenced Yard Area
- 18' Warehouse Clearance
- 200 AMPS of Power
- 2:1 Parking Ratio
- Shop Restroom
- Fire Sprinklers
- Excellent Access to 57, 5, 22 and 91 Freeways

Michael Hefner, SIOR
EXECUTIVE VICE PRESIDENT

714.935.2331
mhefner@voitco.com
Lic. #00857352

Brenden Hefner
ASSOCIATE

714.935.2326
bhefner@voitco.com
Lic. #02114046

Voit
REAL ESTATE SERVICES

HV
HEFNER
VERNICK
TEAM

2400 East. Katella Avenue | Suite 750 | Anaheim | California 92806 | 714.978.7880 | 714.978.9431 Fax | Lic #01991785 | www.VoitCo.com

The information contained herein has been obtained from sources we deem reliable. While we have no reason to doubt its accuracy, we do not guarantee it. Licensed as Real Estate Salespersons by the DRE.
©2023 Voit Real Estate Services, Inc. All Rights Reserved. License #01991785.

FOR LEASE | ±8,640 SF

1818 NORTH CASE STREET | ORANGE | CALIFORNIA

SITE PLAN

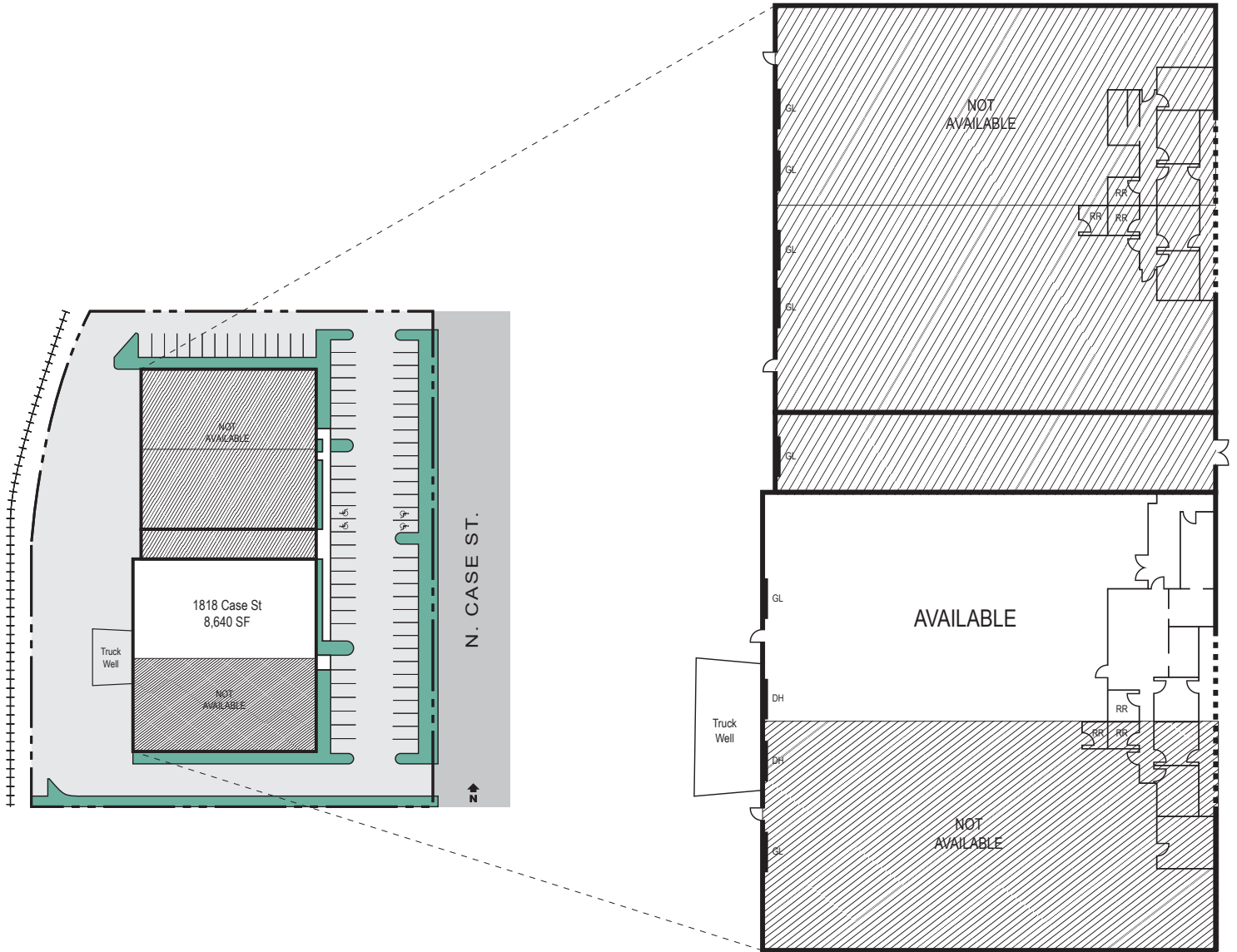

*SITE PLAN NOT TO SCALE

Michael Hefner, SIOR
EXECUTIVE VICE PRESIDENT

714.935.2331
mhefner@voitco.com
Lic. #00857352

Brenden Hefner
ASSOCIATE

714.935.2326
bhefner@voitco.com
Lic. #02114046

Voit
REAL ESTATE SERVICES

HV HEFNER
VERNICK
TEAM

2400 East. Katella Avenue | Suite 750 | Anaheim | California 92806 | 714.978.7880 | 714.978.9431 Fax | Lic #01991785 | www.VoitCo.com

The information contained herein has been obtained from sources we deem reliable. While we have no reason to doubt its accuracy, we do not guarantee it. Licensed as Real Estate Salespersons by the DRE.
©2023 Voit Real Estate Services, Inc. All Rights Reserved. License #01991785.