

savills

SUBLEASE

WAREHOUSE / OFFICE

TRINITY INDUSTRIAL PARK
1232 CROWLEY DRIVE, SUITE 148

SPACE PROFILE

31,050

Total Square Feet

Immediate

Availability

For Sublease

Flexible Term Length

±5,000

Office SF

24'

Clear Height

12/31/2032

Master Lease Expiry

WAREHOUSE AVAILABLE FOR SUBLEASE

KEY HIGHLIGHTS

- Rear-Loading
- Five (5) Dock-High Doors
- One (1) Oversized Drive-In Ramp
- ±5,000 SF Office
- ESFR Sprinkler System
- End Cap Space
- Forty-Four (44) Car Parking Spaces

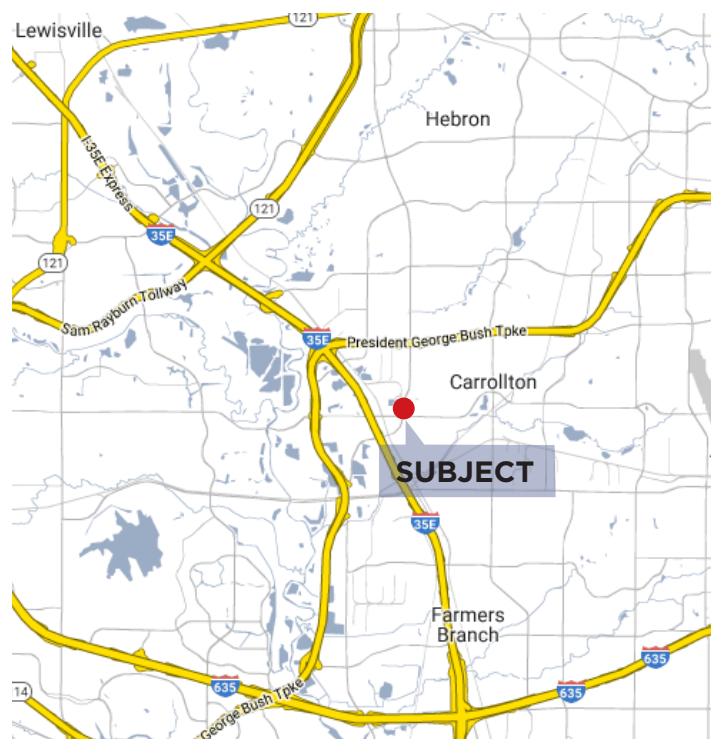

1232 CROWLEY DRIVE, SUITE 148, CARROLLTON, TEXAS 75006

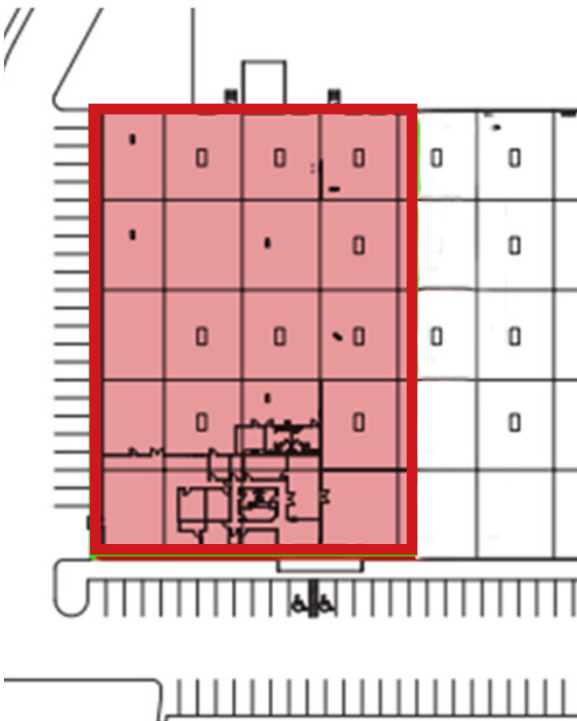

Bob Berry, SIOR
Vice Chairman
+1 281 451 5331
bberry@savills.us

Jeff Wood
Assistant Director
+1 678 316 9256
jwood@savills.us

The information contained in this communication has been obtained from a variety of sources believed to be reliable but has not been verified. NO WARRANTY OR REPRESENTATION, EXPRESS OR IMPLIED, IS MADE AS TO THE CONDITION OF THE PROPERTY OR ACCURACY OR COMPLETENESS OF THE INFORMATION CONTAINED HEREIN AND SAME IS SUBMITTED SUBJECT TO ERRORS, OMISSIONS, CHANGE OF PRICE, RENTAL OR OTHER CONDITIONS, WITHDRAWAL WITHOUT NOTICE AND TO ANY SPECIFIC CONDITIONS IMPOSED BY THE PROPERTY OWNER OR LESSOR.