

420-488 VERNON WAY, STE A

FOR LEASE | OFFICE/WAREHOUSE | 5,000 SF | \$1.45PSF GROSS



EXCLUSIVELY LISTED BY

AIDAN JAMES
aidan.james@ip-cre.com
619.631.8661
Lic. #02060510

NOLAN NARAIN
nolan.narain@ip-cre.com
619.980.5492
Lic. #02191321

JAMES RENNER
jrenner@ip-cre.com
619.518.5444
Lic. #01308083

INLAND PACIFIC

PROPERTY HIGHLIGHTS



420-488 Vernon Way, STE A, El Cajon CA 92020



5,000 SF



Lease Rate: \$1.45 PSF Gross



2 Grade Level Doors: 12'x14'



14.5 - 24' Clear Height



Parking: 30+ Spaces (shared)



Zoning: M ZONE EL CAJON



Proximity to I-8 and Highways 67, 52 & 125

Information herein has been obtained from sources deemed reliable, however its accuracy cannot be guaranteed. The user is required to conduct their own due diligence and verification.



PROPERTY
PHOTOS



FLOOR PLAN

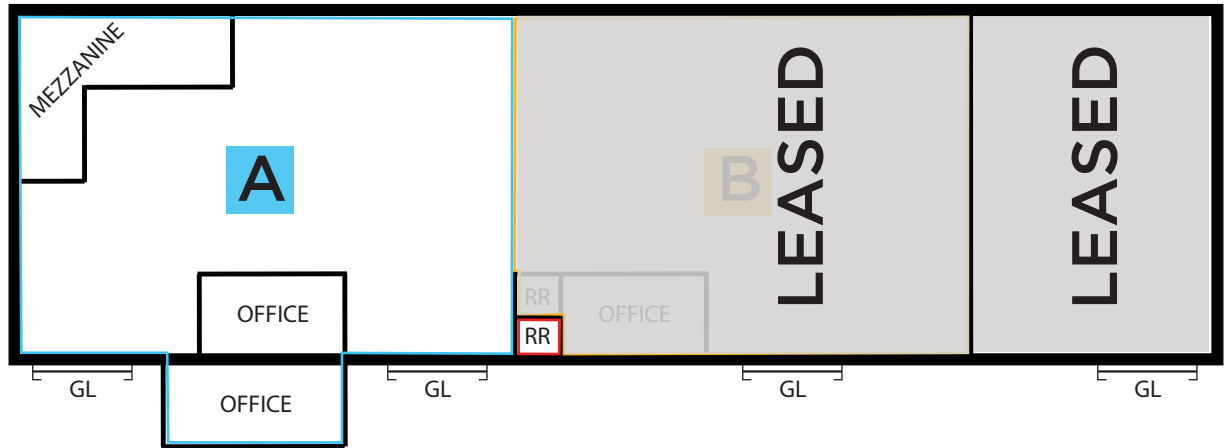
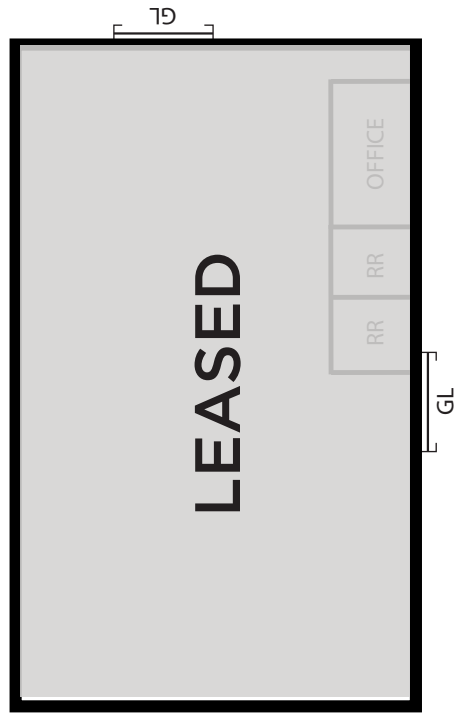

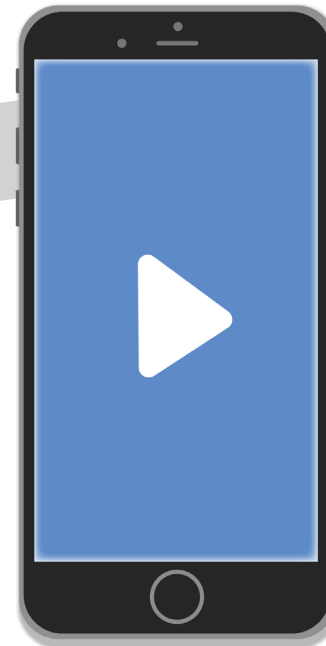

* Drawing not to scale

Vernon Way



VIDEO TOUR

-  Shared Restroom
-  5,000 SF (STE A)

AMENITIES

- Chick-fil-A
- Starbucks
- Epic Wings
- Subway
- Phil's BBQ
- Chipotle
- Taco Bell
- Jersey Mike's
- Chevron
- USPS
- 7-Eleven
- O'Reilly
- Costco
- Vons
- Sprouts
- Lowe's
- UPS Store
- Target
- Chase Bank
- Union Bank
- Verizon
- AT&T
- T-Mobile
- AutoZone

420-488
VERNON WAY
STE A

- In-N-Out
- Urbane Cafe
- Dunkin'
- KFC
- McDonald's
- Panera Bread
- Burger King
- Jamba Juice
- Five Guys
- Texas Roadhouse
- Home Depot
- Walmart
- CVS
- Best Buy
- Smart & Final
- Bank of America
- Mission Federal
- Wells Fargo
- Navy Federal

FOR MORE INFORMATION PLEASE CONTACT

AIDAN JAMES
aidan.james@ip-cre.com
619.631.8661
Lic. #02060510

NOLAN NARAIN
nolan.narain@ip-cre.com
619.980.5492
Lic. #02191321

JAMES RENNER
jrenner@ip-cre.com
619.518.5444
Lic. #01308083

