

401

# WEST 207th ST

CORNER OF 207TH STREET & 9TH AVE  
INWOOD, NYC

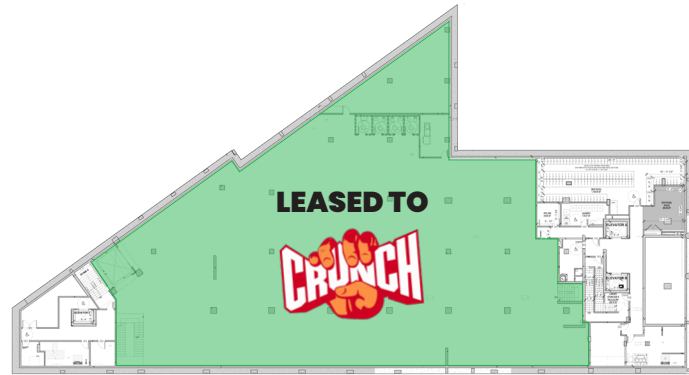

FLOOR PLANS:  
INLINE SPACE:

13,677 SF

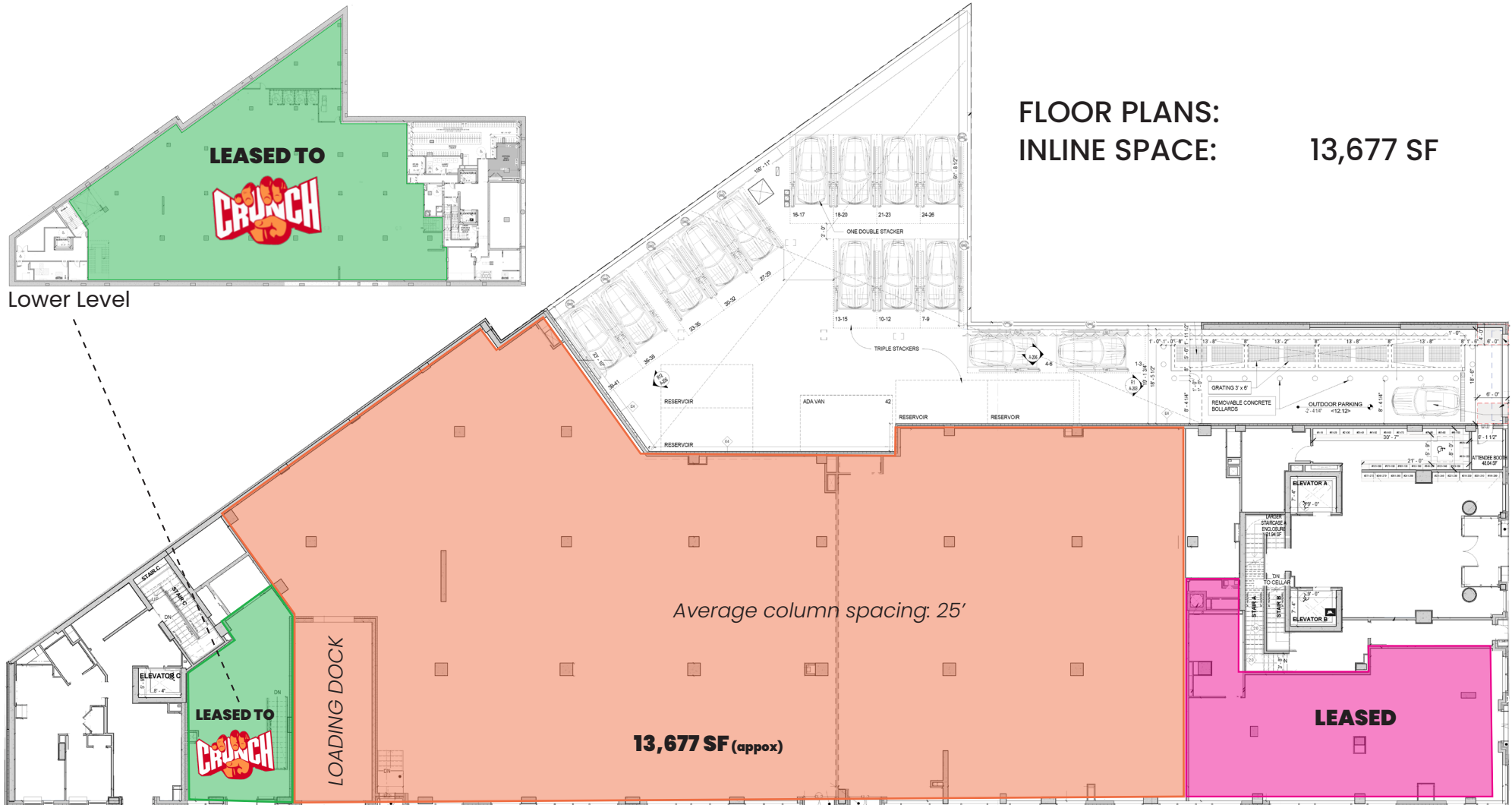

Ground Floor



All information supplied in this marketing presentation and/or flyer is from sources deemed reliable and is furnished subject to errors, omissions, modifications, removal of listings from sale/lease and to any listing condition. Any square footage, dimensions, floor plans and/or technical data set forth are approximations and are subject to further elaboration/confirmation.

# 401

# WEST 207th ST

CORNER OF 207TH STREET & 9TH AVE  
INWOOD, NYC

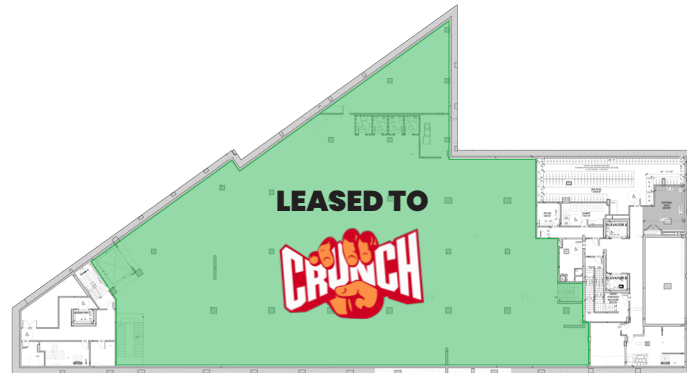

Lower Level

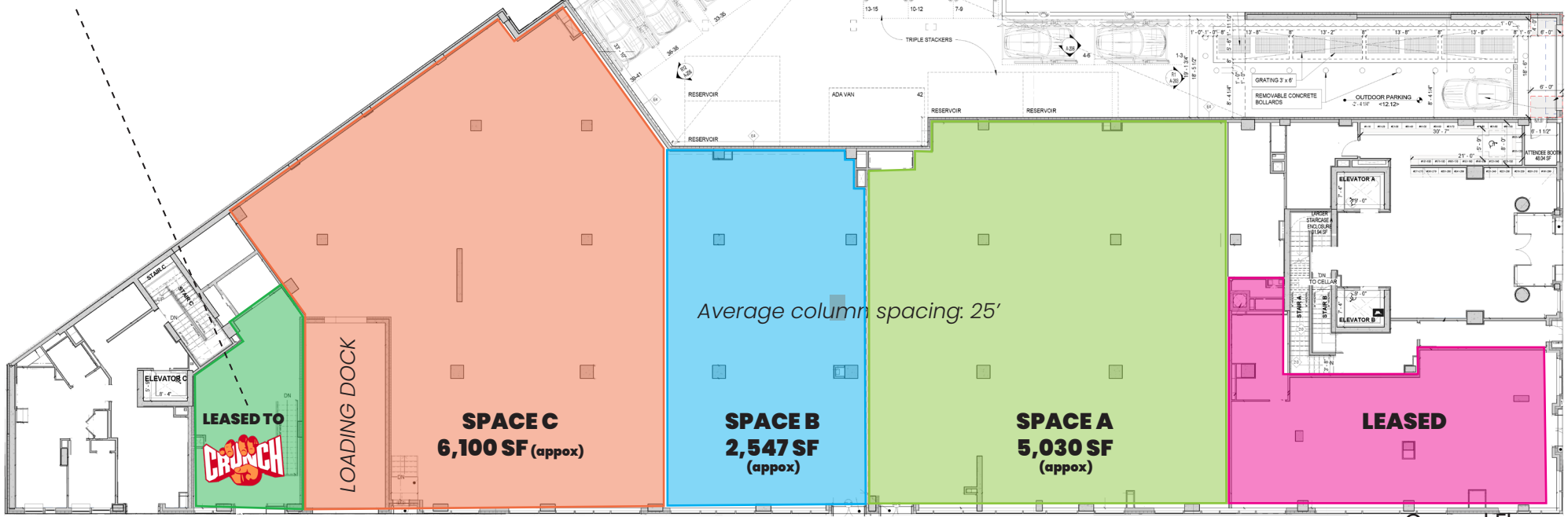

## PROPOSED DIVISION:

### FLOOR PLANS:

SPACE A:	5,030 SF
SPACE B:	2,547 SF
SPACE C:	6,100 SF
<b>TOTAL:</b>	<b>13,677 SF</b>