



Parcel Summary

Parcel Number 0200049520
Location Address MAIN ST S 0122
Brief Tax Description* LAMAR BLK 23 LOTS 11 & 12
*The Description above is not to be used on legal documents.
Tax District N/A
Net Levy N/A
Property Usage COMMERCIAL CARD (009000)
Acreage 0.000

[View Map](#)

Owner Information

Primary Owner
 L&C LLC
 7845 COUNTY HIGHWAY 196
 LAMAR CO 81052

Buildings

Building 1
Type RETAIL
Total Area 10,000
Heated Area 7,300
Bedrooms 0
Baths 2
Year Built 1900

Heating PKG UNIT
Cooling CENTRAL
Primary Exterior Walls BRICK
Primary Interior Walls DRYWALL
Primary Flooring CONCRETE
Roof Structure FLAT
Roof Cover BUILT UP; METAL

Sub Area

Type	Description	Sq. Footage	Year
BAS	BASE AREA	7,000	1959
TWO	TWO STORY	2,000	1959
UBM	BSMT STOR	1,000	1959

Land Information

Code	Land Use	Number of Units	Unit Type
200512	C AREA #5	50.00	FF

Values

	2021	2019
Land Value	\$14,000	\$14,000
Building Value	\$17,138	\$13,855
Extra Features Value	\$0	\$0
Total Value	\$31,138	\$27,855

Sales

Sale Date	Sale Price	Book	Page	Reception Number	Instrument	Qualification	Vacant/Improved	Grantor	Grantee
01/11/2022	\$55,000	555	686	555686	WD	Qualified (Q)	Improved	SANDERS ALAN L	L&C LLC
03/15/2016	\$30,000	540	796	540796	WD	Qualified (Q)	Improved	PEERY RENTALS LLLP	SANDERS ALAN L

Recent Sales in Area

Sale date range:

From: To:

Sketches

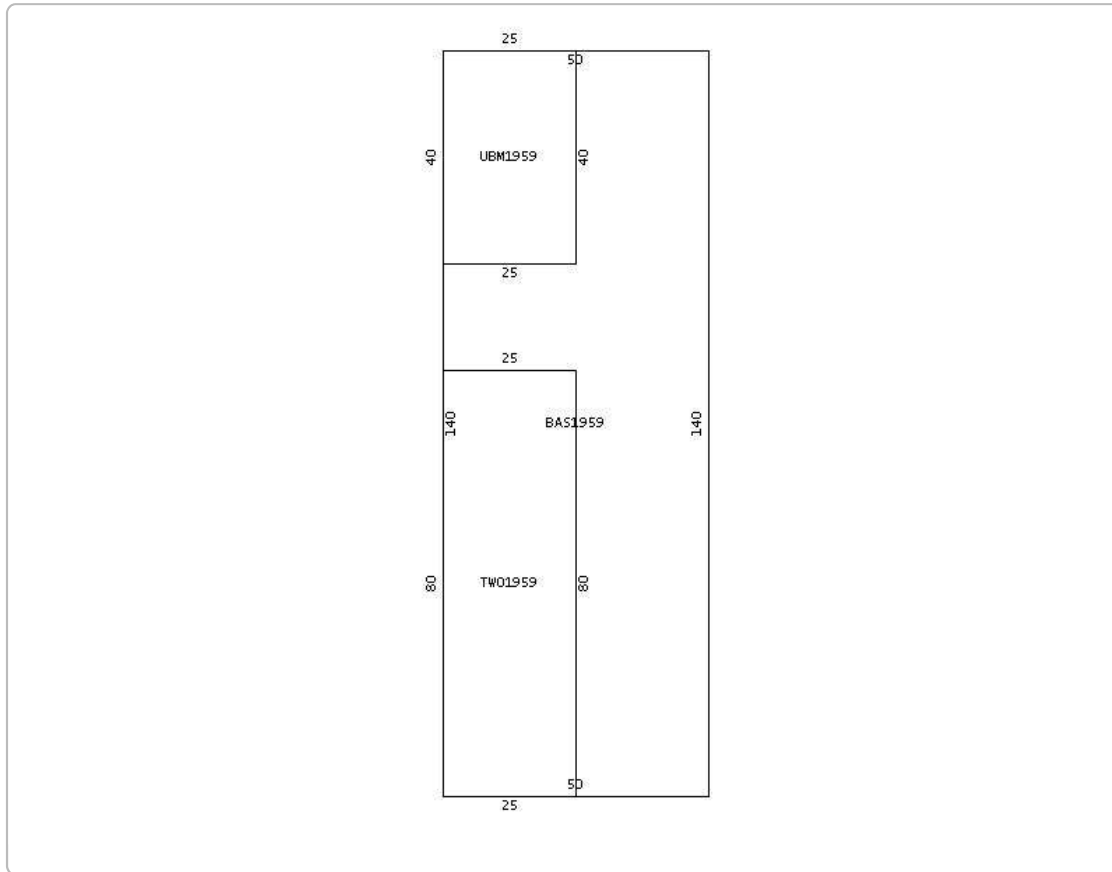

No data available for the following modules: Miscellaneous.

Content Disclaimer Information included in the Prowers County website is believed to be accurate, but is not guaranteed. Prowers County is not liable for any potential errors, omissions or outdated information. The documents posted on the Prowers County website are not official documents and are made available as a convenience.

[User Privacy Policy](#)
[GDPR Privacy Notice](#)

[Last Data Upload: 3/30/2022, 7:19:04 PM](#)

Developed by
 Schneider
GEOSPATIAL

Version 2.3.181