

LAST REMAINING SPACE: ±5,013 SF

GOODYEAR MEDICAL PLAZA

1325 North Litchfield Road
Goodyear, AZ

**MEDICAL OFFICE
FOR LEASE**

**CONSTRUCTION
COMPLETED**



LAST REMAINING SPACE: 5,013 SF Divisible

FEATURES

- ±50,000 SF Single-Story Class A medical office building
- Spaces available from ±5,000 SF
- Former Palm Valley Cinemas transformed into a state-of-the-art medical office
- Owned, developed and managed by PMB Real Estate Services

LOCATION

- Adjacent to Abrazo West Campus with new access road
- Adjacent to a Target anchored shopping center with retail visibility and proximity to the hospital campus
- Numerous amenities nearby including: 288 restaurants, 258 retail and 16 hotels within a 5-mile radius

TENANT MIX

- Abrazo West Campus – Wound Care
- Abrazo Medical Group – Primary Care & Specialists
- Med-Cure – Internal Medicine
- Simon Med Imaging – State of the Art Imaging Facility
- AZ Pain Doctors – Pain Management
- STI – Physical Therapy

ABRAZO WEST CAMPUS

- 188 bed Acute Care Hospital
- Level 1 Trauma Center
- 2014 Women's Choice Award for Emergency Care
- Specializing in Cardiovascular Care, Orthopedics, Critical Care, Obstetrics, Imaging, Surgical Care and more

OWNERSHIP INFORMATION

Pacific Medical Buildings is a healthcare real estate developer providing services to health systems, hospitals, medical groups, and universities. We develop, lease, and manage medical office buildings, ambulatory care centers, clinics, academic medical facilities, and parking structures.



LEASING OPPORTUNITY

- Last space available: ±5,013 SF divisible
- \$24.00 NNN
- Tenant improvement allowance available



PUBLIC ENTRY & RECEPTION

**AVAILABLE: ±5,013 RSF
(Divisible)**

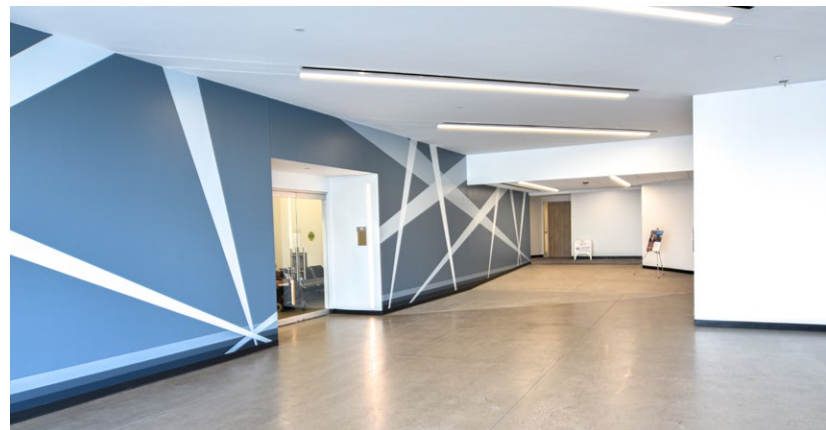
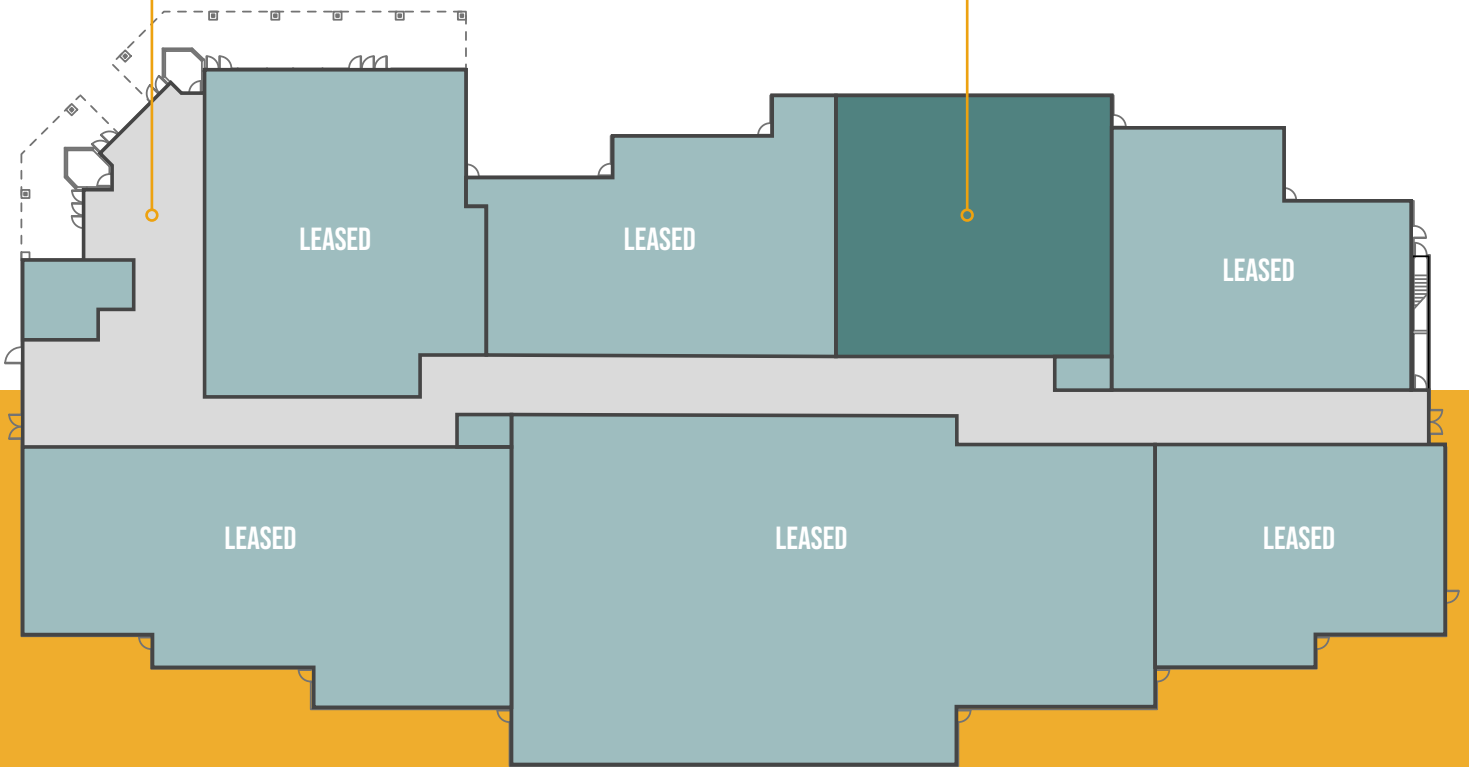



TRANSWESTERN[®]

2501 East Camelback Road, Suite 1
Phoenix, Arizona 85016
T 602.956.5000 F 602.956.5333
www.transwestern.com

FOR MORE INFORMATION, PLEASE CONTACT:

Vince Femiano
Senior Vice President
602.954.7559
vince.femiano@transwestern.com

Kate Morris
Senior Vice President
602.296.6369
kate.morris@transwestern.com

Kevin Smigiel
Senior Associate
602.265.5502
kevin.smigiel@transwestern.com

The information provided herein was obtained from sources believed reliable; however, Transwestern makes no guarantees, warranties or representations as to the completeness or accuracy thereof. The presentation of this property is submitted subject to errors, omissions, change of price or conditions, prior sale or lease, or withdrawal without notice. Copyright © 2019 Transwestern. 0819.