

AVAILABLE > ±104,000 SF TO-BE-BUILT

Solano Business Park

NORTH WATNEY WAY | FAIRFIELD, CALIFORNIA 94533

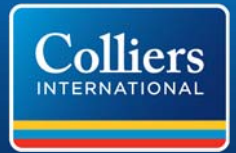

Property Description

- > ±5.57 gross acres (±242,629 SF)
- > ±474' (width) x ±710' (depth)
- > Access from Chadbourne Road & Cordelia Road
- > Utilities to Site
- > Light Industrial Zoning
- > APN: 0028-750-310-01

Comments

Project now has planning approval.
Excellent access to I-80 with tremendous exposure to Hwy. 12 (±474'). Property is located adjacent to Jelly Belly Candy Company in the Solano Business Park.

Shell Improvements To-Be-Built

- > ±104,000 SF Concrete Tilt-up Building To-Be-Built (±200' x ±520')
- > Minimum Clear Height: ±30'
- > Columns: ±40' & ±60' wide and ±50' deep
- > Landscaping and Irrigation
- > **Side Loaded Truck Access:**
 - Grade Level - ±5 (±12' x ±14') - 2 front, 1 side, 2 rear
 - Dock High - ±18 (±9' x ±10') - front
- > Parking: ±1/±1,000 SF
- > Concrete Slab ±6" with #3 rebar ±24" OCEW
- > **Fire Sprinklers:** ESFR
- > Power: ±2,500 amp @277/480 volts to main panel
- > **Roofing:** Single Ply 60 Mil TPO

Contact Us

PHIL GARRETT, SIOR
phil.garrett@colliers.com
±1 707 863 8357
CA License No. 00844836

COLLIERS INTERNATIONAL
360 Campus Lane, Suite 101
Fairfield, CA 94534
www.colliers.com

AVAILABLE > ±104,000 SF TO-BE-BUILT

Solano Business Park

NORTH WATNEY WAY | FAIRFIELD, CALIFORNIA 94533

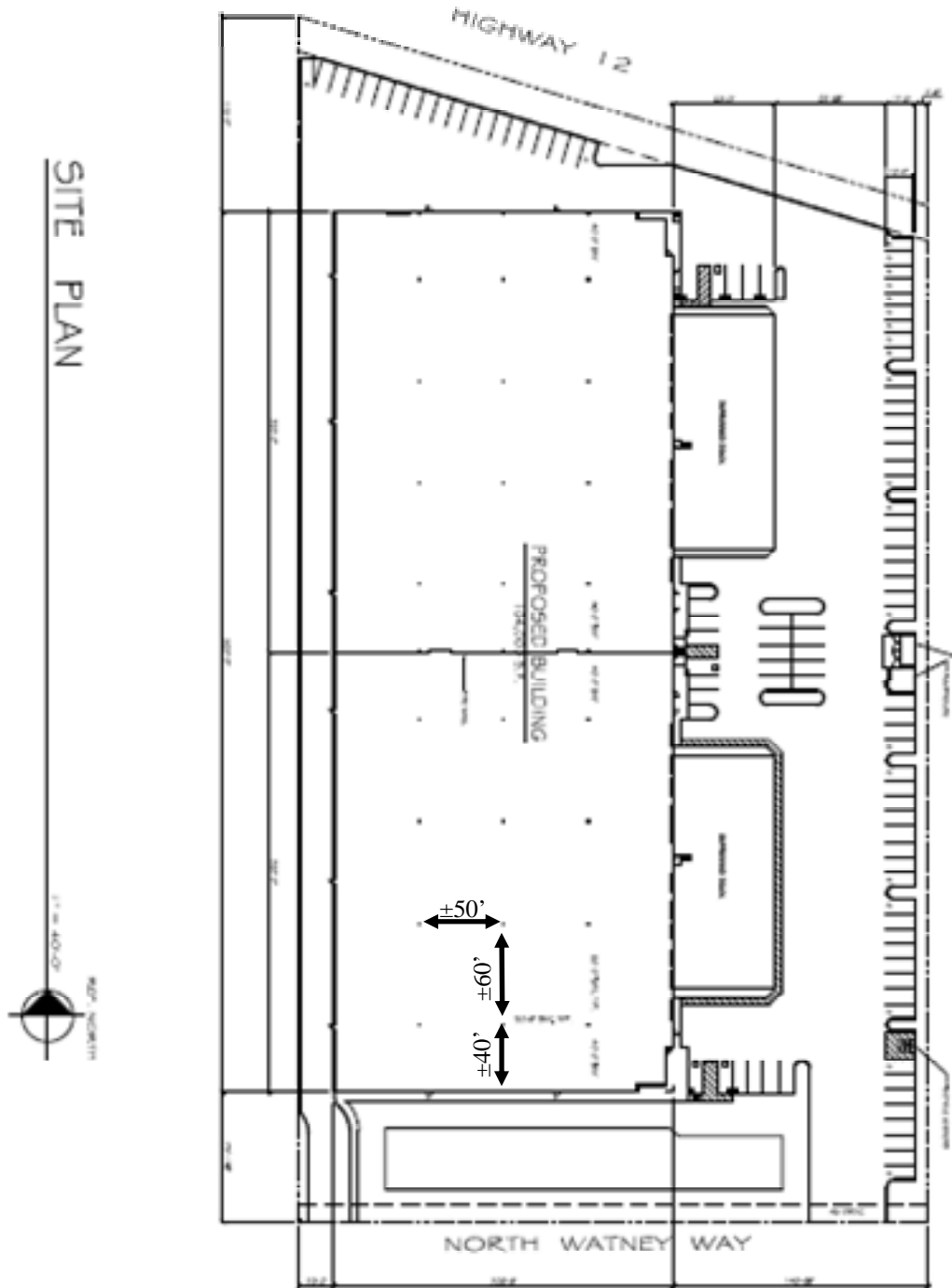

Contact Us

PHIL GARRETT, SIOR
phil.garrett@colliers.com
±1 707 863 8357
CA License No. 00844836

The information furnished has been obtained from sources we deem reliable and is submitted subject to errors, omissions, and changes. Although Colliers Parrish International, Inc. has no reason to doubt its accuracy, we do not guarantee it. All information should be verified by the recipient prior to lease, purchase, exchange, or execution of legal documents. © 2016 Colliers International