

**INDUSTRIAL | FOR LEASE**

**+/- 7,911 SF SHELL | +/- 2,514 SF OFFICE | DOCK AND GRADE LOADING**

**EXPRESSWAY  
PARK  
BUILDING THREE**



**6036 N CUTTER CIRCLE, PORTLAND, OR 97217 | BUILDING THREE - SUITE 360**

**CBRE**

# EXPRESSWAY PARK | BUILDING THREE

6036 N CUTTER CIRCLE, PORTLAND, OR 97217

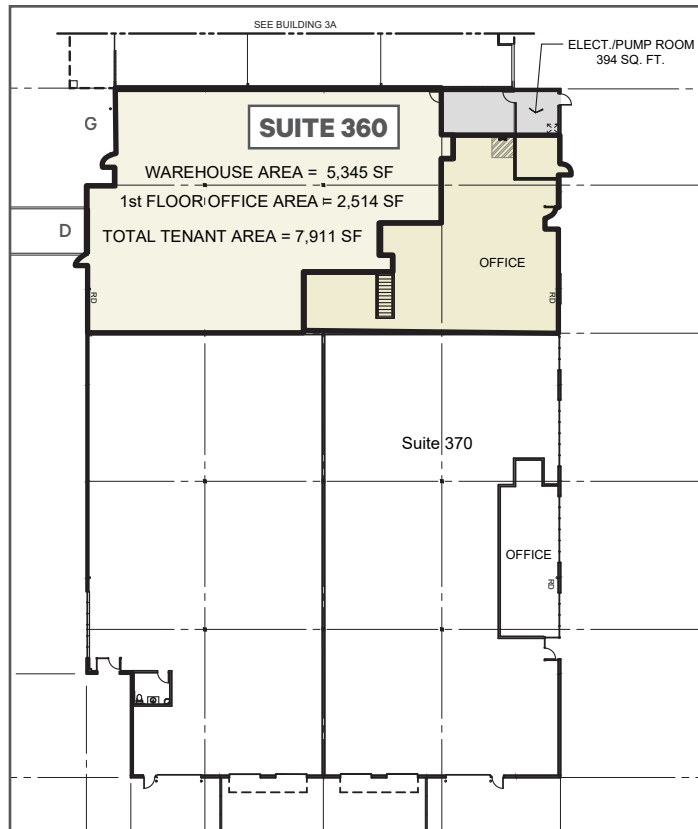

## BUILDING THREE - SUITE 360

- **Total Shell:** +/- 7,911 SF
- **Total Office:** +/- 2,514 SF
- **Grade Loading:** 1 Grade Level Door
- **Dock Loading:** 1 Dock Level Door
- **Clear Height:** 25.5'
- **Construction:** Quality Concrete Tilt Up
- **Zoning:** IG2, City of Portland
- **Access:** Easy Access to I-5
- Can be combined with adjacent suite 350 for a total suite size of:
  - **Total Shell:** +/- 15,307 SF
  - **Total Office:** +/- 2,514 SF

**CALL FOR RATES**

**CBRE**

# EXPRESSWAY PARK | BUILDING THREE

6036 N CUTTER CIRCLE, PORTLAND, OR 97217



## BUILDING THREE - SUITE 360

- Expressway Park is approximately 303,494 SF, located in Portland, OR. It has four buildings that offer a range of sizes to Tenants.
- Expressway Park is less than 2 miles from I-5, 4.5 miles from downtown, and 7 miles from Vancouver, WA. It is an ideal location with easy access to major freeways as well as hotels, shopping, and dining.
- This last mile submarket is home to many predominant companies such as UPS, FEDEX, Daimler Trucks North America, and Vigor.



**Cara Nolan, SIOR**  
Senior Vice President  
+1 503 221 4840  
cara.nolan@cbre.com



**Caitlin Knecht**  
Associate  
+1 503 221 4847  
caitlin.knecht@cbre.com

**CBRE**

5 MINUTES TO I-5



# EXPRESSWAY PARK BUILDING THREE

## CONTACTS



**Cara Nolan, SIOR**  
Senior Vice President  
+1 503 221 4840  
[cara.nolan@cbre.com](mailto:cara.nolan@cbre.com)



**Caitlin Knecht**  
Associate  
+1 503 221 4847  
[caitlin.knecht@cbre.com](mailto:caitlin.knecht@cbre.com)

CBRE, INC | 1300 SW 5TH AVENUE #3500 | PORTLAND, OR 97201

© 2022 CBRE, Inc. All rights reserved. This information has been obtained from sources believed reliable, but has not been verified for accuracy or completeness. You should conduct a careful, independent investigation of the property and verify all information. Any reliance on this information is solely at your own risk. CBRE and the CBRE logo are service marks of CBRE, Inc. All other marks displayed on this document are the property of their respective owners, and the use of such logos does not imply any affiliation with or endorsement of CBRE. Photos herein are the property of their respective owners. Use of these images without the express written consent of the owner is prohibited.

**CBRE**