

3RD FLOOR RECREATIONAL SPACE  
**AVAILABLE FOR LEASE**

**50,000 SF  
AVAILABLE**



← EAST  
WEST →

**WILLOWBROOK BLVD. 10,558 VPD**

**77-79 WILLOWBROOK BLVD.**  
WAYNE, NEW JERSEY

**FOR LEASE UP TO 50,000 SF**

**WILLOWBROOK PLAZA**

**WILLIAM FARKAS** | [bfarkas@jefferyrealty.com](mailto:bfarkas@jefferyrealty.com)  
C: 973.223.6600 O: 908.668.9600 x215

**JOIN FLOOR DECOR & at home Burlington**  
The Home Décor Superstore

**MIKE TESTA** | [mtesta@jefferyrealty.com](mailto:mtesta@jefferyrealty.com)  
C: 201.232.6086 O: 908.668.9600 x289



**JEFFERY REALTY**  
Retail Specialist

116 Route 22 • North Plainfield, NJ 07060 • T: 908.668.9600 • F: 908.668.5225 • [www.JefferyRealty.com](http://www.JefferyRealty.com)  
All information is from sources deemed reliable and is submitted subject to errors, omissions, change of price, terms, prior sales and withdrawals.





**TRAFFIC:** 10,558 VPD WILLOWBROOK BLVD.  
 120,868 VPD ROUTE 46  
 123,085 VPD ROUTE 80

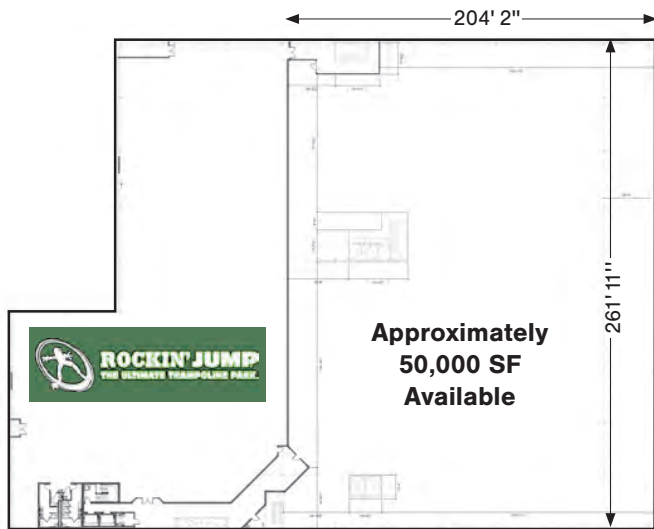

**77-79 WILLOWBROOK BLVD. WAYNE, NJ**

## SITE INFORMATION

**GLA:** 351,574 SF  
**AVAILABLE:** UP TO 50,000 SF  
**RENT:** CALL FOR QUOTE  
**PARKING:** 1,210 SPACE  
**CEILINGS:** 24'-6" CLEAR

**NOTES:** 351,574 square foot anchored center located at the bullseye of the Wayne Regional Trade area. It is prominently located on the ring road of the Willowbrook Mall and adjacent to the Wayne Town Center. This site offer easy access to Route 46, Route 23, and Interstate Route 80. The space itself offers 24' clear ceiling heights and shares elevator access with Rockin Jump to the front door of the space. Both this space along with Rockin Jump share an oversized parking lot located in the rear of the shopping center leading directly to their main entrance.



**77-79 WILLOWBROOK BLVD. WAYNE, NJ**

**LOCAL MARKET**



DEMOGRAPHICS	1 MILE	3 MILE	5 MILE
Total Population	6,797	68,522	280,443
Average HHI	\$154,906	\$155,613	\$137,877
Households	2,603	23,831	98,415



**77-79 WILLOWBROOK BLVD. WAYNE, NJ**

**MARKET AERIAL**