

24,869 SF FACILITIES FOR SALE



CONTACT:

Ryan Welch
(843) 747-5856
RWelch@Lee-Associates.com

143 Hotel Street | Saint Stephen, SC

SIZE: 24,869 SF PRICE: \$149,900

OVERVIEW



PROPERTY DESCRIPTION

Bank owned property providing approximately 24,869 SF on 5.49 acres in St. Stephens. There is a 9,169 SF former school facility, a 3,540 SF rectory and a 12,160 SF warehouse that was previously used as a sanctuary.

AREA OVERVIEW

The Subject facility is located in the Town of Saint Stephens in Berkeley County just off the intersection of Highway 52. The subject site neighbors the Albany International Corporation.

DIRECTIONS

From Charleston take I-26 west to the US Hwy 52 Goose Creek |Moncks Corner exit (Exit 209B-A) towards Goose Creek. Hold Hwy 52 straight into St. Stephens and take a right on Martin Luther King Blvd and you will run into the subject site. Look for the Lee & Associates sign.

Disclaimer: This is subject prior to sale, change in price, or removal from the market without notice. The information included in this transmittal, while based upon data supplied by the owners and other sources deemed to be reliable, is not in any way warranted by Lee & Associates.

MAP

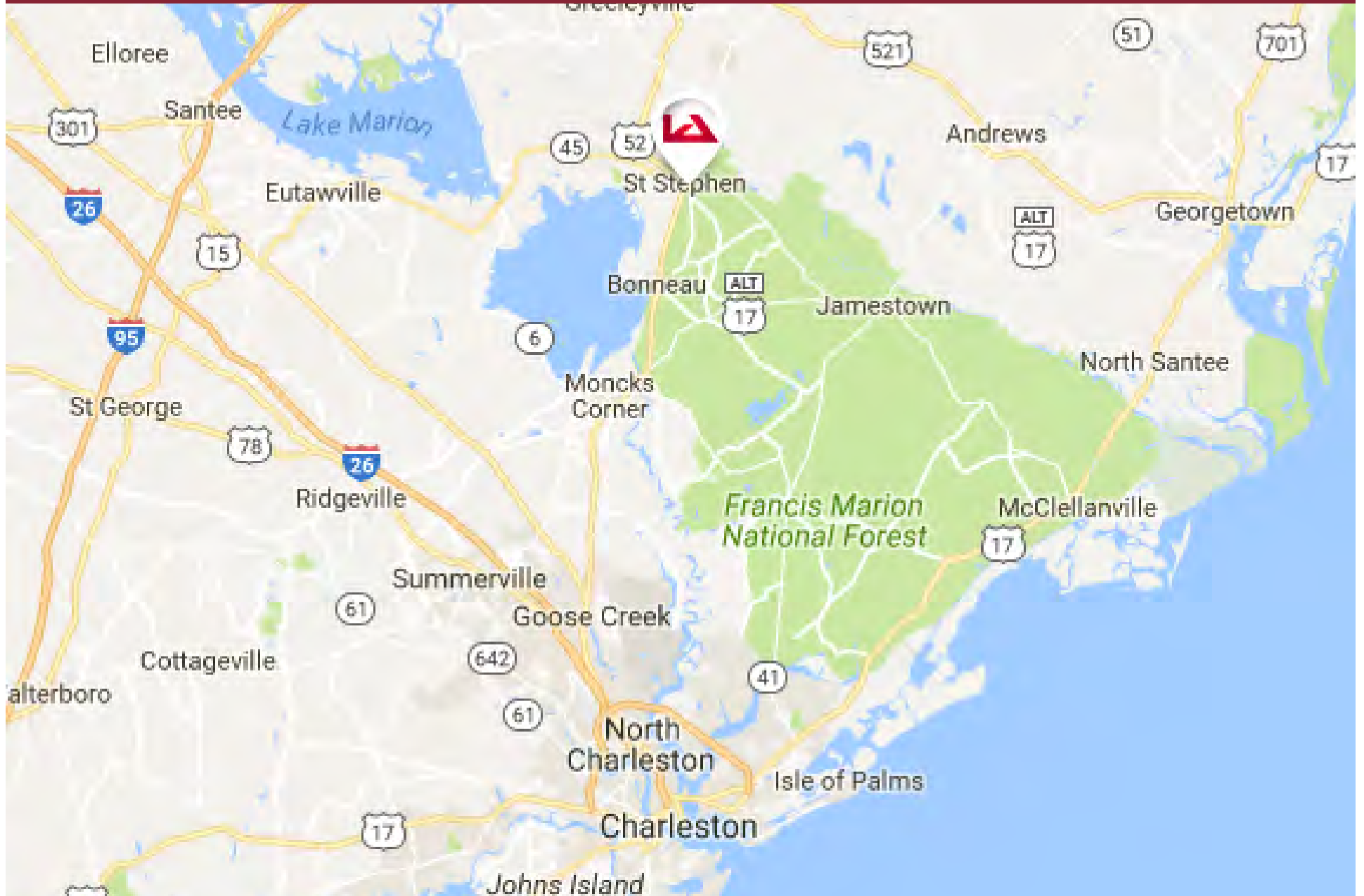

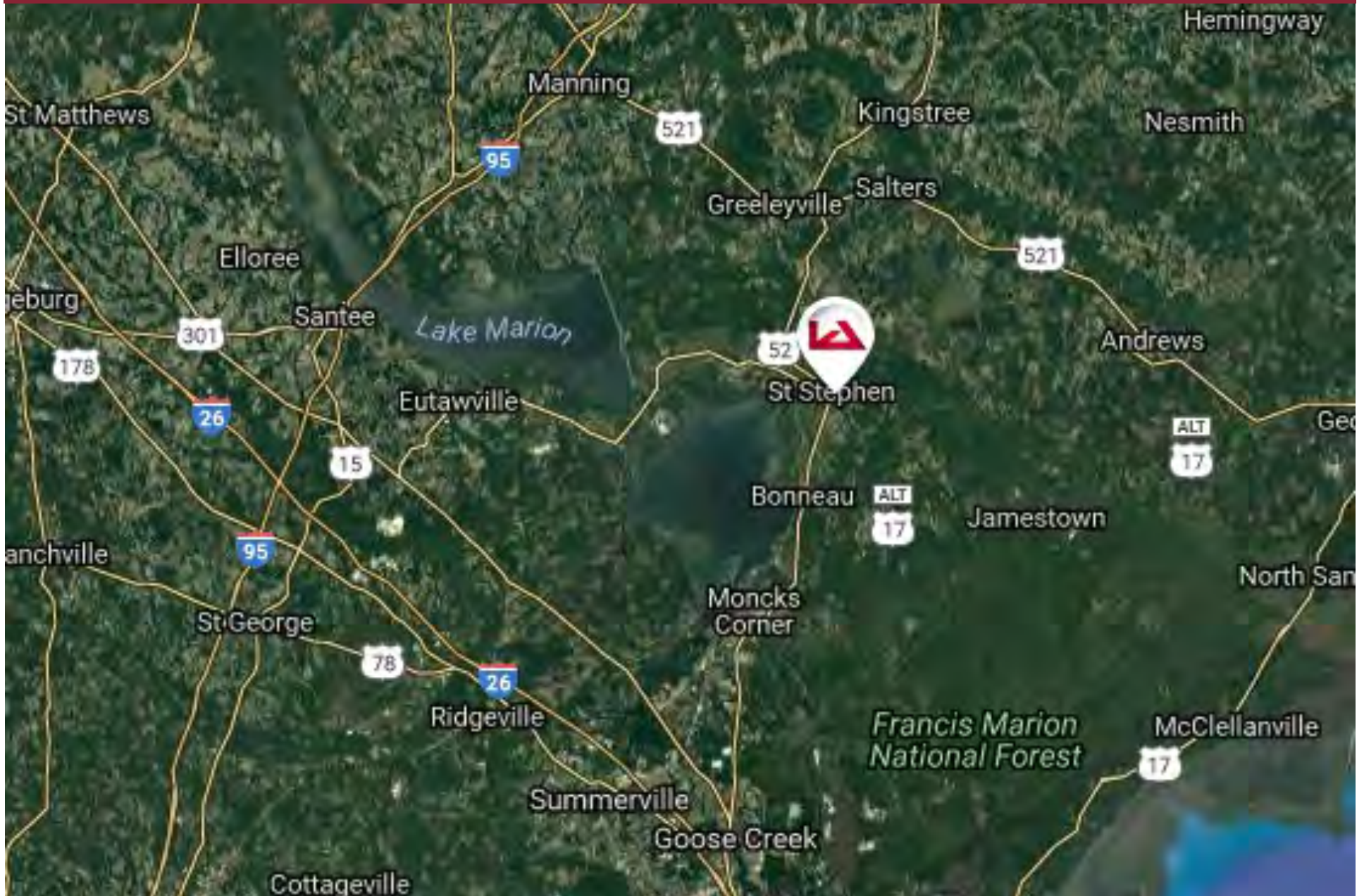

FLOOR PLAN



FLOOR PLAN

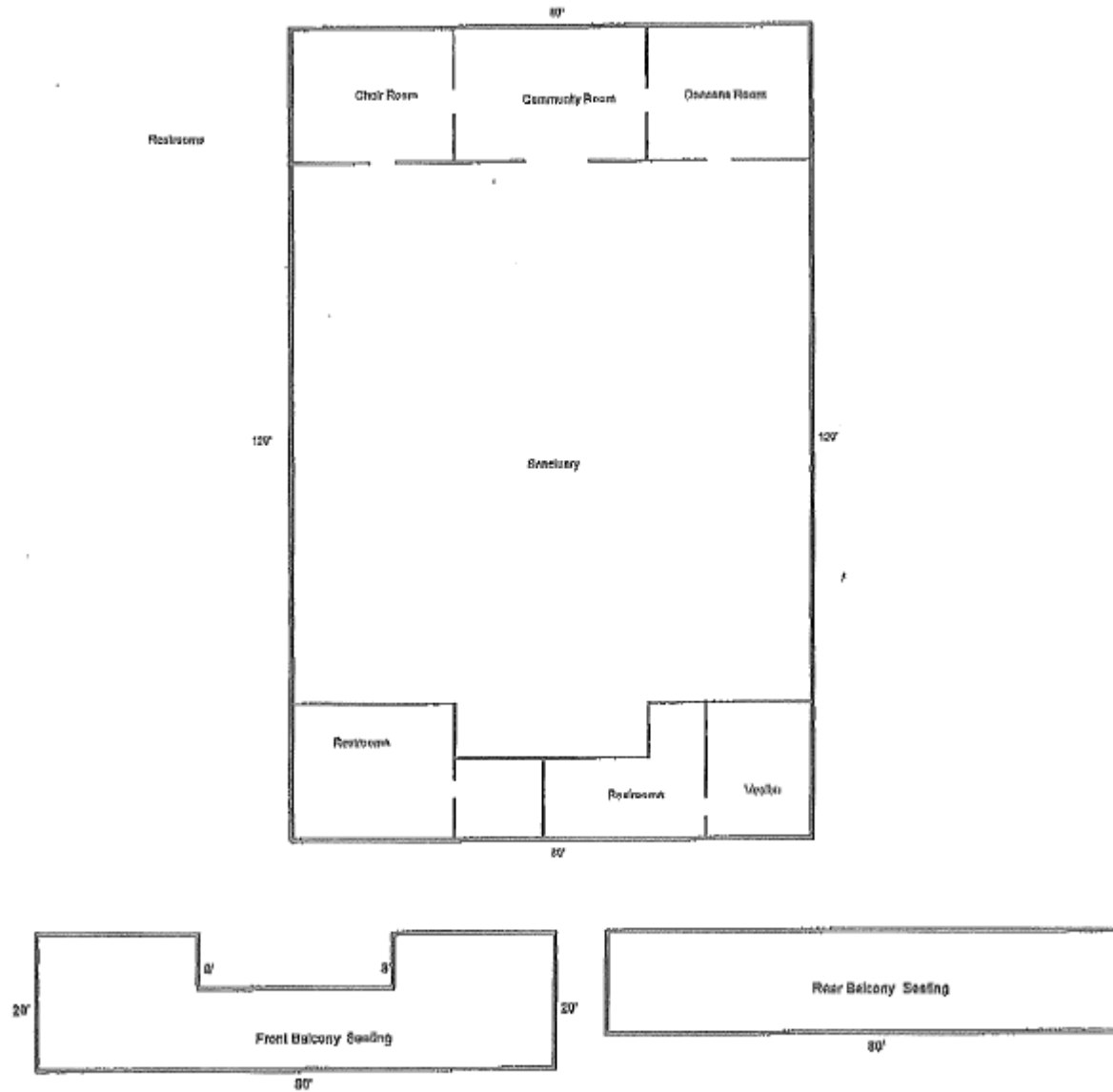

PROPERTY PHOTOS

