



**Space Information**  
The Officers' Mess, Duxford



**SPACE  
THAT  
WORKS**

# WHAT'S INCLUDED

---

## Fully equipped

Take the space you need and move straight in. Everything is ready for you, from the desks to the internet. The inclusive monthly price means you don't need to worry about utilities or business rates

---

## Dream team

Our talented team of professionals are on-site to ensure you always get the very best service.

---

## A great reception

We always provide a warm welcome. As well as looking after your guests, we take care of your post, parcels and printing

---

## Come and go

Access your private office any time you want, seven days a week, and enjoy free on-site parking

---

## Collaboration spaces

Choose from bookable meeting rooms, phone booths and communal spaces

---

## Take a break

As well as having a fully stocked kitchen, you can visit our friendly café for breakfast, lunch and snacks

---

## Shipshape

You can expect regular cleaning of your office space and communal areas. We handle Health & Safety and maintenance too

---

## Be part of a great community

Connect with like-minded members, by joining our networking events, socials and casual coffee breaks

---

## Access all areas

As a Mantle member you can work from any of our spaces. Find us in Cambridge, Chelmsford Oxfordshire, Stansted and Stevenage

---

# GROUND FLOOR



# FIRST FLOOR

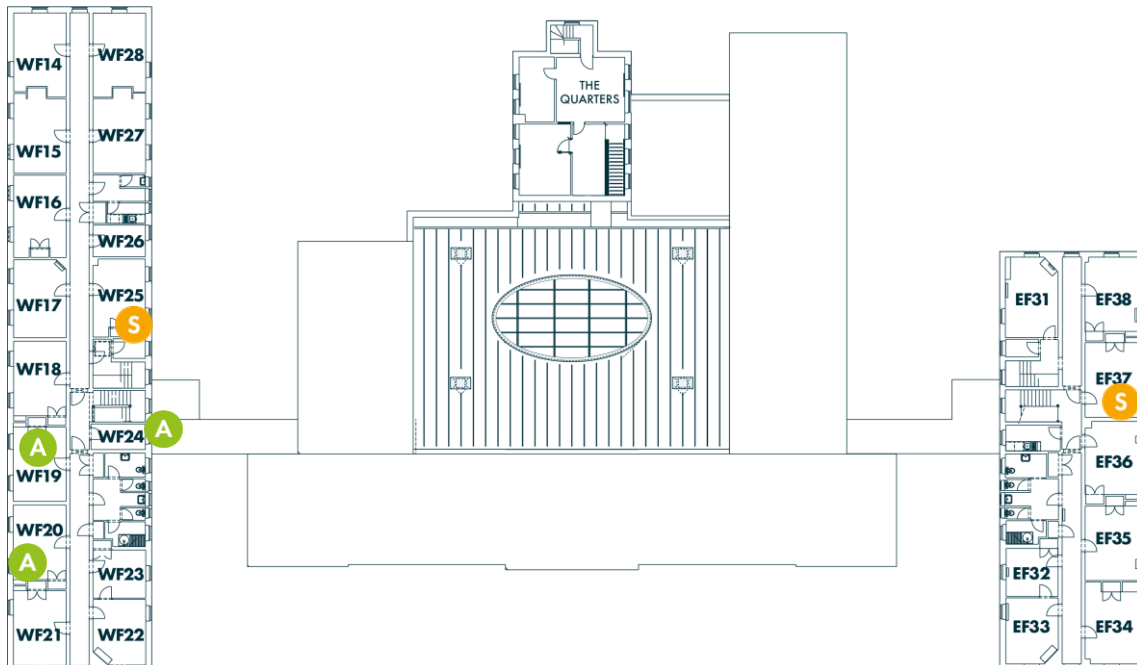

A Available    
 S Available soon    
 H Home-Flexi    
 M Meeting room

# THE FIGURES

## GROUND FLOOR (WEST)

Office	Size sq ft	Size sq m	No. of desks	Price from per month	Availability
WG1	212	19.7	4	LET	LET
WG2	216	20.1	4	LET	LET
WG3	212	19.7	4	LET	LET
WG5	212	19.7	4	POA	STC
WG6	212	19.7	4	LET	LET
WG7	212	19.7	4	LET	LET
WG8	212	19.7	4	LET	STC
WG9	171	16	3	LET	LET
WG10	137	12.9	2	LET	LET
WG11	216	20.1	4	LET	LET
WG12	216	20.1	4	Store	Store
WG13	213	19.8	4	LET	LET

## GROUND FLOOR (EAST)

Office	Size sq ft	Size sq m	Number of desks	Price from per month	Availability
EG47	197	18.3	4	LET	LET
EG48	201	18.7	4	LET	LET
EG49	180	16.7	4	LET	LET
EG50	138	12.8	2	LET	LET
EG51	137	12.9	2	POA	Available July 2026
EG52	171	15.9	3	LET	LET
EG53	171	15.9	3	LET	LET
EG54	100	9.3	2	LET	LET
EG55	69	6.4	1	POA	Available May 26

# THE FIGURES

## FIRST FLOOR (WEST)

Office	Size sq ft	Size sq m	Number of desks	Price from per month	Availability
WF14	212	19.7	4	LET	LET
WF15	216	20.1	4	LET	LET
WF16	221	20.5	4	LET	LET
WF17	207	19.3	4	LET	LET
WF18	212	19.7	4	LET	LET
WF19	212	19.7	4	POA	Available
WF20	212	19.7	4	POA	Available
WF21	212	19.7	4	LET	LET
WF22	171	16	3	LET	LET
WF23	138	12.9	2	LET	LET
WF24	72	6.7	1	POA	LET
WF25	200	18.6	4	POA	Available May 2026
WF26	86	8	1	LET	LET
WF27	216	20.1	4-6	LET	LET
WF28	213	19.8	4	LET	LET

## FIRST FLOOR (EAST)

Office	Size sq ft	Size sq m	Number of desks	Price from per month	Availability
EF31	208	19.4	4	LET	LET
EF32	137	12.9	2	LET	LET
EF33	172	16.0	3	POA	August 2026
EF34	219	20.4	5	LET	LET
EF35	213	19.8	4	LET	LET
EF36	207	19.3	4	LET	LET
EF37	207	19.3	4	POA	May 2026
EF38	212	19.7	4	LET	LET
The Ante Room	1345	125	40	LET	LET
The Billiard Room	518	48	15	POA	May 2026
The Card Room	463	43	12	LET	LET
The Quarters	465	43.2	6	LET	LET
The Breakout Room	297	27.6	6	POA	May 2026

# FLEXIBLE OPTIONS



## Home-Flexi For 1-8 people

### Home-Flexi 5

Work at any Mantle Space for 5 days per month

Use our small or medium meeting rooms for 2 hours per month

Business address

£160 + VAT per month (plus 1 month deposit)

### Home-Flexi 10

Work at any Mantle Space for 10 days per month

Use our small or medium meeting rooms for 4 hours per month

Business address

£210 + VAT per month (plus 1 month deposit)

### Home-Flexi 15

Work at any Mantle Space for 15 days per month

Use our small or medium meeting rooms for 6 hours per month

Business address

£260 + VAT per month (plus 1 month deposit)



## Virtual For any business size

### Business address

Professional address and post handling

£65 + VAT per month (plus 1 month deposit)

### Call answering

We answer your calls in your company name

£90 + VAT per month (plus 1 month deposit)

### Full virtual office

A package of our business address and call answering services

£125 + VAT per month (plus 1 month deposit)



# GET IN TOUCH

Call 01235 617300

Mail [tom@mantlespace.co.uk](mailto:tom@mantlespace.co.uk)

Mantle Space Ltd The Officers' Mess, Royston Road, Duxford, CB22 4QH

[mantlespace.co.uk](http://mantlespace.co.uk)

Twitter @mantlespace

Facebook @mantlespace

Instagram @mantlespace