

19 Berkeley Street, London W1

High Quality Fitted Office To Let

Part 4th Floor—973 sq ft (90.39 m²)



- High quality fit out
- Raised floor
- Suspended ceiling
- Air conditioning
- Fibre
- Fitted kitchenette
- Commissionaire
- 2 x Passenger lift
- Furniture available by separate arrangement

19 Berkeley Street, London W1

Location

The property is located on the east side of Berkeley Street, close to the junction with Hay Hill. Green Park (Jubilee, Victoria and Piccadilly lines) and Piccadilly Circus (Bakerloo and Piccadilly lines) underground stations are a short walk away. There are also numerous bus routes running along Piccadilly.

Description

The available accommodation is accessed by way of a manned reception with two passenger lifts which serve all floors. The suite benefits from a high quality, nearly-new fit out which provides a reception area, boardroom to seat 6, 3 private offices, open plan for 6 and fitted kitchenette.

Furniture is available by separate arrangement.

Lease

Available by either:

A sublease to March 2021, outside the Landlord and Tenant Act.

An assignment to March 2023, outside the Landlord and Tenant Act.

Rent

The passing rent is £70.50 per sq ft

Rates

£32.31 per sq ft (2019/20)

Service Charge

Capped at £13.00 per sq ft

EPC

TBC

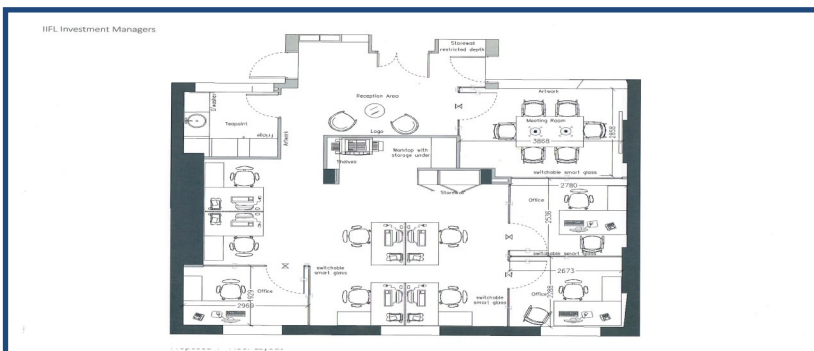

For further information or to arrange a viewing, please contact the sole agents:

Crossland Otter Hunt
020 7408 1114

Jess Petrie
jessica@coh.eu

08/19

020 7408 1114 www.coh.eu