

FOR LEASE

# 2567 E. WINDMILL PKWY.

HENDERSON, NV 89074

RETAIL

2ND GEN MEDICAL OFFICE SPACE AVAILABLE ADJACENT SHERWIN WILLIAMS



FOR LEASE

# 2567 E. WINDMILL PKWY.

LOCATED E/SEC OF WINDMILL PKWY. & PECOS RD.

RETAIL



## PROPERTY INFO

Located in the heart of Green Valley with a Henderson address. Space is located on the west end cap of a free standing pad building, adjacent to Sherwin Williams store, open since 1999. Strong daytime and weekend traffic in a dense mature neighborhood and professional office community.

## HIGHLIGHTS

- + Ideal for a Retail, Office or Medical Office user
- + (1) mile demographics: Population - over 22,000
- + Fully improved physical therapy space with indoor pool
- + West end cap with **three** sides of building for signage
- + **Pylon signage available for Tenant's use - fronting Windmill Pkwy.**
- + Two tenant pad building - adjacent to Sherwin Williams store
- + Excellent parking, visibility and signage



INDOOR  
POOL



## LEASE INFO

SUITE B	±3,000 SF
former physical therapy space	<i>call Broker to schedule tour</i>
LEASE RATE	\$1.75 - \$2.00 PSF
LEASE TYPE	NNN
2017 EST. CAMS	\$0.40 PSF
ZONING	Henderson, Community Commercial (CC)

FOR LEASE

# 2567 E. WINDMILL PKWY.

LOCATED E/SEC OF WINDMILL PKWY. & PECOS RD.

RETAIL

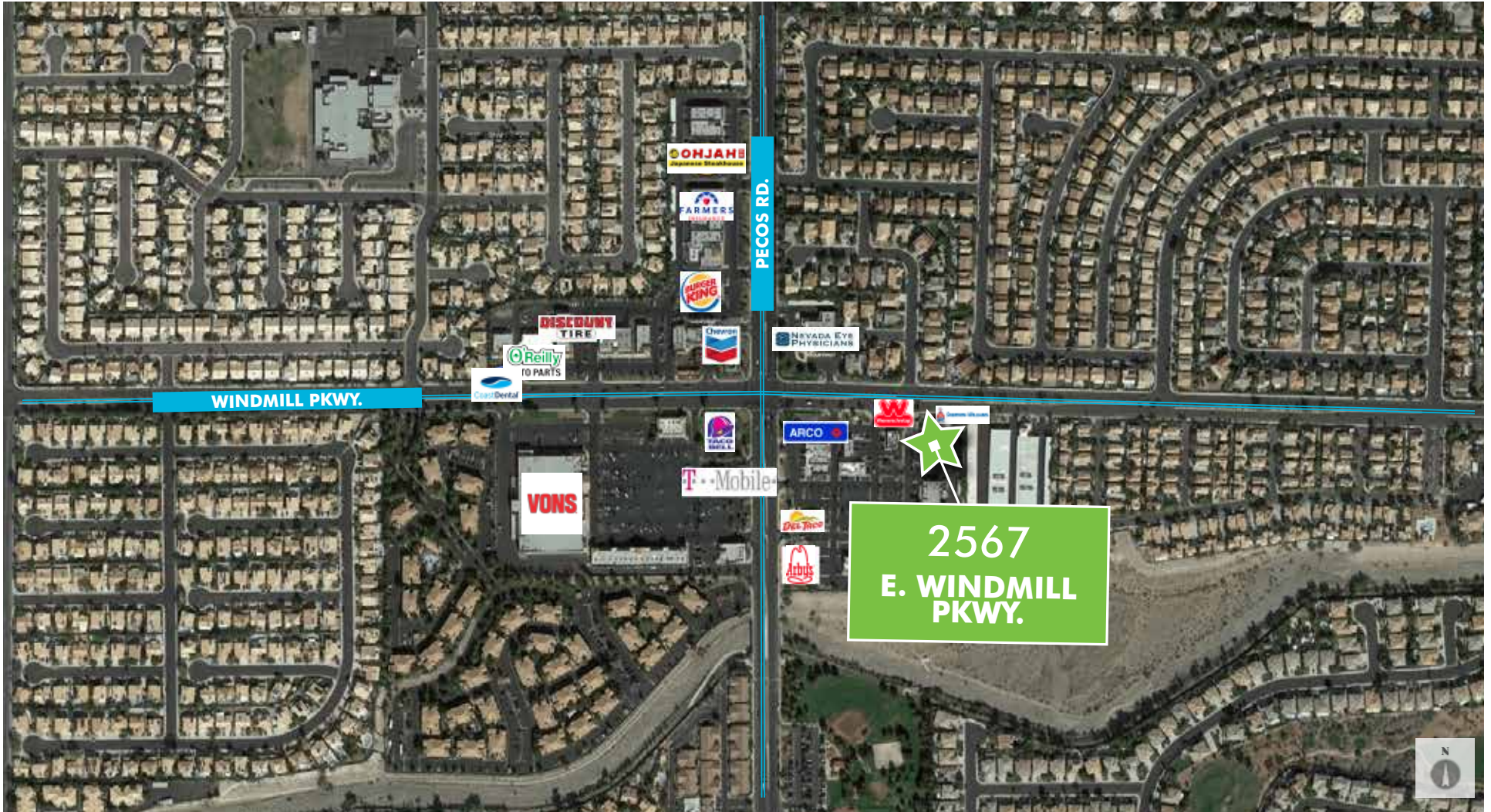

FOR LEASE

# 2567 E. WINDMILL PKWY.

LOCATED E/SEC OF WINDMILL PKWY. & PECOS RD.

RETAIL

## 2017 Estimated Demographics

	1-Mile	3-Mile	5-Mile
Population	23,232	152,792	357,542
Median HH Income	\$64,467	\$60,526	\$55,464

## 2016 Traffic Counts

Pecos Rd. S of Pebble Rd.	27,000
Windmill Ln. E of Eastern Ave.	18,000



## CONTACT US

### Penny Mendlovic

Vice President  
+1 702 369 4932  
penny.mendlovic@cbre.com  
Lic. 39894

### Alexandria Keser

Client Services Specialist  
+1 702 369 4808  
alex.keser@cbre.com  
Lic. 0178186

### CBRE - Las Vegas

3993 Howard Hughes Pkwy., Ste. 700  
Las Vegas, NV 89169  
+1 702 369 4800  
www.cbre.com/lasvegas

© 2017 CBRE, Inc. The information contained in this document has been obtained from sources believed reliable. While CBRE, Inc. does not doubt its accuracy, CBRE, Inc. has not verified it and makes no guarantee, warranty or representation about it. It is your responsibility to independently confirm its accuracy and completeness. Any projections, opinions, assumptions or estimates used are for example only and do not represent the current or future performance of the property. The value of this transaction to you depends on tax and other factors which should be evaluated by your tax, financial and legal advisors. You and your advisors should conduct a careful, independent investigation of the property to determine to your satisfaction the suitability of the property for your needs. Photos herein are the property of their respective owners and use of these images without the express written consent of the owner is prohibited. CBRE and the CBRE logo are service marks of CBRE, Inc. and/or its affiliated or related companies in the United States and other countries. All other marks displayed on this document are the property of their respective owners.