

9101 DIXIE HWY

Mailing Address 1929 MAJESTIC MEADOWS
DR, CLARKSVILLE, IN 47129-
9076

Owner JOHN H HICKS JR
REVOCABLE TRUST & AN

Parcel ID 104800010000

Land Value \$450,500

Improvements Value \$20,000

Assessed Value \$470,500

Approximate Acreage 43.3469

Property Class 101 AGRICULTURAL
W/DWELLING

Deed Book/Page **7808 0705**

District Number 500009

Old District 24

Fire District Pleasure Ridge Park

School District Jefferson County

Neighborhood 508142 / TIMOTHY HILLS

Satellite City **Jefferson County**

Sheriff's Tax Info **View Tax Information**

County Clerk **Delinquent Taxes** [↗](#)



Details & Photos



SINGLE FAMILY



Property Details

Use Description	SINGLE FAMILY
Year Built	1900
Basement Area	525 sq. ft.
Basement Finished?	No
Construction Frame	Wood frame
Stories	2.00
Above Grade Sq Ft.	4,477 sq. ft.

Photos



Property Sketch

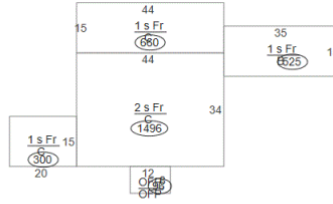

Sales History

Deed Book/Page	Price	Date	Previous Owner
7808 0705	\$200,770	12/31/2001	HICKS JOHN H JR
4736 0229 (N/A Online)	\$0	01/01/1974	OWNER UNKNOWN

Assessment History

Record Year	Land	Improvements	Total	Reason
2017	\$450,500	\$20,000	\$470,500	RC - Residential Computer Reassessment
2012	\$372,390	\$18,320	\$390,710	C - Chang in Use / Class Change
2009	\$372,390	\$18,320	\$390,710	LB - Local Board Ruling
2007	\$289,320	\$122,120	\$411,440	RC - Residential Computer Reassessment
2003	\$289,320	\$111,020	\$400,340	19 - Characteristics

Legal Lines

LN	Legal Description
1	TRACT 2 - RESIDUAL PER MINOR PLAT DB. 9063 X 55 42.83 AC +/-

Property is assessed per KRS 132.20 on January 1st of each year. The current year assessments are updated and posted on the website in mid April. Information deemed reliable but not guaranteed. Data last updated: 01/09/2019.