

PHARMACY PLAN
SCALE: 3/16" = 1'-0"

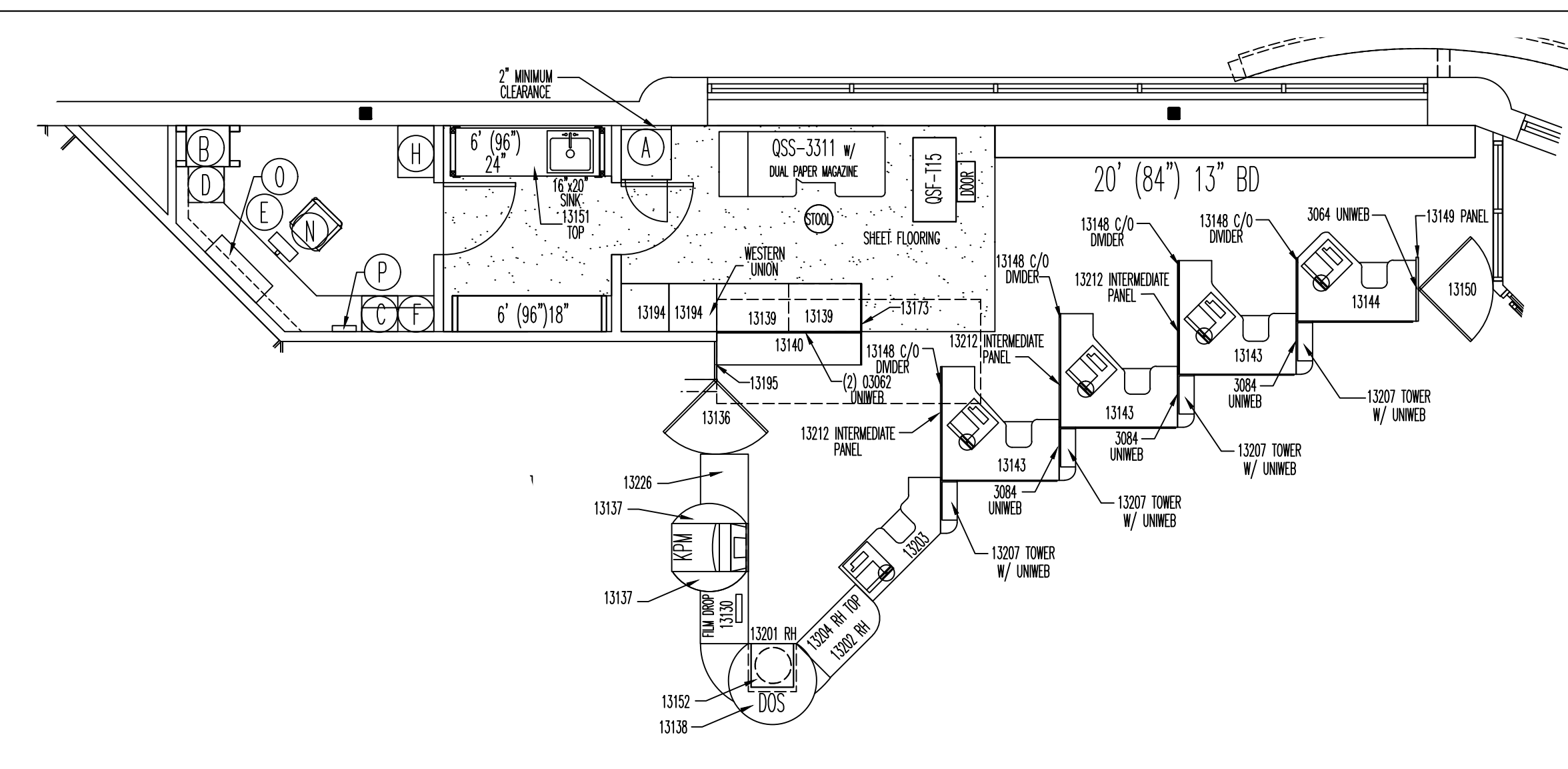

FRONT END PLAN
SCALE: 3/16" = 1'-0"

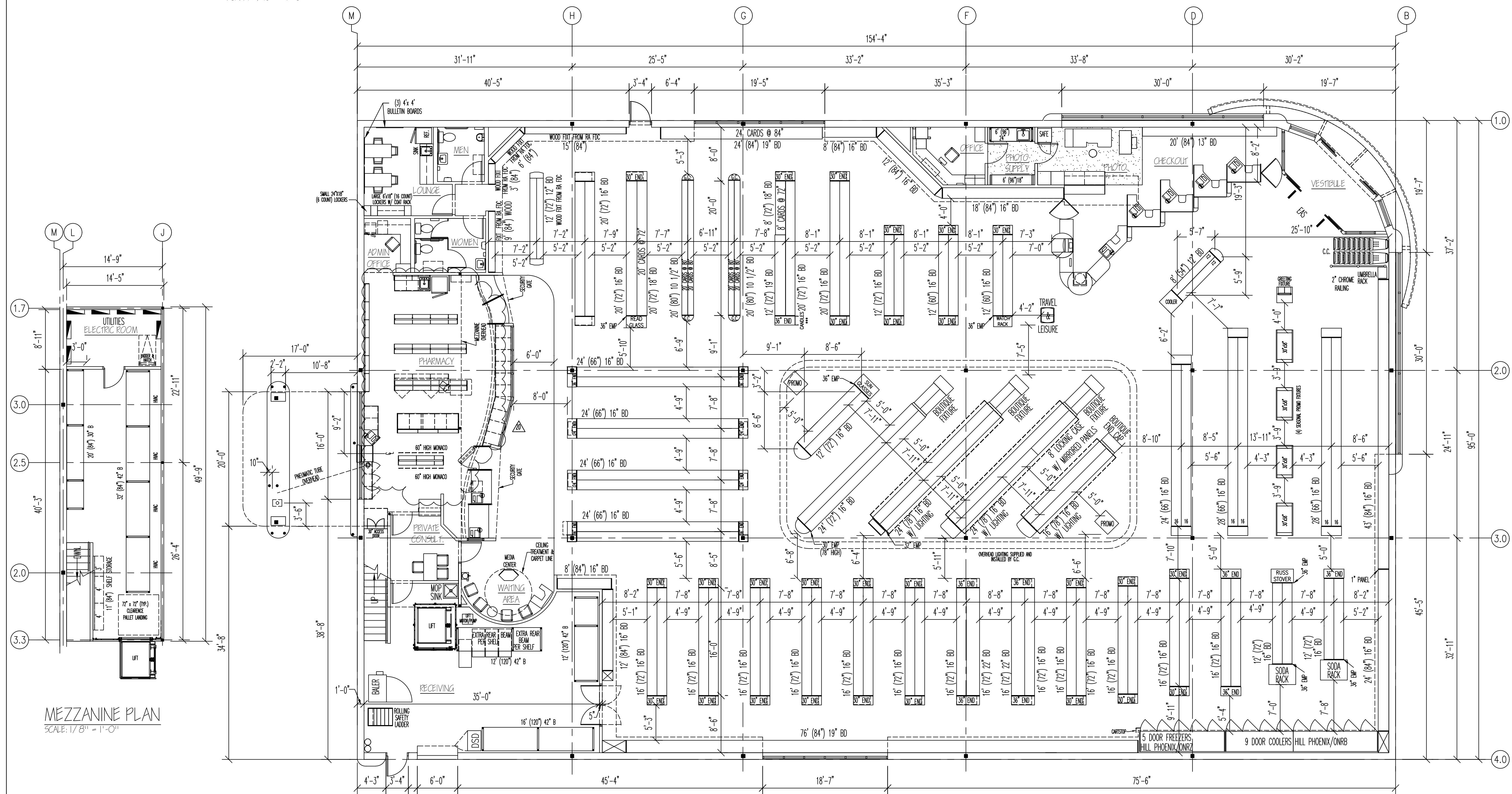

MEZZANINE PLAN
SCALE: 1/8" = 1'-0"

FIXTURE PLAN
SCALE: 1/8" = 1'-0"

"CUSTOMER WORLD"
COLOR SCHEME

CONSTRUCTION NOTES



STORE PLANNING
DEPARTMENT
P.O. BOX 3165
HARRISBURG, PA 17105
(717) 761-2633

STORE #
4915 RELO

RITE AID PHARMACY

STATE LINE RT 54
DELMAR, MD

DRAWING STATUS

- DESIGN PHASE
- CONSTRUCTION PHASE
- FIELD VERIFIED
- REVISION

PROJECT TYPE

- NEW STORE
- GENERAL RESET
- EXPANSION
- MINOR RENOVEL
- RENOVEL
- SPEC. PROJECT
- RELOCATION
- R. RENOVEL

PROJECT ATTRIBUTES

- HOUR PHOTO
- HAND D/P
- DRIVE-THRU
- LIQUOR
- G.N.C.

BUILDING AREA (SQ. FT.)

	EXISTING	NEW
SALES FLOOR:		11800
PHARMACY:		849
WAITING AREA:		137
RECEIVING STORAGE:		850
LOUNGE:		149
CONSULTATION RM.:		97
SPECIAL:		-0-
MEZZANINE:		661
RESTROOMS:		192
SUB TENANT:		-0-
RITE AID TOTAL:		14074
OVERALL TOTAL:		14564

FIXTURES (LINEAL FEET)

SALES FLOOR: SHELVING	1590
UNIBED	-0-
TOTAL	1590
RECEIVING STORAGE:	-0-
TOTAL:	1590

MERCHANDISING (LINEAL FT)

QUADRANT 1:	-0-
QUADRANT 2:	-0-
QUADRANT 3:	-0-
TOTAL:	-0-

DIRECTOR OF CONSTRUCTION

JIM MCWILLIAMS

REGIONAL CONSTRUCTION MANAGER

TODD SCHIVELY

DRAWN BY: SLB DATE: 12/6/04

CHECKED BY: JHY SCALE: AS NOTED

STORE #
4915 RELO

APPROVED BY REEC
DATE: DECEMBER 14, 2004

MGR & RX - ADMIN. OFFICE KEY NOTES

- A) SAFE
- B) COMPUTER EQUIPMENT RACK
- C) FILING CABINET
- D) PRINTER W/ FILING CABINET BELOW
- E) KEYBOARD TRAY
- F) SHELF FROM COUNTER TO 7'-0" HIGH
- G) INSTALL 12" HIGH KICKBASE BELOW COUNTER
- H) 4 DRAWER METAL FILING CABINET
- J) 7 DRAWER RX FILING CABINET
- K) CPU/MONITOR/KEYBOARD ON COUNTER-TOP
- L) UNDER COUNTER 2 DRAWER CABINET
- M) UNDER-COUNTER REF. 19" X 19"
- N) DESK CHAIR
- O) SECURITY SHELF
- P) LOCK BOX
- Q) RX OFFICE BOOKCASE ABOVE COUNTER

CEILING HEIGHT = 13'-6" / 15'-6" (OVER COSMOS)

REVISIONS

NO.	DATE	BY	DESCRIPTION
1	NOVEMBER 29, 2005	GCY	UPDATED COSMETIC ENDS TO REFLECT PROTOTYPE STANDARDS. 15" BASES ADDED TO BACK BAR AND 8" (84" GONDOLA WIDE 12"). 19" BASES ON WALL AND ON PARTY/CANDLE GONDOLA WIDE 18". RELOCATED THE WIRE BASE ASSE (CHROMA DEPT.) ONE ASSE TO RX. RELOCATED THE 36" END CARS BACK ALSO. REPLACED THE 18" (22") WOOD END FIXTURE WITH A 24" (22") 18" GONDOLA WITH 30" ENDS. PER MERCH (CHANGED BACK TO OLD DRAWING STANDARDS SINCE MERCH HAD MERCHANDISED OLDER DRAWING)
2	DECEMBER 22, 2005	GCY	UPDATED DRAWING TO CURRENT STANDARDS. CALLED OUT 3" SECTIONS IN SHELVING WITH A LINE AND A SLASH THROUGH THE AREA WHERE THE 3" SECTIONS WILL BE PLACED, INCREASED WIDTH OF REF. FROM 28" TO 30" AND ADDED TEXT UNDER LOCKED CASE W/ MIRRORED PANELS. INCREASED HGT. OF COSMETIC EMP FROM 72" TO 78". REMOVED DOORWAY IN CONSULTATION ROOM UNDER MEZZANINE STAIRWAY PER REZ UPDATED HGT. OF COSMETIC ENDS PER MERCH. ADDED LOCKING DIMENSIONS TO COSMETIC GONDOLA WITH SUNGLASSES ENDCAP AND TO CUEING FIXTURE WITH COOLER. UPDATED DRAWING TO FIELD VERIFIED SPECIFICATIONS PER ROOM. RESEARCH COMPLETE, FULL DISTRIBUTION
3	JANUARY 06, 2005	SLB	CHANGED LOCATION OF 8' QUEUING GONDOLA & COOLER, AND RELOCATED SEASONAL GONDOLAS.
4	FEBRUARY 06, 2006	GCY	ADDED FULL STATION. RELOCATED RX SHELVING AS NEEDED.