



47
EAST
29th
STREET

BUILDING FOR SALE





47 E 29TH STREET

Positioned in the heart of NoMad just off Park Avenue South, 47 East 29th Street presents a rare opportunity to acquire a fully built, single-occupancy hospitality asset centered in the thriving Park Avenue South Corridor. Currently operating as Tavern 29, the property is ideally suited for an owner/operator, restaurant group, or experiential hospitality brand seeking to reposition an established venue with substantial existing infrastructure.

The building consists of approximately 6,950 rentable square feet across multiple levels, including a ground-floor bar and dining room, second-floor lounge, and roof terrace. The property is fully vented and delivered with an operational commercial kitchen, substantial prep and storage areas, and three walk-in refrigerators. The existing certificate of occupancy permits up to 208 patrons, creating exceptional flexibility for restaurant, bar, private events, or branded hospitality concepts.

The surrounding neighborhood continues to experience significant growth driven by nearby luxury residential and hotel development, including The Royalton Park Avenue Hotel, The Ritz-Carlton NoMad, Virgin Hotels New York City, The Fifth Avenue Hotel, and the Ace Hotel. This dynamic live-work-play environment has transformed NoMad into one of Manhattan's most desirable hospitality destinations and benefits from a constant mix of affluent residents, office users, tourists, and nightlife traffic.

47 East 29th Street offers a turnkey foundation with significant replacement-cost value already embedded in the asset. The combination of existing infrastructure, rooftop amenities, multi-level guest experience, and prime NoMad positioning creates a compelling opportunity for an operator or investor to capitalize on one of New York City's strongest hospitality submarkets. The property's efficient layout provides the framework for a flagship concept with immediate operational capability and long-term upside potential.



PROPERTY DETAILS:

**47 E 29th Street
New York, NY 10016**

LOCATED ON THE NORTH SIDE OF 29th Street
AND OFF THE CORNER OF PARK AVENUE SOUTH
NOMAD

BLOCK / LOT: 0859-0036

LOT DIMENSIONS: 20' X 98'

LOT SQUARE FOOTAGE: 1,975 SQFT

BUILDING DIMENSIONS: 20' X 98'

BUILDING AREA: 3,790 SQFT

BASEMENT: 1,263 SQFT

TYPICAL FLOOR AREA: 1,895 SQFT

ROOF TERRACE: 1,895 SQFT

TOTAL RENTABLE AREA: 6,950 RSF

STORIES: 2

FLOORS: 4

ZONING: C64A

LEGAL USE: RESTAURANT / BAR

TRADE FIXTURES: FULLY EQUIPPED F&B

CURRENT MAX BUILDING OCCUPANCY: 208

REAL ESTATE TAXES (2026/27): \$106,861

ASKING PRICE: \$4,575,000

Please contact the broker to discuss and arrange tour.

Note: All square feet measurements are approximate





FLOOR PLANS 47 East 29th Street

BASEMENT



GROUND FLOOR



SECOND FLOOR



ROOF TERRACE

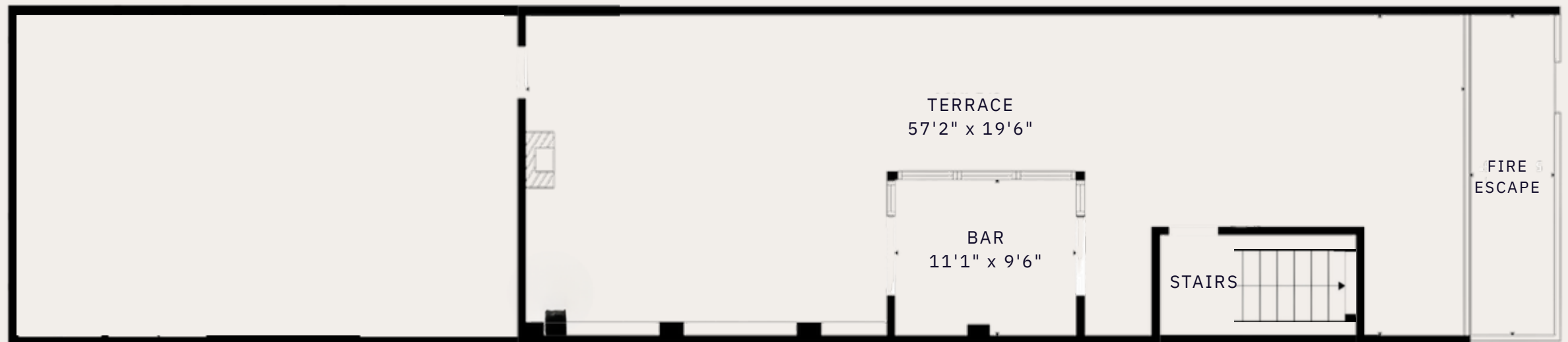

Note: All measurements are approximate



Louis Puopolo

Lic. Assoc. R.E. Broker

(O) 212.776.4367

(M) 917.374.0099

louis.puopolo@elliman.com



Paul Ramirez

Lic. Assoc. R. E. Broker

(O) 212.965.6000

(M) 917.608.6202

paul.ramirez@elliman.com



Alex Furst

Lic. Assoc. R.E. Broker

(O) 212.303.5260

(M) 347.281.3165

alexander.furst@elliman.com



Kristin Irwin

Lic. R. E. Salesperson

(O) 212.303.5273

(M) 336.420.1993

kristin.irwin@elliman.com

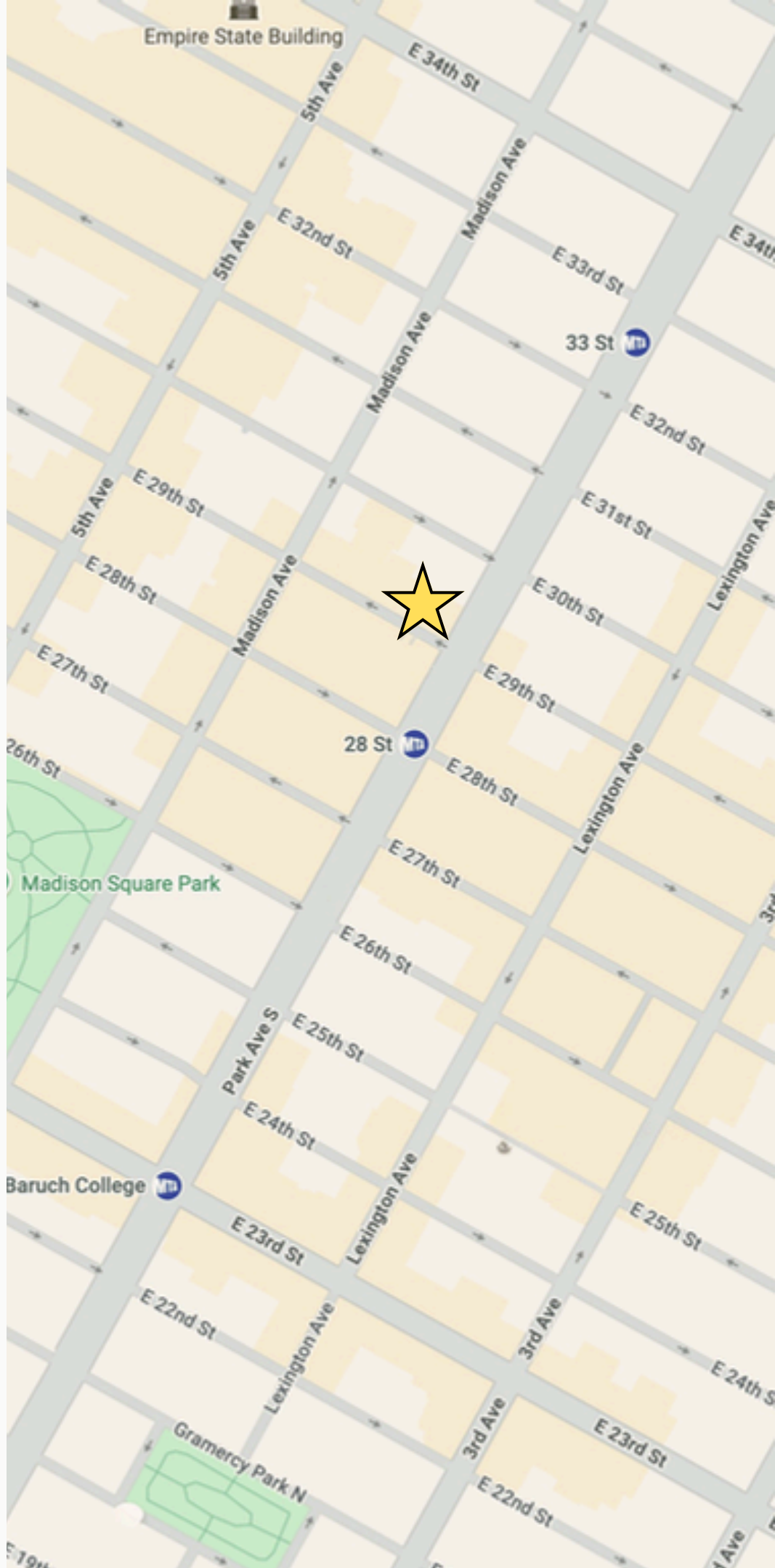

 **Douglas Elliman**
Commercial

575 MADISON AVENUE, NY, NY 10022, 212.891.7000 © 2023 DOUGLAS ELLIMAN REAL ESTATE. ALL MATERIAL PRESENTED HEREIN IS INTENDED FOR INFORMATION PURPOSES ONLY. WHILE THIS INFORMATION IS BELIEVED TO BE CORRECT, IT IS REPRESENTED SUBJECT TO ERRORS, OMISSIONS, CHANGES OR WITHDRAWAL WITHOUT NOTICE. ALL PROPERTY INFORMATION, INCLUDING, BUT NOT LIMITED TO SQUARE FOOTAGE, ROOM COUNT, NUMBER OF BEDROOMS AND THE SCHOOL DISTRICT IN PROPERTY LISTINGS SHOULD BE VERIFIED BY YOUR OWN ATTORNEY, ARCHITECT OR ZONING EXPERT. EQUAL HOUSING OPPORTUNITY.