

# SUNSET CORNERS OUTPARCEL

4005 SUNSET ROAD, CHARLOTTE, NC 28216

FOOD LION  
NEIGHBORHOOD  
CENTER

**NS** New South  
Properties  
NEWSOUTHPROP.COM

+/- 0.73 ACRE CORNER PARCEL AVAILABLE FOR GROUND LEASE OR BUILD TO SUIT

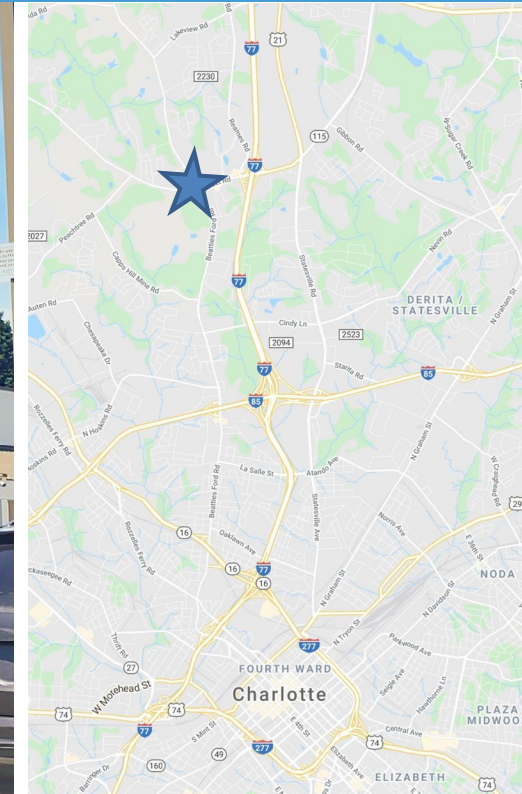

## PROPERTY INFORMATION

- Located at the corner of Sunset Road and Beatties Ford Road (undergoing road widening)
- Food Lion anchored shopping center
- Renovations taking place
- Ample parking
- +/- 0.73 Acre corner outparcel available

## DEMOGRAPHICS



POPULATION

1 Mile: 4,828  
3 Miles: 54,823  
5 Miles: 155,446



AVG. HH INCOME

1 Mile: \$62,495  
3 Miles: \$64,044  
5 Miles: \$65,944



DAYTIME EMPLOYEES

1 Mile: 3,744  
3 Miles: 43,393  
5 Miles: 115,448

## BROKER CONTACT

**WILL WHITLEY**  
704.927.2888  
wwhitley@newsouthprop.com



"The information contained herein was obtained from sources believed reliable, however, no guarantees, warranties, or representations have been made as to the completeness or accuracy thereof. No liability assumed for error or omissions."

# SUNSET CORNERS OUTPARCEL

4005 SUNSET ROAD, CHARLOTTE, NC 28216

AERIAL

**NS** New South Properties  
NEWSOUTHPROP.COM

+/- 0.73 ACRE CORNER PARCEL AVAILABLE FOR GROUND LEASE OR BUILD TO SUIT

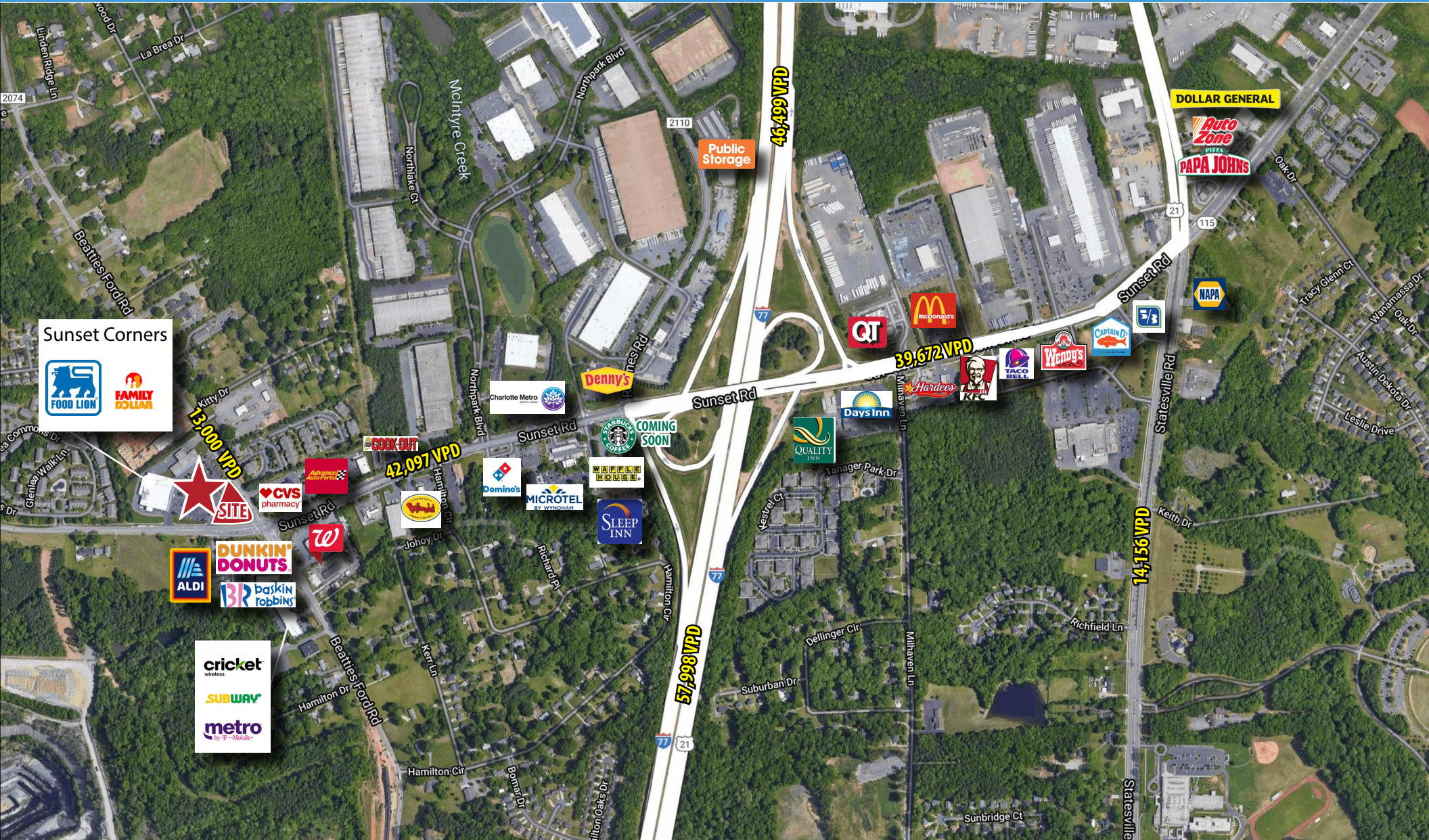

"The information contained herein was obtained from sources believed reliable, however, no guarantees, warranties, or representations have been made as to the completeness or accuracy thereof. No liability assumed for error or omissions."



WILL WHITLEY | 704.927.2888 | [wwhitley@newsouthprop.com](mailto:wwhitley@newsouthprop.com)

# SUNSET CORNERS OUTPARCEL

4005 SUNSET ROAD, CHARLOTTE, NC 28216

SITE PLAN

+/- 0.73 ACRE CORNER PARCEL AVAILABLE FOR GROUND LEASE OR BUILD TO SUIT

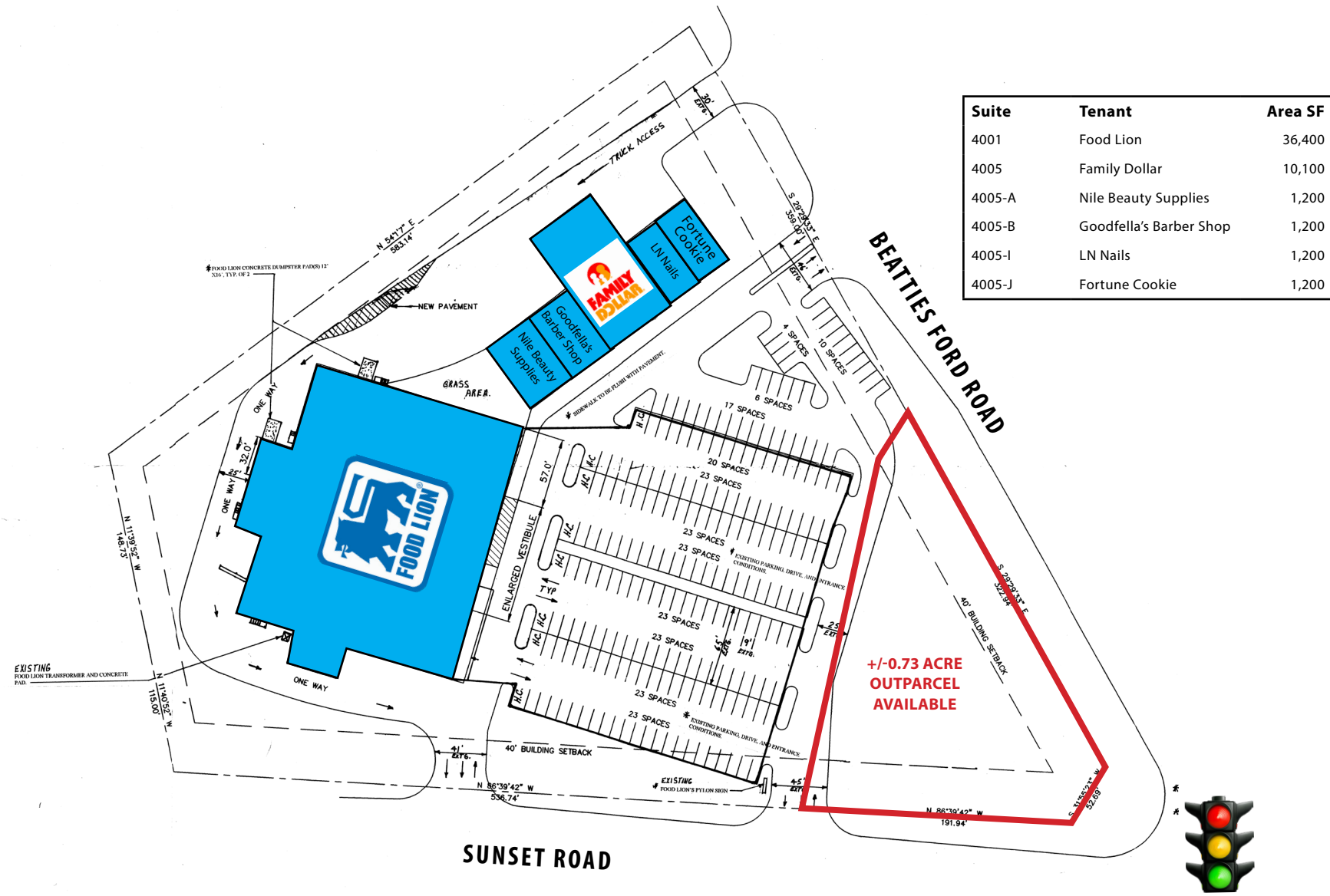

Suite	Tenant	Area SF
4001	Food Lion	36,400
4005	Family Dollar	10,100
4005-A	Nile Beauty Supplies	1,200
4005-B	Goodfella's Barber Shop	1,200
4005-I	LN Nails	1,200
4005-J	Fortune Cookie	1,200

"The information contained herein was obtained from sources believed reliable, however, no guarantees, warranties, or representations have been made as to the completeness or accuracy thereof. No liability assumed for error or omissions."



WILL WHITLEY | 704.927.2888 | [wwhitley@newsouthprop.com](mailto:wwhitley@newsouthprop.com)

