

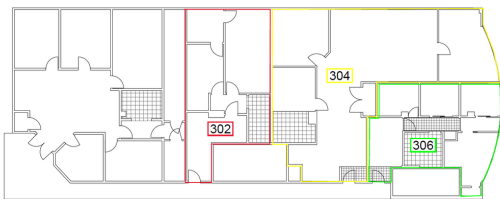

FOR LEASE
\$1.25/sf/mo
Base Rent

Kevin Nishikawa
RB-17304
(808) 220-9220
kevin@marcushawaii.com



ABOUT

The Hawaii Dental Association Building is conveniently located between Piikoi and Keeaumoku. This low traffic/density building with secured and covered parking allows easy access to tenants. Tenants have 24/7 access to the building, with A/C hours Mon-Fri 7am-6pm, but can be modified to tenants needs. Electricity, HVAC, trash and janitorial services are included in the monthly Operating Expenses, and there are separate restrooms for Men's, Women's, and Family.

AVAILABLE UNITS

- Suite 302 (896sf) - Reception, open room, large conference room, one private office. Sink in unit.
- Suite 304 (1,669sf) - Large reception area, large open area, 4 private offices. Sink in unit.
- Suite 306 (769sf) - Reception, 4 patient rooms, large private office. Sink in unit.

DETAILS

- Base Rent: \$1.25/sf/mo
- Operating Exp: \$1.34/sf/mo
- Parking: 1 stall/370sf
 - Rate: \$125/stall/mo
- 6 free guest stalls
 - Mon-Sat 7am-7pm
- Zoning - BMX-3
- TMK: 1-2-4-004-058

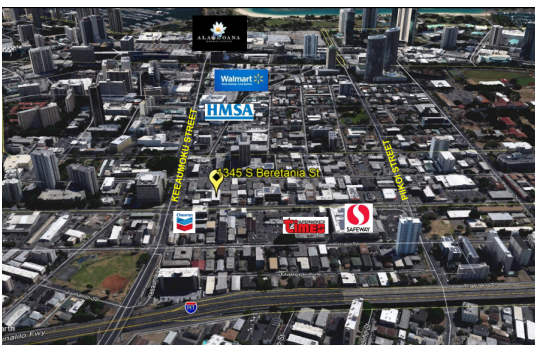

Learn more at marcushawaii.com

Listor & Listor's brokerage make no guarantees on any information contained herein.



FOR LEASE
\$1.25/sf/mo
Base Rent

Kevin Nishikawa
RB-17304
(808) 220-9220
kevin@marcushawaii.com





FOR LEASE
\$1.50/sf/mo
 Base Rent

Alexander Yen
RS-81293
 (808) 392-6475
 alexandery@marcushawaii.com



ABOUT

The Hawaii Dental Association Building is conveniently located between Piikoi and Keeaumoku. This low traffic/density building with secured and covered parking allows easy access to tenants. Tenants have 24/7 access to the building, with A/C hours Mon-Fri 7am-6pm, but can be modified to tenants needs. Electricity, HVAC, trash and janitorial services are included in the monthly Operating Expenses, and there are separate restrooms for Men's, Women's, and Family.



SUITE 101

- Ground floor unit with street frontage along S Beretania St.
- Currently built out for medical user, but many other potential uses.
- 1,498 square feet with multiple private rooms, private bathroom, kitchenette, and reception area.

DETAILS

- Base Rent: \$1.50/sf/mo
- Operating Exp: \$1.34/sf/mo
- Parking: 1 stall/370sf
 - Rate: \$125/stall/mo
- 6 free guest stalls
 - Mon-Sat 7am-7pm
- Zoning - BMX-3
- TMK: 1-2-4-004-058

1345 S BERETANIA ST
Honolulu, HI 96814
GROUND FLOOR
OFFICE SPACE AVAILABLE



FOR LEASE
\$1.50/sf/mo
Base Rent

Alexander Yen
RS-81293
(808) 392-6475
alexandery@marcushawaii.com

