



Rare Johnson County IND/FLEX Building

- +/-6,750 SF on +/-0.49 Acres
- Free-Standing, Clear Span Warehouse Building
- New Roof Installed in 2025
- Excellent Owner/User Opportunity
- Call For Sale Price/Lease Rate

For more information:

Christian Wead
816.412.8472
cwead@blockllc.com

The information contained in this marketing flyer is presented as general information only. Block Real Estate Services, LLC makes no representation as to its accuracy. This information is not intended as legal, financial or real estate advice and must not be relied upon as such. You should make your own inquiries, obtain independent inspections, and seek professional advice tailored to your specific circumstances before making any legal, financial or real estate decisions.

Building Specifications

Building Size:	+/- 6,750 SF
Lot Size:	+/- 0.49 AC
Year Built:	1985
Zoning:	M-2, General Industrial District
Roof:	New 60 Mill TPO Roof Installed 2025
HVAC:	New Office HVAC Unit, Warehouse HVAC Systems
Loading:	Three 10'x12' Drive-In Doors
Clear Height:	13', Clear Span Warehouse, 14' Clear at the Peak
Warehouse Office:	Separate Man Door Access, Restroom and Break Room
Amenities:	+/-5,250 SF Climate Controlled Warehouse, Paint Booth, Work Room
Operating Expenses (2026 Est.):	RE TAXES & INS: \$2.75 PSF CAM: Self-Performed By Tenant

For more information:

Christian Wead
816.412.8472
cwead@blockllc.com

Property Photos



2010 East Spruce Circle

Olathe, Kansas 66062

For Lease/Sale

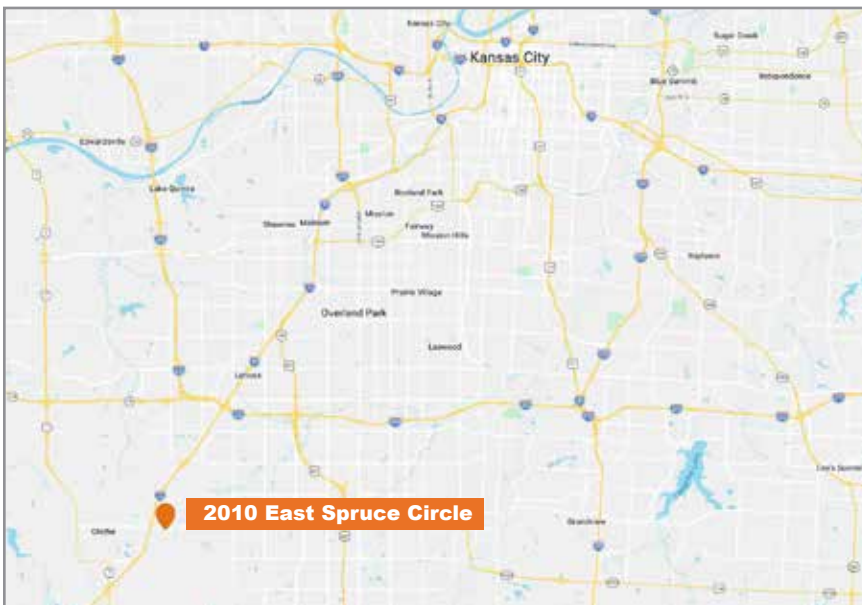

For more information:

Christian Wead

816.412.8472

cwead@blockllc.com