

FOR LEASE

URBAN
WORKS

**CLOSE-IN
SOUTH EAST**
SPACE | 3,631 SF



RETAIL



CREATIVE



OFFICE

2410 SE 11TH
CORNER SHOWROOM / OFFICE SPACE

CHARLOTTE LARSON | 503.228.3080
WWW.URBANWORKSREALESTATE.COM

2410 SE 11TH



ADDRESS | 2410 SE 11TH AVE
USES | RETAIL / OFFICE

SPACE | 3,631 SF
AVAILABLE | NOW

AREA | LOWER DIVISION

ABOUT THE SPACE

- Stunning turn-key showroom space with office, warehouse and grade roll up door for loading.
- Features kitchenette, two ADA bathrooms, tall ceilings and beautiful corner window line.
- Rare off street parking amenity.
- Available now!



INTERIOR

FLOOR PLAN / SITE PLAN

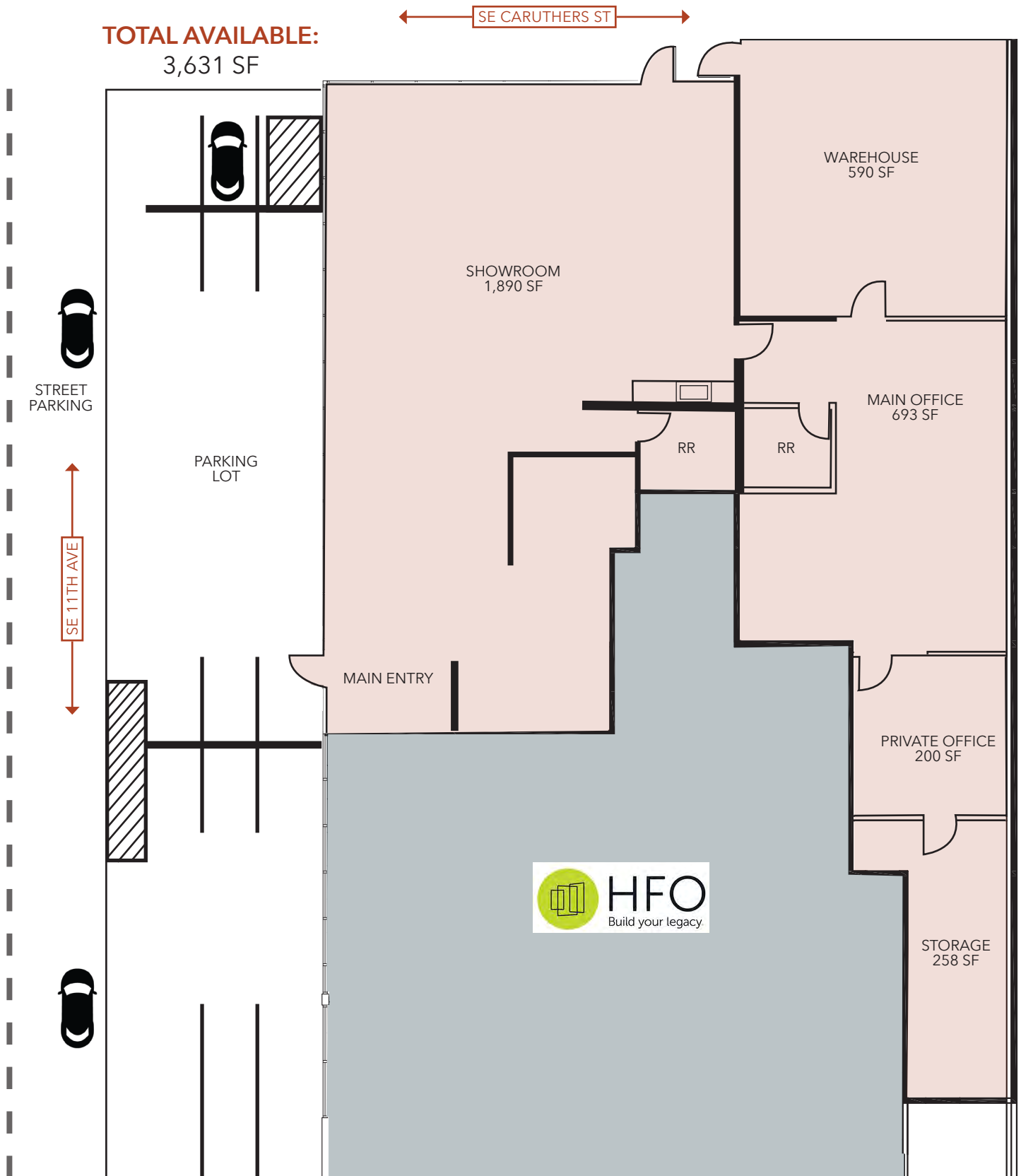

AREA RETAIL & DEMOS



	.25 MILES	.5 MILES	1 MILE
2018 POPULATION	971	3,910	20,435
TOTAL EMPLOYEES	2,104	7,035	27,294
TOTAL BUSINESSES	238	831	2,666
MEDIAN HH INCOME	\$73,710	\$72,076	\$70,495
MEDIAN AGE	34.5	35	34.7
SOME COLLEGE	89.7%	87.8%	88.4%



DOUBLE DRAGON



PINE STATE BISCUITS



APEX



FORD FOOD & DRINK



GENIES CAFE



BAERLIC BREWING



FUNHOUSE LOUNGE

