



— SUBLEASE OPPORTUNITY —

# 10990 ROE AVENUE

TWO BUILDING PORTFOLIO

**CBRE**



# FLOOR PLANS

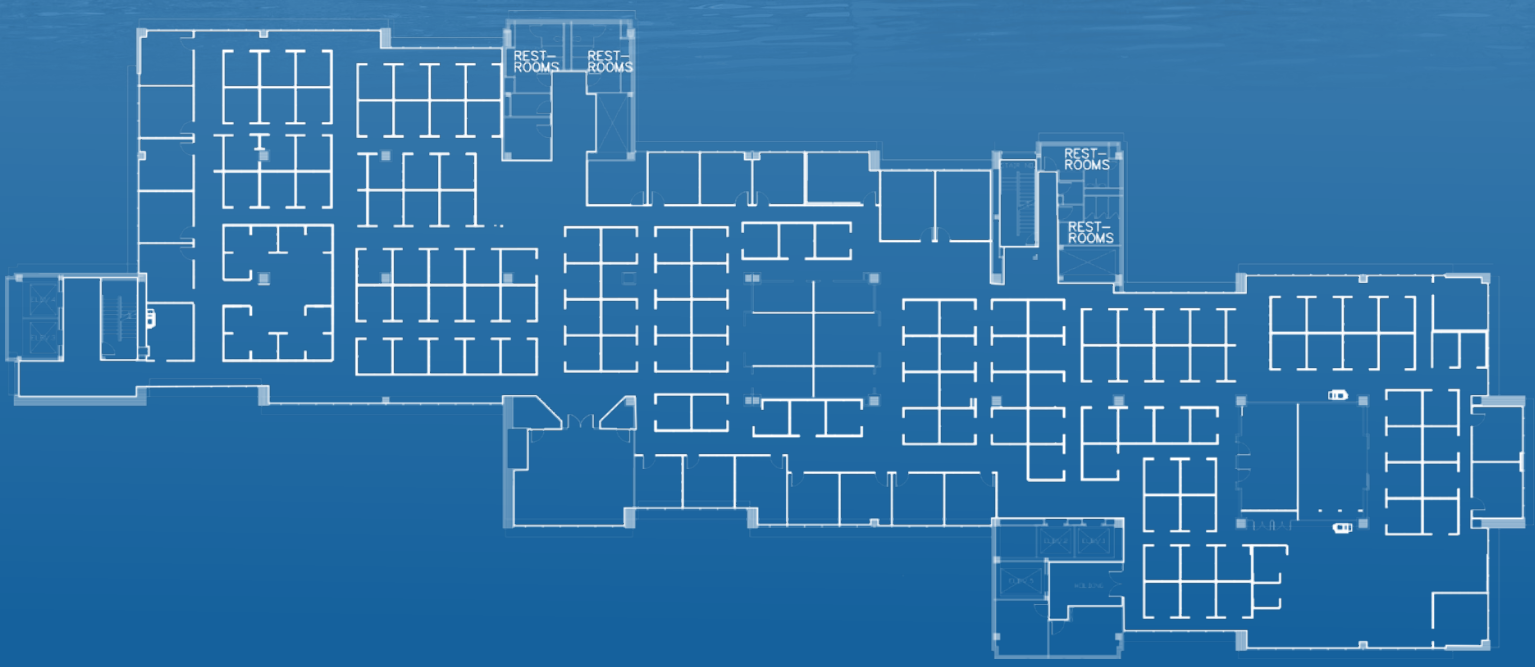

**NORTH BUILDING**  
± 174,186 SF

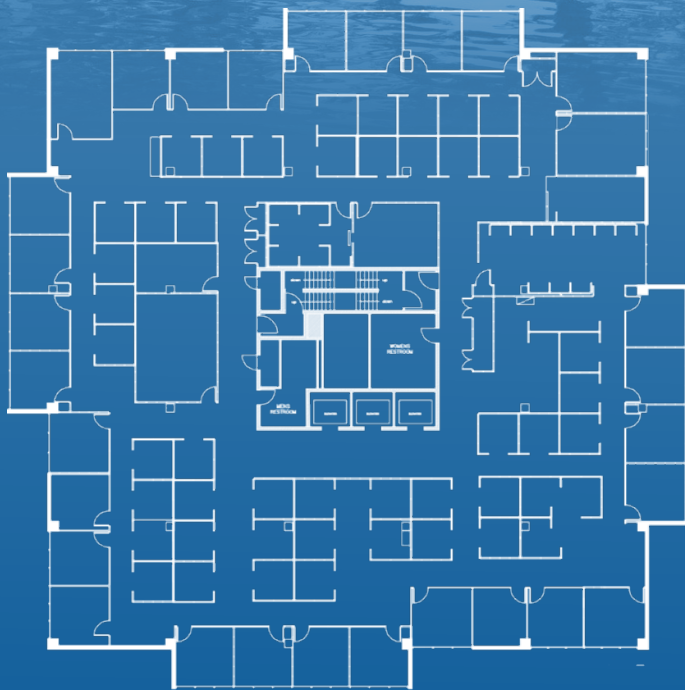

## TOWER BUILDING

162,598± SF



Former Yellow Freight Headquarters



\$13.00/SF Full Service Gross



Furniture Available



Tower Building Occupancy: 4/1/2022

North Building Occupancy: 6/1/2022

Sublease Expires 2/29/2024



Total Available: **336,784± RSF**

### TOWER BUILDING

Tower 1: **14,512± RSF**

Tower 2: **16,454± RSF**

Tower 3: **16,454± RSF**

Tower 4: **16,454± RSF**

Tower 5: **16,454± RSF**

Tower 6: **16,454± RSF**

Tower 7: **16,454± RSF**

Tower 8: **16,454± RSF**

Tower 9: **16,454± RSF**

Tower 10: **16,454± RSF**

### NORTH BUILDING

North Building LL: **28,795± RSF**

Company Street: **41,004± RSF**

1st Floor: **37,700± RSF**

2nd Floor: **27,848± RSF**

3rd Floor: **38,839± RSF**

# CONTACT

## Bob Fagan, CCIM

Senior Vice President

+1 816 968 5821

bob.fagan@cbre.com

## Matt Eckert

Senior Vice President

+1 816 968 5837

matt.eckert@cbre.com



# 10990 ROE AVENUE

Visit: [CBRE.US/10990SUBLEASE](https://www.cbre.us/10990sublease)

©2021 CBRE, Inc. All rights reserved. This information has been obtained from sources believed reliable, but has not been verified for accuracy or completeness. You should conduct a careful, independent investigation of the property and verify all information. Any reliance on this information is solely at your own risk. CBRE and the CBRE logo are service marks of CBRE, Inc. All other marks displayed on this document are the property of their respective owners, and the use of such logos does not imply any affiliation with or endorsement of CBRE. Photos herein are the property of their respective owners. Use of these images without the express written consent of the owner is prohibited. PMStudio\_July2021

**CBRE**