



PRINCES GATE

CATTERICK
DL9 3EL

A dominant retail & leisure scheme for the region

- 7 screen multiplex cinema
- 60 bed Premier Inn
- 151,757 sq ft scheme

3 units to-let
(3,287, 4,237, 3,500 OR
c11,000 sq.ft combined)



UNITS SUITABLE FOR RETAIL & LEISURE



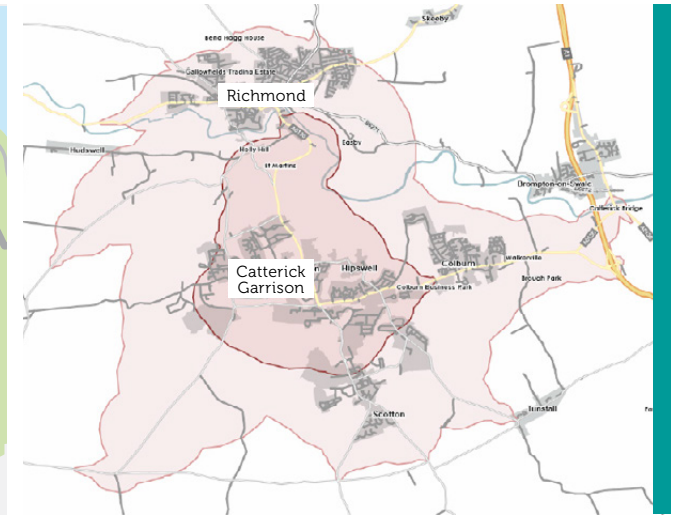

10 Minute Drive 5 Minute Drive

Catering spend is above the national average within the 5 & 10 minute catchment

The overall scheme extends to 151,757 sq ft with retail, leisure and hotel accommodation

Princes Gate is located at the junction of Gough Road and Richmond Road in Catterick Garrison.





Established destination with an underserved catchment

- 1,500 homes allocated for development next 5 to 10 years
- 625 homes being provided in next 5 years,
- £104 million total consumer retail expenditure per annum
- Garrison has a population of 13,000, expected to grow to 25,000 by 2020
- The area is dominated by average and above average income families





EMPIRE

UPPER LEVEL

1 **shoezone**

2 **SPORTS DIRECT.com**

3 **Office Outlet**

4 **Boots**

5 **next**

6 **Iceland**

7 **Poundland**

7a **pets at home**

7b **COTSWOLD outdoor**

MANAGEMENT OFFICE 8 **YORKSHIRE TRADING CO**

KFC

Brewers fayre Premier Inn

5a **DOMINOS PIZZA** 5b **HOLLAND & BARRETT**

16 **COSTA COFFEE** 17 **SUBWAY** 18 **BARNARDOS** 19

20 **Hungry Horse**

VACANT UNIT 14 3,287 sq.ft	VACANT UNIT 13 4,237 sq.ft	VACANT UNIT 12 3,500 sq.ft
----------------------------------	----------------------------------	----------------------------------

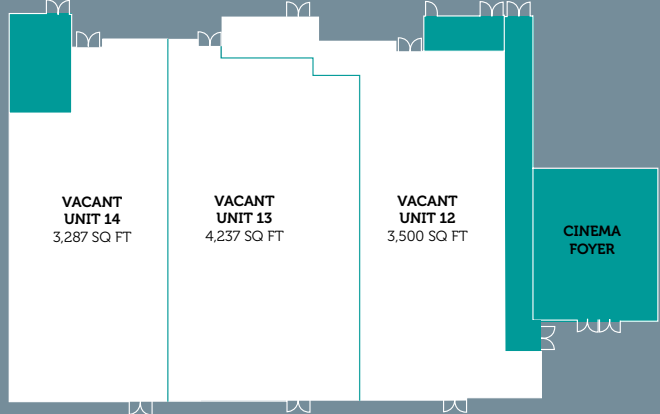

OUTDOOR SEATING AREA



PRINCES GATE

CATTERICK
DL9 3EL

All enquiries:



Ian Hare
T: +44 (0) 113 220 1233
E: ihare@savills.com



Savills, their clients and any joint agents give notice that: They are not authorised to make or give any representations or warranties in relation to the property either here or elsewhere, either on their own behalf or on behalf of their client or otherwise. They assume no responsibility for any statement that may be made in these particulars. These particulars do not form part of any offer or contract and must not be relied upon as statements or representations of fact. Any areas, measurements or distances are approximate. The text, photographs and plans are for guidance only and are not necessarily comprehensive. It should not be assumed that the property has all necessary planning, building regulation or other consents and Savills have not tested any services, equipment or facilities. Purchasers must satisfy themselves by inspection or otherwise. Designed and produced by DSEmotion | NOV 2018_2969