

An aerial architectural rendering of a residential development. The scene features a large, winding lake in the foreground with a fountain spraying water. Several large, modern-style houses with dark roofs and light-colored walls are arranged around the lake. A parking lot with several cars is visible in the middle ground. The background shows more houses and trees, suggesting a suburban setting.

unison

Health + Wellness
Collective

FOR SALE / FOR LEASE / BUILD TO SUIT

8601 BROADWAY EXT, OKLAHOMA CITY, OK 73114

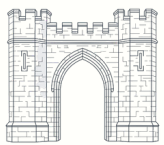

BLAKE CURTIN | (405) 410-8733 | BLAKE@EXP309.COM

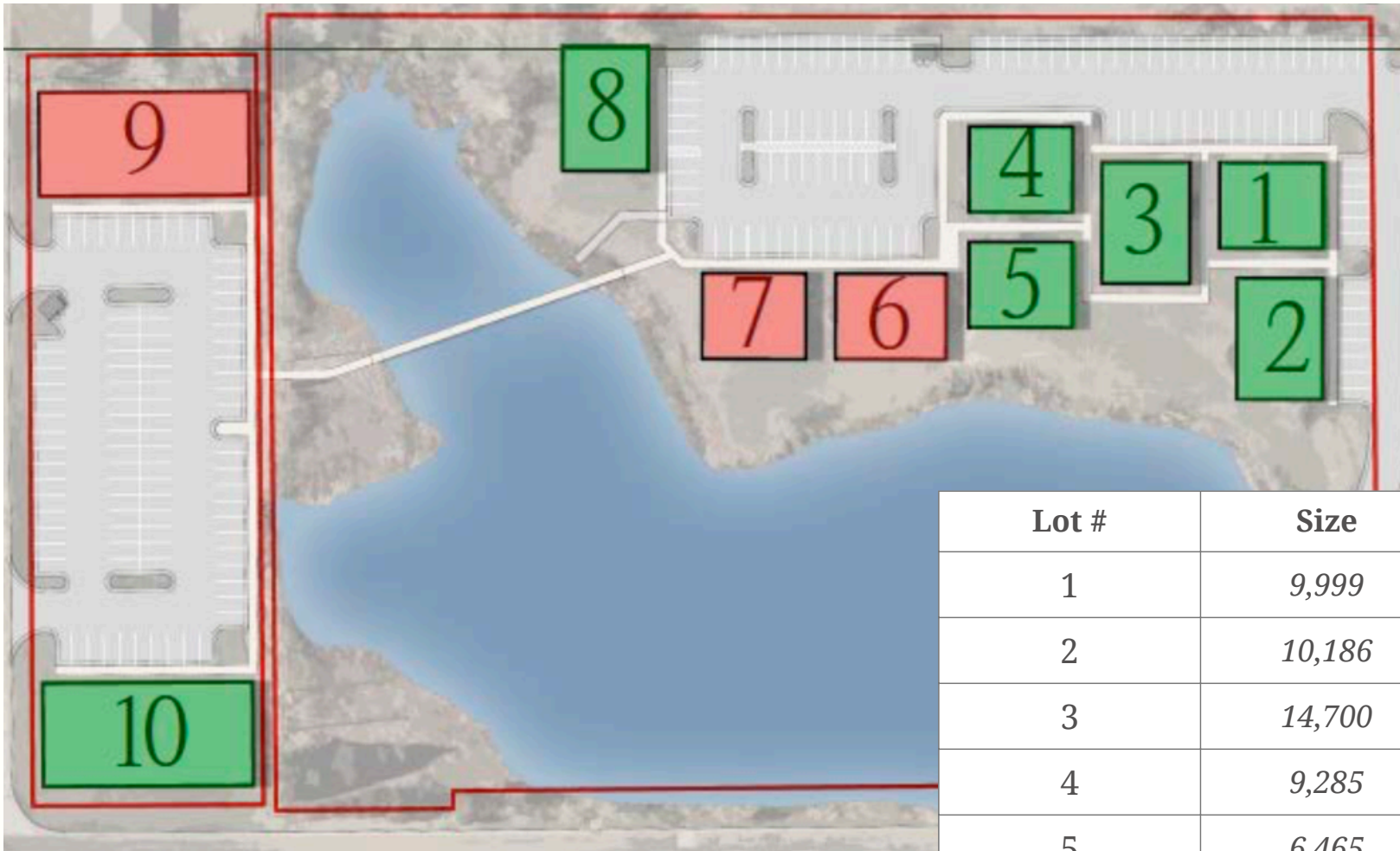

Lot #	Size	Price
1	9,999	\$375,000
2	10,186	\$437,500
3	14,700	\$420,000
4	9,285	\$360,000
5	6,465	\$390,000
6		SOLD
7		SOLD
8	8,751	\$450,000
9		SOLD
10	27,450	\$1,440,000

AVAILABLE SITES

7 of 10 sites remain. Three already sold.
 All sites include utilities, entitlements,
 and 192 shared parking spaces.

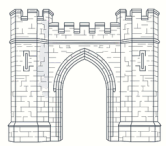

PAD SITES FOR SALE

Purchase your pad site shovel-ready.
Utilities, entitlements, and 192 parking spaces already in place.

OFFICE SPACE FOR LEASE

Lease space in one of our new office buildings

CUSTOM BUILD TO SUIT

We develop a building tailored to your needs.

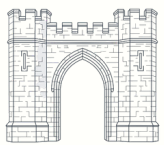

UNISON

Health + Wellness
Collective

**A 7 acre health & wellness collective
where like-minded businesses come
together to holistically care for people**

- **Halfway between Edmond and downtown OKC**
- **1.2M+ vehicles per week on the corridor**
- **Waterfront views, fishing pond, walkways, and green space**
- **Event center designed to bring the community together**
- **Surrounded by Surgery Center of Oklahoma, McBride Clinic, Life.Church, and the Half OKC**

*Tenants share one thing:
a mission to care for people well.*



Medical corridor halfway between Edmond & OKC

115,500 vehicles per day on US-77 (Broadway Extension).

Demographics

2025 Population

3 Miles - 49,153

5 Miles - 155,316

Daytime Population

3 Miles - 78,367

5 Miles - 241,707

Avg. HH income

3 Miles - \$107,587

5 Miles - \$104,181



Medical

- | | |
|------------------------------|--------------------------------|
| 1 Community Hospital | 6 Saints Dermatology |
| 2 Surgery Center of Oklahoma | 7 Scotts Sabolich Prosthetics |
| 3 McBride Clinic Hospital | 8 OKC Rehabilitation Hospital |
| 4 McBride ASC | 9 Pediatric ENT |
| 5 OneCore Hospital | 10 Hunter's Specialty Pharmacy |

Non-Medical

- | |
|----------------------------------|
| 11 KIPP Charter School |
| 12 The Half Development |
| 13 Life.Church B&B Campus |
| 14 Thunder Ion Practice Facility |

