

FOR LEASE

Mark Stratz

Vice President

+1 602 882 4621

mark.stratz@cushwake.com

Scott Baumgarten

Vice President

+1 602 224 4488

scott.baumgarten@cushwake.com

**1520 EAST PIMA STREET &
1436 SOUTH 16TH STREET**

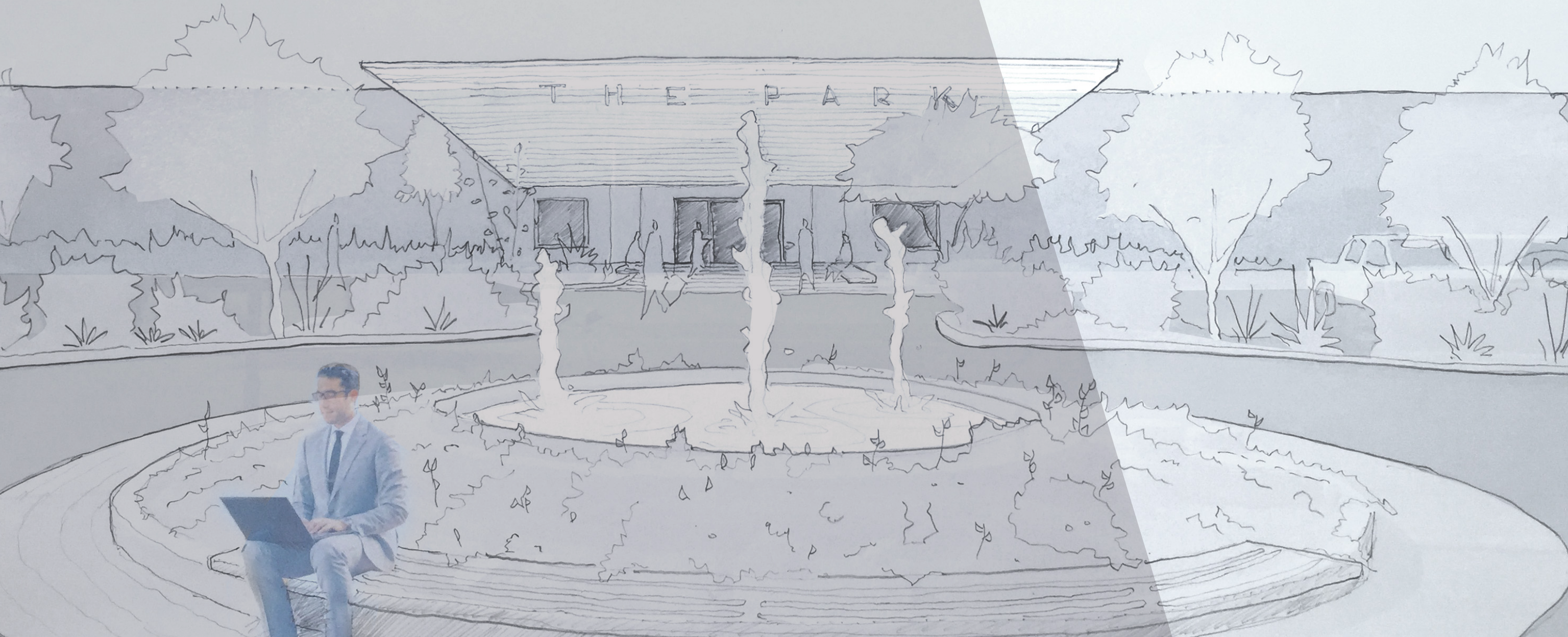

SUMMARY

Welcome to 1520 East Pima Street and 1436 South 16th Street. 1520 and 1436 are turn-key, back office facilities located at the convergence of the I-17 and I-10 interchange in Phoenix, Arizona. Located just two miles west of Phoenix Sky Harbor International Airport, and with immediate access to the Rental Car Center, 1520 and 1436 provide unparalleled access for any mission critical operation.

1520 East Pima Street and 1436 South 16th Street offer dynamic call center/office space with fully-improved executive suites - all ready for immediate occupancy.



DETAILS



Building 1

Building 2

Pima Street

16th Street

Address: 1520 East Pima Street, Phoenix, AZ 85034

APN: \$12.00 NNN

Parking: 5.6:1,000 SF (free)

Building SF: ±21,560

Year Built: 1984

Clear Height: 14'

Fire Protection: Fully-sprinklered

Power: Redundant. Auto switching natural gas and diesel powered generator for an uninterrupted power supply

HVAC: 100% air conditioned, data center has a dedicated HVAC unit

Loading: Knockout panels for grade-level doors

Misc: Fiber-ready. On-site property amenities.

Address: 1436 South 16th Street, Phoenix, AZ 85034

APN: \$12.00 NNN

Parking: 5.6:1,000 SF (free)

Building SF: ±13,122

Year Built: 1984

Clear Height: 14'

HVAC: 100% air conditioned

Loading: One grade-level door



Conceptual Rendering

1520 EAST PIMA STREET

&

1436 SOUTH 16TH STREET

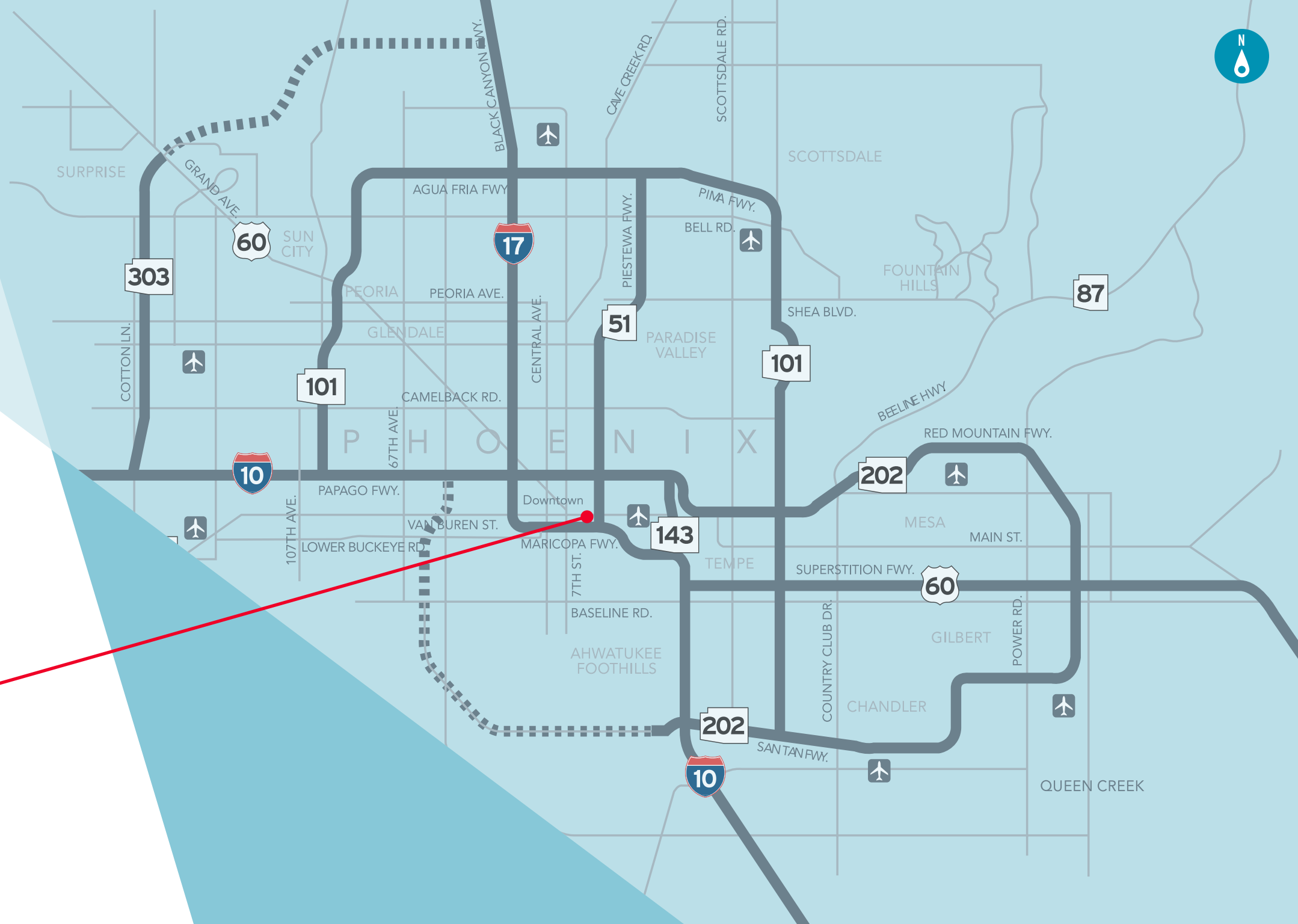



Mark Stratz
Vice President
+1 602 882 4621
mark.stratz@cushwake.com

Scott Baumgarten
Vice President
+1 602 224 4488
scott.baumgarten@cushwake.com