

East Chicago Ave. & Olesen Dr.

Naperville, IL



4,000 SF to 5,000 SF Out Lot in Naperville, IL

We are pleased to offer the following space for lease:

- ◆ Butera Market grocery anchored shopping center
- ◆ Out Lot is located on Chicago Avenue with great visibility
- ◆ Excellent demographics and income levels
- ◆ Ideal for fast food, service or high profile retail use

Demographics	1 Mile	3 Mile	5 Mile	Traffic Counts
Residential Pop.	13,156	92,640	214,916	18,700 VPD - E. Chicago Ave.
Daytime Pop.	3,238	81,019	159,428	
Avg. Annual Inc.	\$133,559	\$124,719	\$119,915	

James Schutter Senior Managing Director **312.224.3210** jschutter@ngkf.com

Luke Sementa Director **312.224.3974** lsementa@ngkf.com

**Newmark Grubb
Knight Frank**

Retail

500 West Monroe Street, Suite 2900, Chicago, IL 60661

The information contained herein has been obtained from sources deemed reliable but has not been verified and no guarantee, warranty or representation, either express or implied, is made with respect to such information. Terms of sale or lease and availability are subject to change or withdrawal without notice.

East Chicago Ave. & Olesen Dr.

Naperville, IL

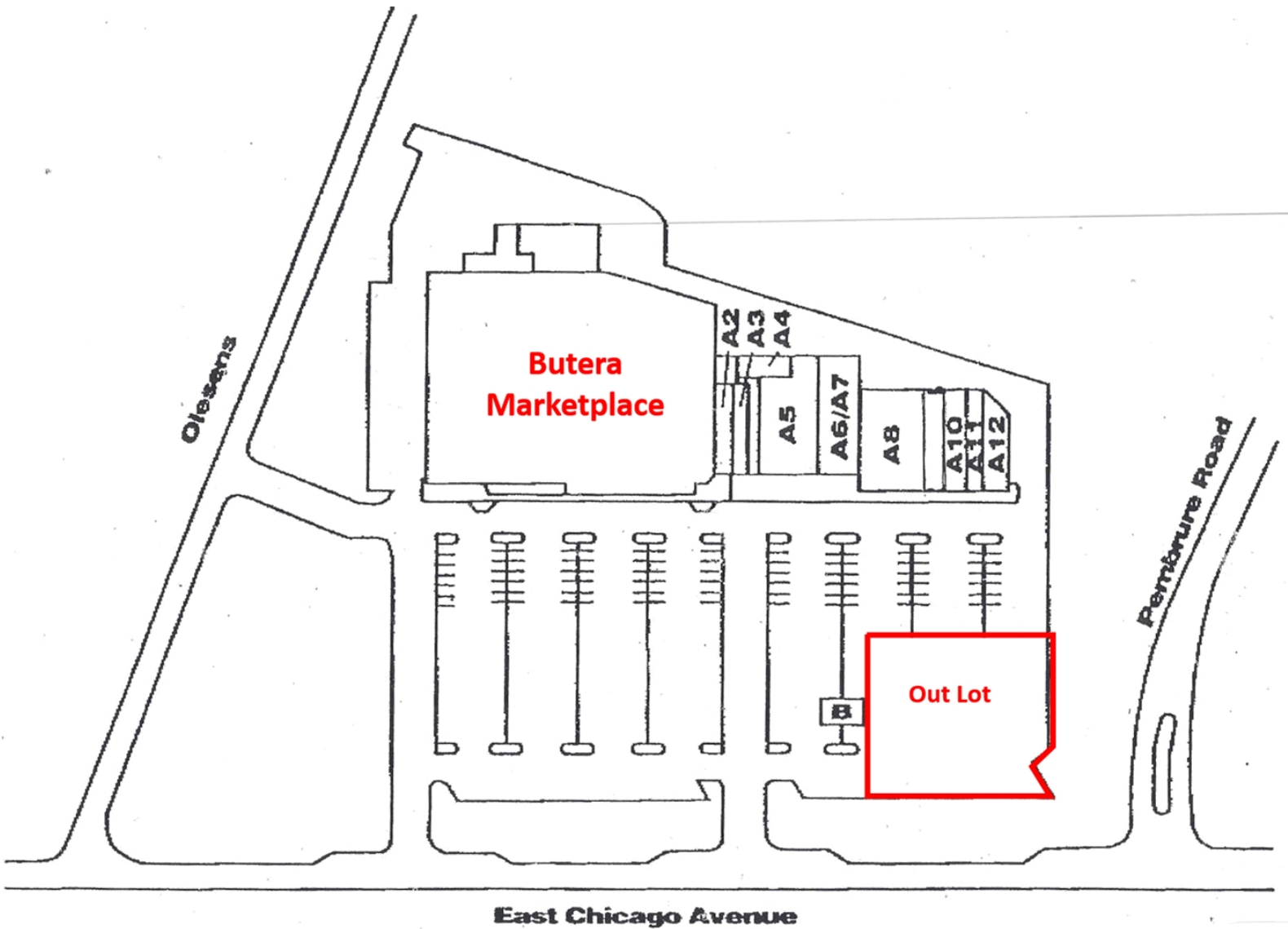

**Newmark Grubb
Knight Frank**

Retail

James Schutter Senior Managing Director 312.224.3210 jschutter@ngkf.com
Luke Sementa Director 312.224.3974 lsementa@ngkf.com

East Chicago Ave. & Olesen Dr.

Naperville, IL



**Newmark Grubb
Knight Frank**

Retail

James Schutter Senior Managing Director 312.224.3210 jschutter@ngkf.com

Luke Sementa Director 312.224.3974 lsementa@ngkf.com