

51 SANGRA COURT STREAMWOOD, IL END UNIT

1,380 SF INDUSTRIAL CONDO FOR SALE



PROPERTY SPECIFICATIONS:

SIZE: 1,380 +/- sf
OFFICE: 250 +/- sf
DRIVE-IN DOORS: 1
CEILING HEIGHT: 15'
CAR PARKING: 3 stalls
POWER: 200 amps
BUILT: Between 2006 and 2008
TAXES: \$8,000 (2016 payable 2017)
ASSOCIATION FEES: \$118/month

SALE PRICE: \$100,000.00

COMMENTS:

Small industrial unit perfect for start-up or downsize business!
End unit with lots of natural light. High ceilings, drive-in door, great visibility and access. Close to major transportation routes via US Rt. 20 and the nearby newly expanded I-390 expressway.

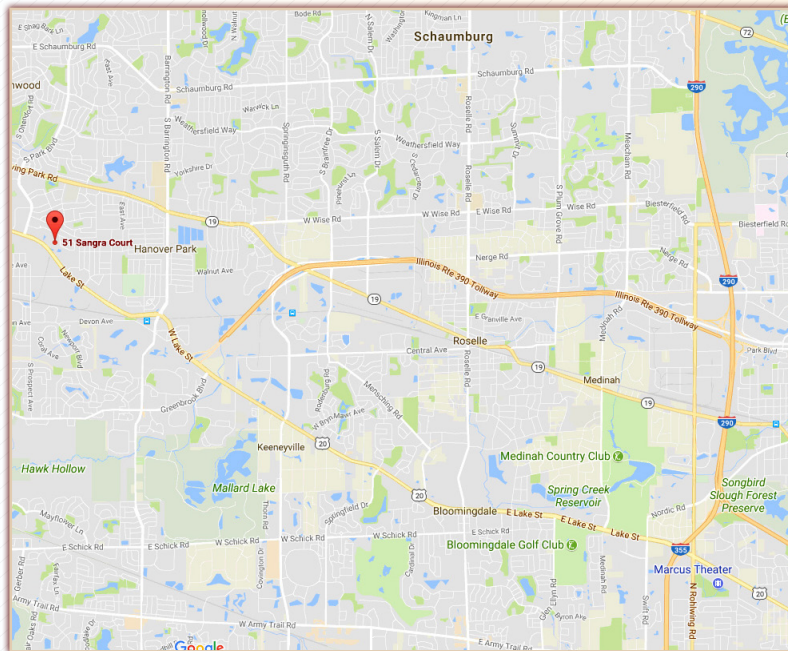

*NO WARRANTY OR REPRESENTATION IS MADE AS TO THE ACCURACY OF THE FOREGOING INFORMATION. TERMS AND AVAILABILITY ARE SUBJECT TO CHANGE OR WITHDRAWAL WITHOUT NOTICE.

Contact Jim Pietrarosso or
Dan Brown, Managing Broker Today!

jimp@browncommercialgroup.com
dbrown@browncommercialgroup.com

847.758.9200

1400 Higgins Road,
Suite A
Elk Grove Village,
IL 60007



www.browncommercialgroup.com

51 SANGRA COURT STREAMWOOD, IL **END UNIT**

1,380 SF INDUSTRIAL CONDO FOR SALE

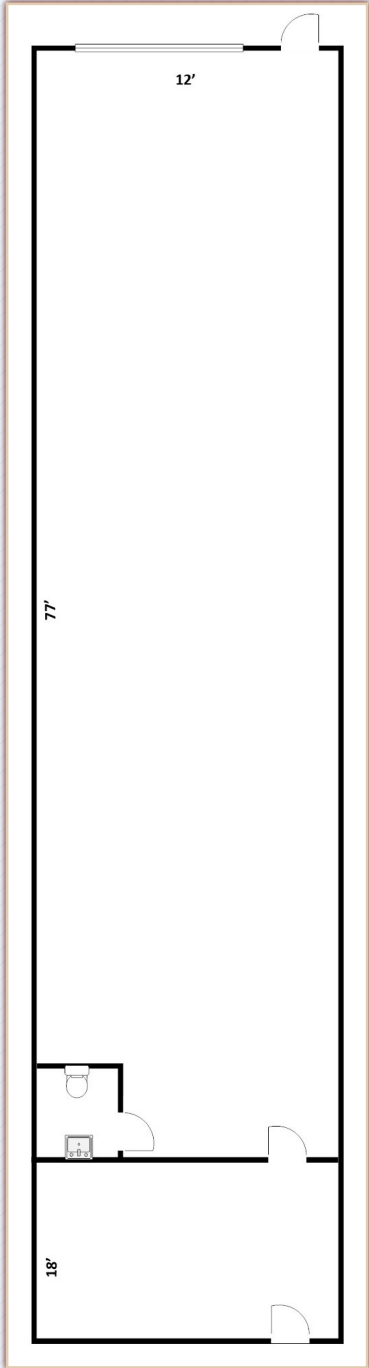

*NO WARRANTY OR REPRESENTATION IS MADE AS TO THE ACCURACY OF THE FOREGOING INFORMATION. TERMS AND AVAILABILITY ARE SUBJECT TO CHANGE OR WITHDRAWAL WITHOUT NOTICE.

Contact Jim Pietrarosso or
Dan Brown, Managing Broker Today!

jimp@browncommercialgroup.com
dbrown@browncommercialgroup.com

847.758.9200

1400 Higgins Road,
Suite A
Elk Grove Village,
IL 60007

B BROWN
COMMERCIAL GROUP, INC.

www.browncommercialgroup.com