

**NEW OWNERSHIP
SIGNIFICANT UPGRADES UNDERWAY**



Industrial Space For Lease

Highlights

- › Outstanding showroom availability
- › Chambers road visibility
- › Outstanding location in popular industrial area with superior visibility
- › Great highway access at Chambers Road and I-70
- › Upgraded sprinkler system
- › Longer lease term available
- › North of Smith Road/rail tracks providing easy access

Commerce Center I

15250 E. 33rd Pl. | Unit C | Aurora, CO 80011

Project Size:	70,301 SF
Unit Size:	8,915 SF
Available:	April 1, 2026
Office:	2,905 SF
Lease Rate:	Contact Brokers
2026 Op Ex:	\$6.99/SF
Year Built:	1985
Sprinklers:	General Duty
Parking:	1.98:1000
Power:	400 Amps, 120/208 Volt (TBV)
Clear Height:	16'
Loading:	2 Drive-Ins (16' x 12' & 10' x 10')
City/County:	Aurora/Adams
Zoning:	I-1



Floor Plan

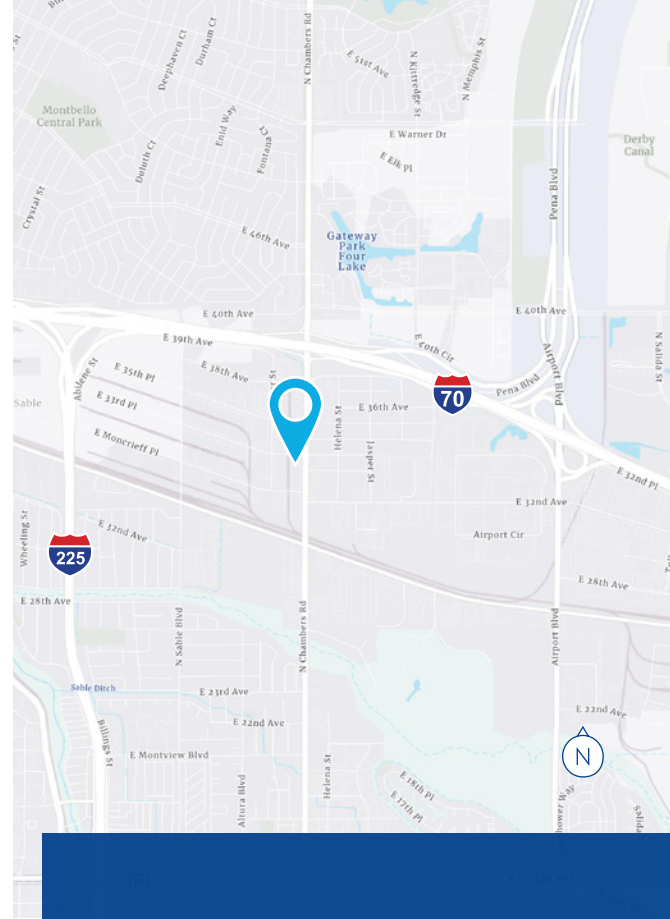
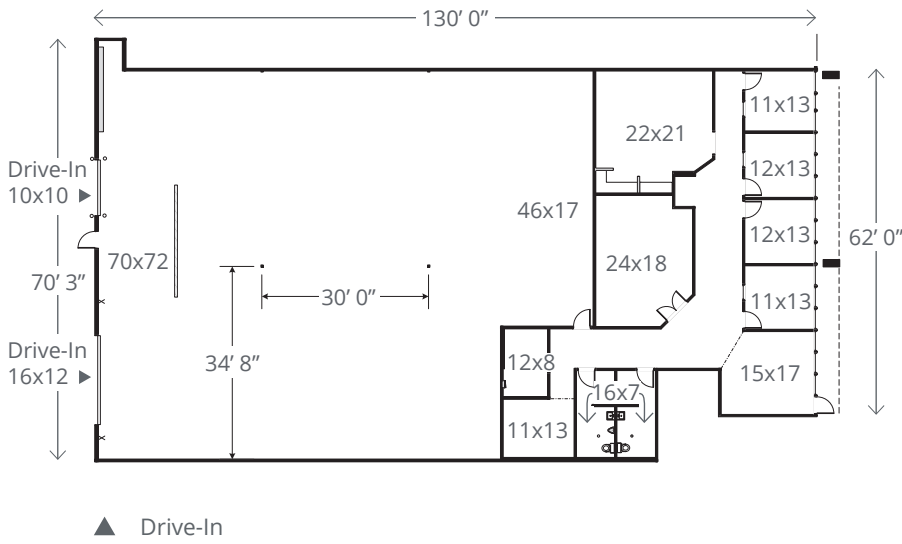

Site Plan

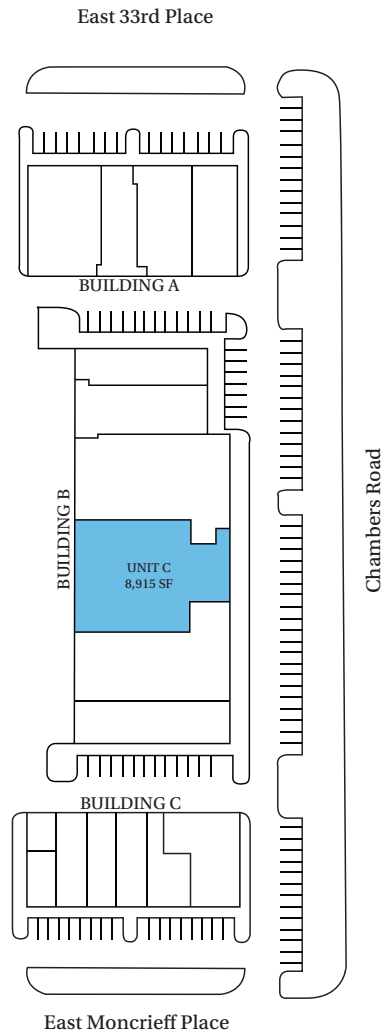

Matt Keyerleber

Principal
 +1 720 284 7100
 matt.keyerleber@colliers.com

T.J. Smith, SIOR

Principal
 +1 303 283 4576
 tj.smith@colliers.com

Nick Rice

Principal
 +1 720 833 4620
 nick.rice@colliers.com

Colliers

4643 S. Ulster Street, Suite 1000
 Denver, CO 80237
 P: +1 303 745 5800
 F: +1 303 745 5888

colliers.com/denver

This communication has been prepared by Colliers Denver for advertising and/or general information only. Colliers Denver makes no guarantees, representations or warranties of any kind, expressed or implied, regarding the information including, but not limited to, warranties of content, accuracy and reliability. Any interested party should undertake their own inquiries as to the accuracy of the information. Colliers Denver excludes unequivocally all inferred or implied terms, conditions and warranties arising out of this document and excludes all liability for loss and damages arising therefrom. This publication is the copyrighted property of Colliers Denver and/or its licensor(s). © 2024. All rights reserved. This communication is not intended to cause or induce breach of an existing listing agreement.