

PROJECT DATA

TYPE	GENERAL SALES	MARKET
NEW LOCATION	<input checked="" type="checkbox"/> PHARMACY	<input checked="" type="checkbox"/> SECURITY (3)
EXIST'G BLDG	<input type="checkbox"/> PHOTO	<input type="checkbox"/> 24 HOUR STORE
REMODEL	<input type="checkbox"/> LIQUOR	<input type="checkbox"/> OTHER

SQUARE FOOT AREA SUMMARY

DEPARTMENT	SALES	STOCK	SERVICE	TOTAL EXIST'G	TOTAL NEW
GEN SALES	NEW	4593	942	1190	6725
MARKET	NEW	900			900
MARKET	EXIST'G				685
RX	NEW	685			95
RX WAIT'G	EXIST'G				435
PHOTO	NEW	435			0
PHOTO	EXIST'G				0
LIQUOR	NEW	0	0	0	0
BSMT	EXIST'G				0
2ND FLOOR	NEW	0	0	0	0
2ND FLOOR	EXIST'G				8840
TOTAL NEW		6708	942	1190	
TOTAL EXST'G					8840 SQ. FT.
TOTAL AREA: FIRST FLOOR					0 SQ. FT.
TOTAL AREA: OTHER LEVELS					8840 SQ. FT.
GROSS AREA INCLUDING ALL DEPARTMENTS & ALL LEVELS:					91 LN. FT.
RX SHELVING LINEAL FEET:					

INTERIOR HANGING SIGNS

- GENERAL SALES AREA:
SIGN "E" ENTRANCE SIGN
SIGN "B" BEAUTY SIGN
SIGN "BH" BEAUTY CORN SIGN
SIGN "BB" BODY & BATH SIGN
SIGN "L" LIQUOR / THANK YOU SIGN
SIGN "PH" PHOTO SIGN
SIGN "PHH" PHOTO CORN SIGN
SIGN "F" MARKET SIGN
SIGN "T" STORE HOURS SIGN
SIGN "GC" GREETING CARD SIGN
SIGN "D" DOWNTOWN CHECKOUT LANE # SIGN
SIGN "CA" CALIFORNIA ACCESSIBILITY SIGN (8'-0" TO BOTTOM OF SIGN)
SIGN "ADA" SYMBOL OF ACCESSIBILITY PHARMACY DEPARTMENT:
REFER TO FIXTURE PLAN FOR REQUIRED SIGNS
SIGN "J" PICK UP SIGN
SIGN "K" DROP OFF SIGN
SIGN "M" DROP OFF / PICK UP SIGN
SIGN "P" PHARMACY SIGN
SIGN "P1" PHARMACY .COM SIGN
SIGN "Q" CONSULTATION WINDOW SIGN
SIGN "TX" T.A.S.

GENERAL NOTES

- PLEASE PROVIDE PROPER A.D.A. CLEARANCES ON BOTH SIDES OF ALL DOORS
- MIRROR ON REAR WALL
- BEAUTY CORNICE
- SALES AREA CORNICE (FIXTURE MOUNTED)
- PHOTO CORNICE (FIXTURE MOUNTED UNLESS NOTED)
- CARPET TILES & DESIGN LINKS FURNISHED AND INSTALLED BY WALGREENS (WHEN SHOWN)
- MASTER-BILT REACH-IN REFRIGERATION: MODEL TEM - ENDLESS REACH-IN REFRIGERATORS AND MODEL TEL - ENDLESS REACH-IN FREEZERS (ADD 2" AT EACH END, FOR END PANELS AND ADD FLOOR DRAIN)
 - A. 1 TEM-30: 155"W X 37 3/4"D X 80"H
 - 1 TEM-30: 91 1/2"W X 37 3/4"D X 80"H
 - B. 1 TEL-30: 124 1/2"W X 37 3/4"D X 80"H
 - BMG/BLG SERIES - SELF CONTAINED REFRIGERATORS AND FREEZERS
 - C. BMG-74: 78"W X 36 3/4"D X 79"H
 - D. BLG-74: 78"W X 36 3/4"D X 79"H
 - SMB SERIES - SELF CONTAINED SLIDING DOOR REFRIGERATORS
 - E. SMB-580: 70"W X 32 1/4"D X 76 1/2"H BACK-UP REFRIGERATORS AND FREEZERS
 - F. 1 TAC-48D: 52"W X 35 3/4"D X 80 1/2"H
 - G. 1 TAI-48D: 52"W X 35 3/4"D X 80 1/2"H
 - 8. MASTER-BILT WALK-IN COOLER: PROVIDE #1000R COOLMASTER DOORS 26 3/4" X 73" EACH AND #100R FREEZEMASTER DOORS 26 3/8" X 73" EACH BY ANTHONY
- DOOR(S): FOR EACH DOOR PROVIDE (7) D BEV-O-FLOW GRAVITY SHELVES: UPPER (5) WITH SLIDES AND LOWER (2) WITH ROLLERS COMPLETE WITH UPRIGHTS
- DOOR(S): FOR EACH DOOR PROVIDE 36"D B-O-F NYLALITE SHELVING SYSTEM
- DOOR(S): D ROLLER CONVEYOR AT FLOOR LEVEL
- DOOR(S): FOR EACH DOOR PROVIDE 27"D ANTHONY SHELVES
- DOOR(S): FOR EACH DOOR PROVIDE (2) 27"D ANTHONY SHELVES AND (4) 36"D MERCHANDISER SHELVES
- DOOR(S): D DOUBLE DECK ROLLER CONVEYOR
- ICE CHEST BY VENDOR
- CART RAILS W/ DISPLAY SHELF & SLAT WALL ABOVE
- PROVIDE A 6"H BLACK VINYL BASE AT ALL CHECKOUTS
- ELECTRONIC ARTICLE SURVEILLANCE SYSTEM PHARMACY DEPARTMENT:
- PHARMACY SEATING AREA: (4) SEATS
- PROVIDE FRAMING FOR 3'-6"W X 7'H OPENING FOR FUTURE DROP-OFF WINDOW
- COMPUTER TERMINAL
 - 15A: INTERCOM PLUS TERMINAL
 - 15C: TRAINING TERMINAL (IN TRAINING ROOM)
- RX SINK AND CABINET
- CRX CABINET
- RX REFRIGERATOR
- PROVIDE A CARPETED FLOOR WITH A RUBBER RUNNER, RX UNDERCOUNTER INSERTS:
 - #1 - RX 3 DRAWER VIAL INSERT
 - #2 - RX 3 DRAWER FILE INSERT
 - #3 - RX OPEN INSERT
 - #4 - RX CONSULTATION COUNTER UNIT
 - #5 - RX PRINTER INSERT
 - #6 - RX 5 DRAWER FILE INSERT
 - #7 - RX OPEN INSERT WITH CPU SHELF
 - #8 - RX OPEN CABINET (30"H CENTER)
 - #9 - RX 10 DRAWER FILE CABINET
- OFFICE:
 - 20. PROVIDE TILED FLOOR & VINYL WALLCOVERING
 - 21. UNDER COUNTER SHELF UNIT
 - 22. PRINTER
 - 23. LATERAL FILE
 - 24. OFFICE COMPUTERS
 - 24A: P.O.S. TERMINAL
 - 24B: AS400 TERMINAL
 - 24C: OFFICE P.C.
 - 25. TILL LOCKER
 - 26. SAFE
 - 27. (NOT USED)
- STOCKROOM:
 - 28. NEST-A-FLEX CONVEYOR
 - 29. GRAVITY CONVEYOR
 - 30. POWER ROLLER CONVEYOR
 - 31. SEE ARCHITECTURAL DRAWINGS FOR EXACT LOCATION & POSITIONING OF COMPACTORS
 - 31A: TRASH COMPACTOR
 - 31B: BALER
 - 31C: CARDBOARD COMPACTOR
- EMPLOYEE ROOM:
 - 32. EMPLOYEE LOCKERS: (1) 48" W COAT LOCKER W/ PERFORATED DOORS, (6) 6 TIER BOX LOCKERS & (2) ADA LOCKERS W/ SAFETY VIEW DOORS
 - 33. 5'-0"W X 2'-2"D EMPLOYEE COUNTER W/ (1) CABINET
 - 34. EMPLOYEE ROOM REFRIGERATOR (PROVIDE 32" CLEARANCE WHEN NEXT TO COUNTER)
 - 35. EMPLOYEE ROOM SINK (IN COUNTER)
 - 36. 4'-0" MIRROR CENTERED ON WALL ABOVE COUNTER
- MISCELLANEOUS:
 - 37. ELECTRICAL OUTLET FOR FUTURE USE
 - 38. VENDOR RACKS: REMOVE BASE DECK & SHOES; (END PANEL TO REMAIN)
 - 39. PROVIDE OPENING FOR ONE-WAY GLASS (SEE INTERIOR ELEVATION FOR LOCATION)
 - 40. NEWSPAPER RACK BY VENDOR
 - 41. PICTURE CARE PLUS TERMINAL

REMODEL LEGEND

EXISTING	RESET	NEW

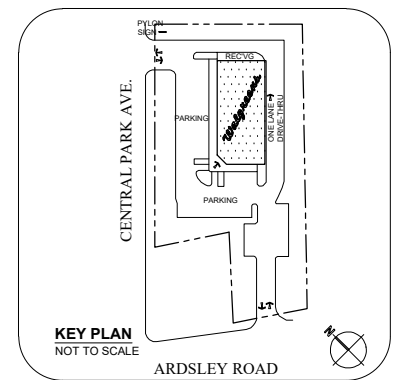

TOTAL BY LINEAL FOOTAGE

ITEM	796 LN. FT.
FRONT WALL SHELVING	24 LN. FT.
BEAUTY WALL SHELVING	72 LN. FT.
REMAINING WALL SHELVING (BACK & SIDE WALL, RX SEATING)	67 LN. FT.
GRAND GONDOLAS	330 LN. FT.
FRONT GONDOLAS	235 LN. FT.
HALLMARK SHELVING	23 LN. FT.
BEAUTY GONDOLAS	12 LN. FT.
COOLERS	20 LN. FT.
FREEZERS	13 LN. FT.

FIXTURE LEGEND

ITEM	DATE
G GONDOLA (EA. SIDE)	07-08-08
GE GONDOLA	07-07-08
WS WALL SHLVG	

EXECUTIVE APPROVAL

NAME	DATE
SENIOR VICE PRESIDENT FACILITIES DEVELOPMENT	07-08-08
SENIOR VICE PRESIDENT STORE OPERATIONS	07-07-08
VICE PRESIDENT STORE OPERATIONS	

* A.D.A. DOOR CLEARANCES

ACCESSIBLE REQUIREMENTS MAY VARY WITH LOCAL JURISDICTIONS & APPROACH TO DOOR SWING

REVISIONS

NO.	DATE	BY	DESCRIPTION	CONST
6	01/03/14	AS	"END STAND" E-1 SCOPE. REPLACE (1) EXISTING END STAND WITH (1) NEW BOOT'S No.7 END STAND	
5	10-27-10	DBA	FIELD CONDITIONS; MOVE (3) LOCKERS INTO THE EMPLOYEE ROOM.	
4	09-30-10	DBA	REVISE BEAUTY BULL PEN TO LARGER SIZE. REVISE STOCK ROOM SHELVING HEIGHT AND REMOVE SECURITY CABINET.	
3	09-13-10	DBA	REVISE PHOTO EQUIPMENT TO FUJID430 PER PHOTO SCHEDULE.	
2	07-14-10	DBA	REVISE WALL SHELVING AND GONDOLAS TO LOWER SHELVING; ADJUST MISES ACCORDINGLY. ADD 6" OF WALL SHELVING AND 438 ENDS/STANDS PER MERCHANDISING. ADD 438 GIFT CARD ENDS/STANDS. REMOVE LINE OF FLOORING CHANGES. REMOVE 3 FEET OFF FRONT GONDOLA AND ADD 3 FEET OF GONDOLA CLOSEST TO MARKET.	
1	07-09-10	DBA	REMOVE PHARMACY CONVEYOR AND REVISE INSERT 8 TO A 7.	

CERTIFICATION AND SEAL

I HEREBY CERTIFY THAT THIS PLAN AND SPECIFICATION WAS PREPARED BY ME OR UNDER MY DIRECT SUPERVISION AND THAT I AM A DULY REGISTERED ARCHITECT OR ENGINEER UNDER THE LAWS OF THE STATE OF NEW YORK AS SIGNED BY MY HAND AND SEAL.

STORE NUMBER 12093		
PROJECT NAME WALGREENS STORE (NEC) CENTRAL PARK & ARDSLEY SCARSDALE, NEW YORK		
MINOR REMODEL		
DRAWING TITLE FIXTURE FLOOR PLAN	SCALE: 1/8"=1'-0"	DRAWING NO.
CADD PLOT: 12093-D1-20-06DEC13	SCALE: 1/8"=1'-0"	DRAWING NO.
VOID PLOT: 12093-D1-19-27oct10	DRAWN BY: D. BALLENT ARENDS	DATE: 12/19/08
SUPERSEDES PLAN DATED: 05/20/08	REVIEWED BY: L. CUMMINGS	OF DWGS.

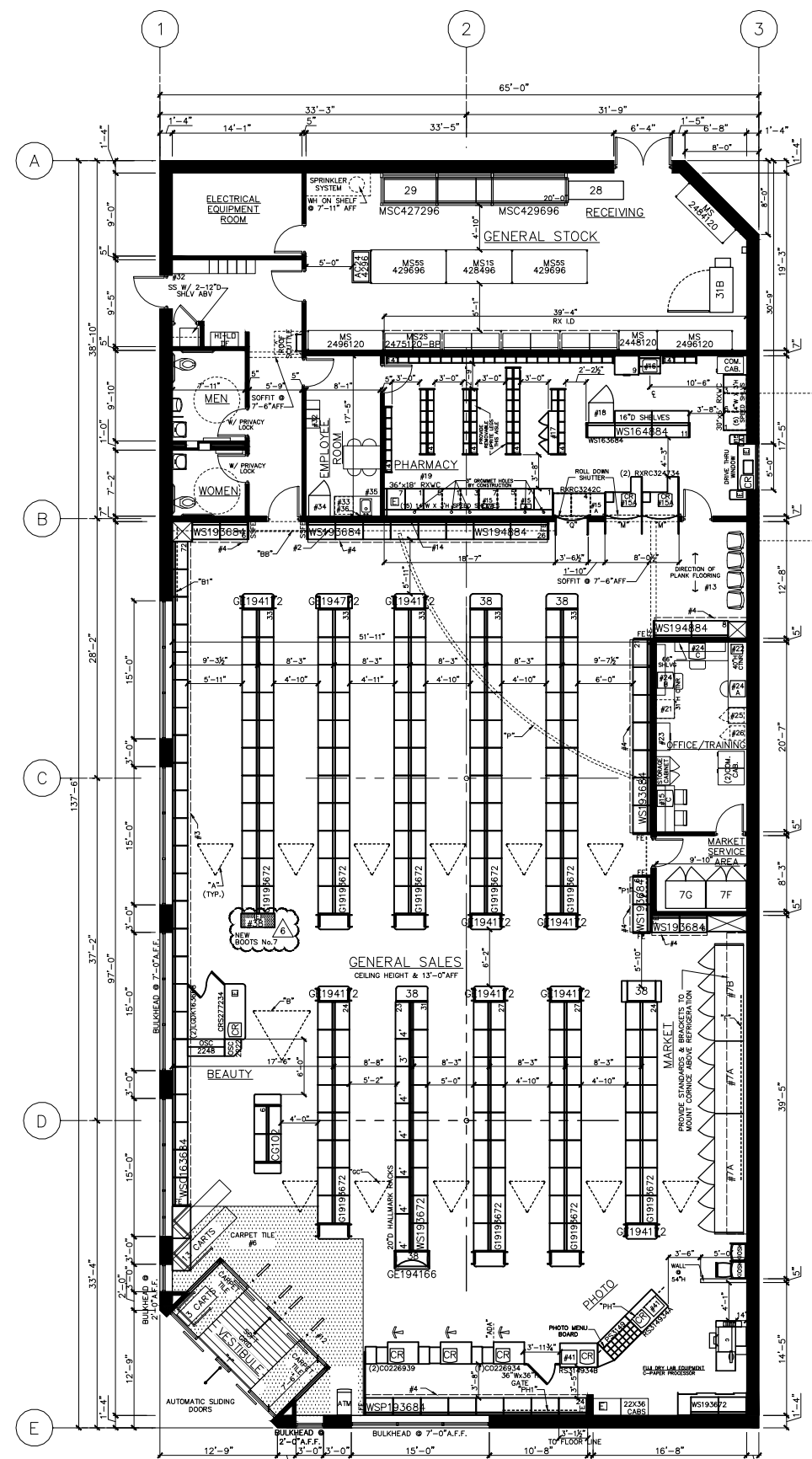

1. LANE DRIVE-THRU SEE ARCHITECTURAL DRAWINGS FOR EXACT LOCATION OF ANNING

06-28-010 (D114) REVISE BEAUTY CHECKOUT LOCATION PER MERCHANDISING. REMOVE HALLMARK GIFT CARD VENDOR RACK PER MERCHANDISING.

06-18-010 (D113) FOR PRIOR REVISIONS SEE PREVIOUS D1. REVISE REACH-IN COOLERS TO CURRENT 30" PROTOTYPE DOORS.