

FOR LEASE
4,300 SF ±
Professional Office
Mobile, AL



4300 Downtowner Loop N.

Mobile, AL 36609

Property Features:

- 2,000sf - 4,300sf ± Available
- Prime location at the corner of Downtowner Blvd. & Downtowner Loop N.
- Just a couple blocks from main retail & restaurant corridor of Airport Blvd.
- Large open area with several small and executive offices
- T.I. Allowance determined by term
- 10 parking spaces plus more if needed

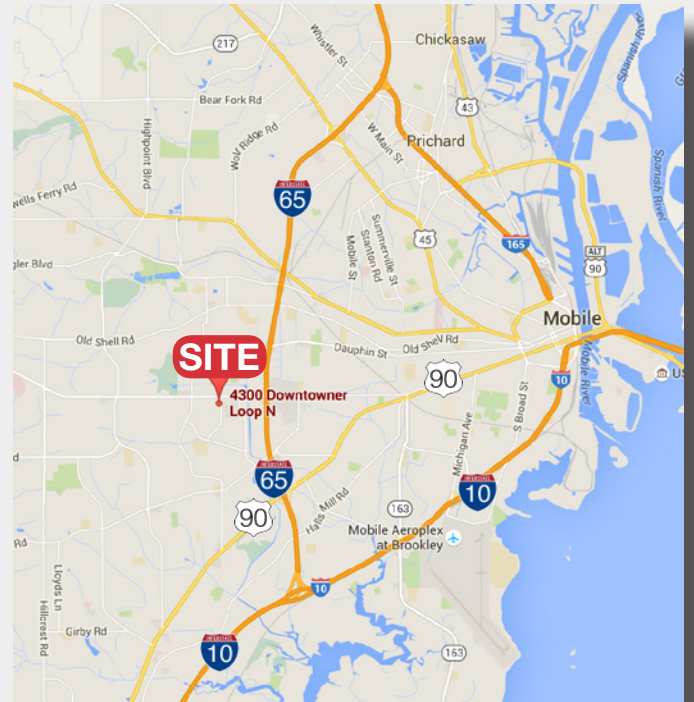

For more information:

Allan Cameron, SIOR

251.751.9553 cell • acameron@nai-mobile.com

Lease Rate: \$10/sf/yr
NNN

FOR LEASE • OFFICE SPACE



**Click on maps to view online.*

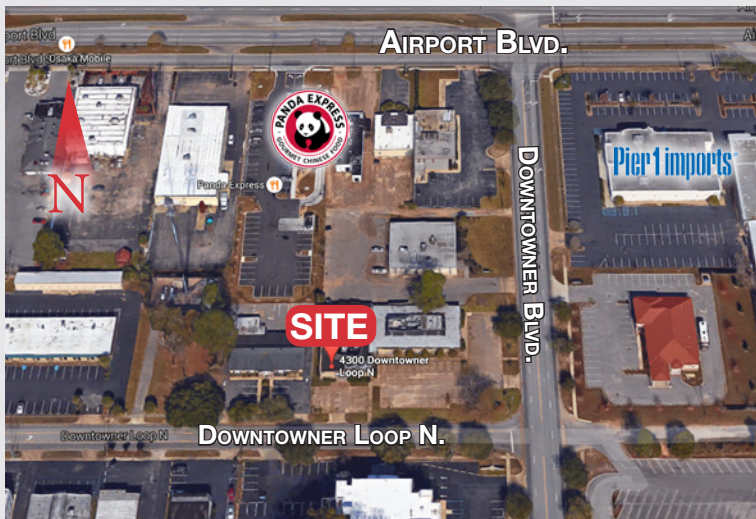

Location Description

- 1 mile ± to I-65
- 2.4 miles ± to HWY 90 (Government Blvd.)
- 4.2 miles ± to I-10
- 9.7 miles ± to Downtown Mobile
- 14.5 miles ± to Baldwin Co.

For more information:

Allan Cameron, SIOR

251.751.9553 cell

acameron@nai-mobile.com



Floor Plan

FOR LEASE
4,300 SF ±
Mobile, AL

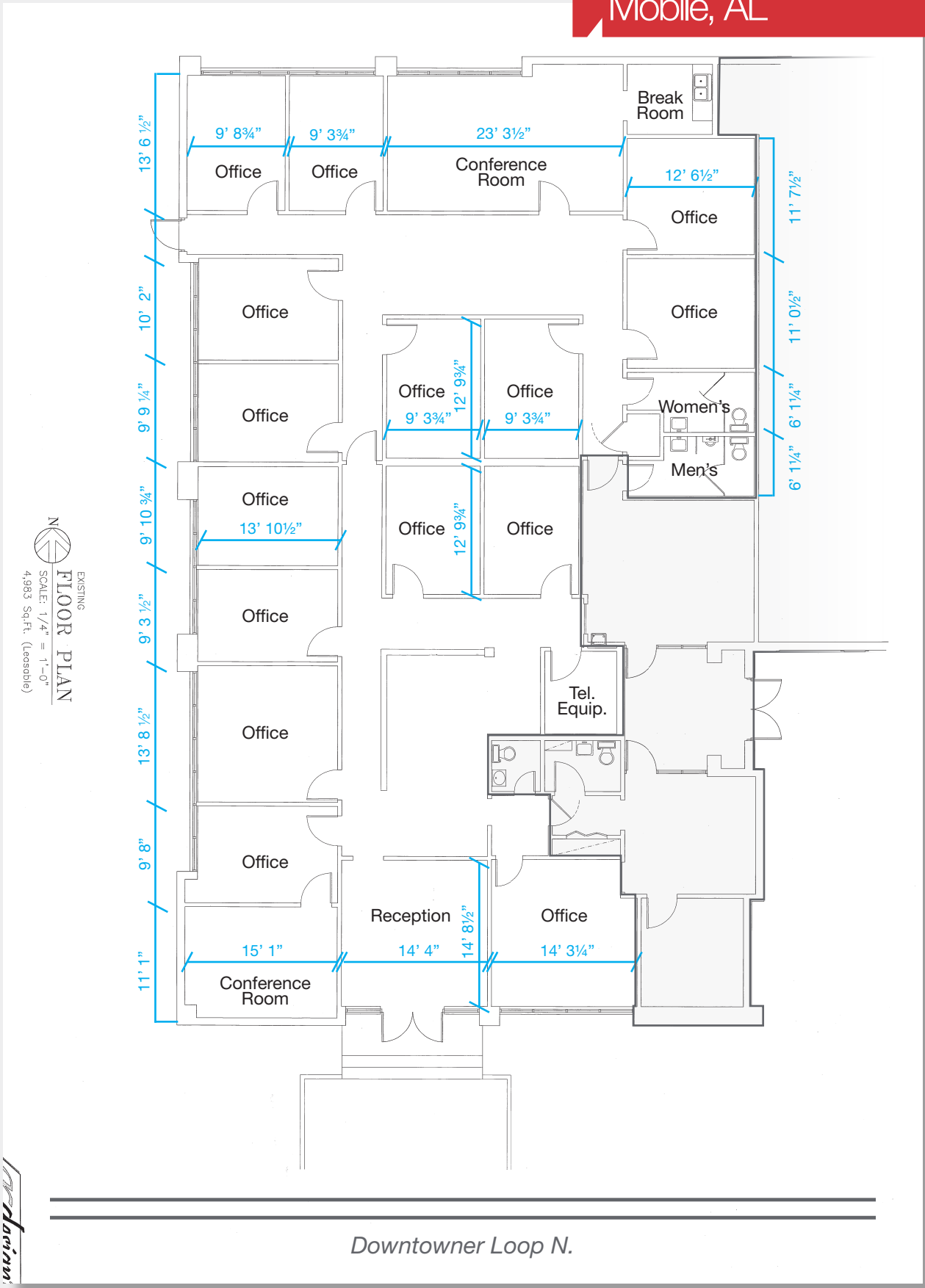

Adrian

Additional Photos

FOR LEASE
4,300 SF ±

Professional Office
Mobile, AL

