

For Sale

## Vacant Office Complex Located On Major Modesto Corridor



For Sale: \$1,200,000 (\$70.89/SF)

# 937 Coffee Rd

Modesto, California 95350

## Property Features

- 16,926 SF Building
- 6 office units ranging in size from 1,435 sf to 16,926 sf
- Great Traffic counts - 20,000 ADT
- Monument signage along Coffee Rd
- Each unit is plumbed with restrooms
- Located in central Modesto, minutes from Sutter Gould, Memorial Hospital, and Downtown Modesto
- 48 Parking Spaces, ratio: 1 space/375 SF

For more information contact:

### JOSH BOWER

(209) 988-8428 | [jbower@pmz.com](mailto:jbower@pmz.com)  
CalBRE Agent Lic. No. 01905264

### DAVID QUIÑONEZ

(209) 614-5653 | [davidq@pmz.com](mailto:davidq@pmz.com)  
CalBRE Agent Lic. No. 01853323



No warranty or representation, express or implied, is made as to the accuracy of the information contained herein, and the same is submitted subject to errors, omissions, change of price, rental or other conditions, prior sale, lease or financing, or withdrawal without notice, and of any special listing conditions imposed by our principals no warranties or representations are made as to the condition of the property or any hazards contained therein are any to be implied.

**PMZ** COMMERCIAL  
SINCE 1957 REAL ESTATE

# Floor Plans

## 937 Coffee Rd, Modesto

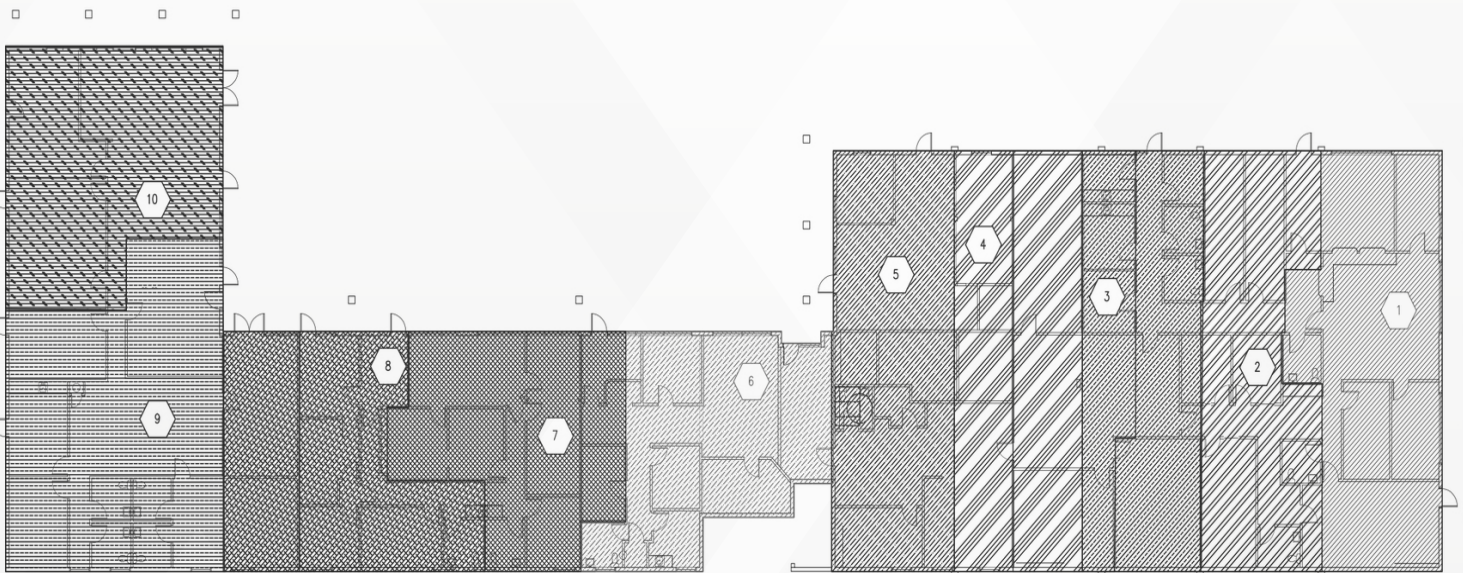

TENANT AREA FLOOR PLAN

|            |          |                |
|------------|----------|----------------|
|            | SPACE 1  | 1,833.40 SF    |
|            | SPACE 2  | 1,531.00 SF    |
|            | SPACE 3  | 1,680.30 SF    |
|            | SPACE 4  | 1,792.30 SF    |
|            | SPACE 5  | 1,708.50 SF    |
|            | SPACE 6  | 1,435.20 SF    |
|            | SPACE 7  | 1,485.15 SF    |
|            | SPACE 8  | 1,656.85 SF    |
|            | SPACE 9  | 2,126.10 SF    |
|            | SPACE 10 | 1,677.40 SF    |
| TOTAL AREA |          | = 16,926.20 SF |

For more information contact:

**JOSH BOWER**

(209) 988-8428 | [jbower@pmz.com](mailto:jbower@pmz.com)

CalBRE Agent Lic. No. 01905264

**DAVID QUIÑONEZ**

(209) 614-5653 | [davidq@pmz.com](mailto:davidq@pmz.com)

CalBRE Agent Lic. No. 01853323

# Area Map

## 937 Coffee Rd, Modesto

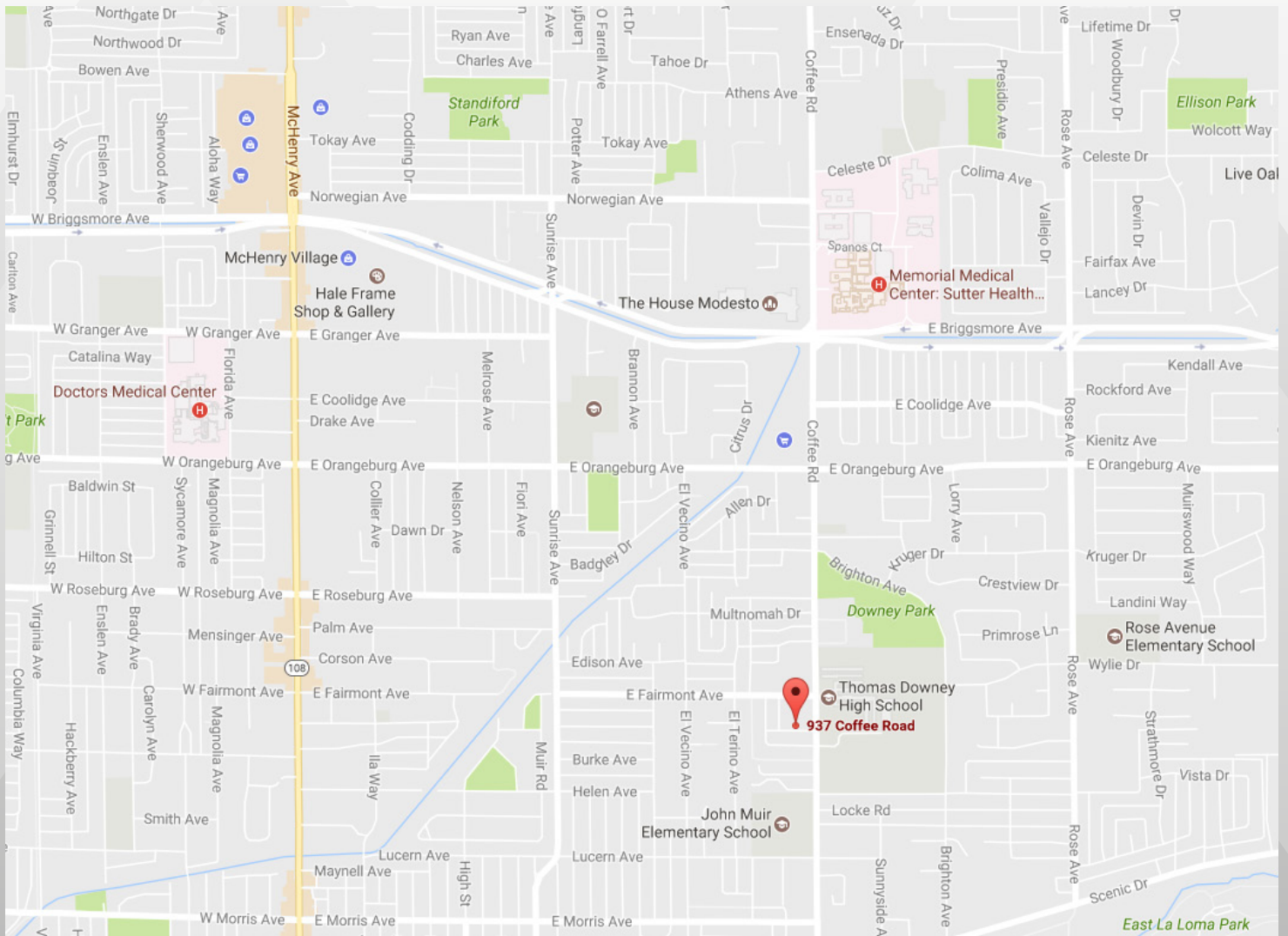

For more information contact:

**JOSH BOWER**

(209) 988-8428 | [jbower@pmz.com](mailto:jbower@pmz.com)

CalBRE Agent Lic. No. 01905264

**DAVID QUIÑONEZ**

(209) 614-5653 | [davidq@pmz.com](mailto:davidq@pmz.com)

CalBRE Agent Lic. No. 01853323

# Demographics Map

## 937 Coffee Rd, Modesto



\* Demographic data derived from 2010 US Census

| Population          | 1 Mile    | 3 Miles   | 5 Miles   |
|---------------------|-----------|-----------|-----------|
| TOTAL POPULATION    | 17,302    | 141,634   | 314,434   |
| MEDIAN AGE          | 36.1      | 34.0      | 32.9      |
| MEDIAN AGE (MALE)   | 33.3      | 32.3      | 31.3      |
| MEDIAN AGE (FEMALE) | 39.4      | 35.9      | 34.7      |
| Households & Income | 1 Mile    | 3 Miles   | 5 Miles   |
| TOTAL HOUSEHOLDS    | 6,778     | 49,692    | 102,270   |
| # OF PERSONS PER HH | 2.6       | 2.9       | 3.1       |
| AVERAGE HH INCOME   | \$57,566  | \$63,833  | \$62,871  |
| AVERAGE HOUSE VALUE | \$287,113 | \$283,170 | \$268,986 |
| Race                | 1 Mile    | 3 Miles   | 5 Miles   |
| % WHITE             | 81.9%     | 78.0%     | 74.3%     |
| % BLACK             | 2.4%      | 3.6%      | 3.5%      |
| % ASIAN             | 2.9%      | 4.6%      | 6.0%      |
| % HAWAIIAN          | 0.3%      | 0.5%      | 0.7%      |
| % INDIAN            | 1.4%      | 1.0%      | 1.0%      |
| % OTHER             | 6.8%      | 7.8%      | 9.9%      |
| Ethnicity           | 1 Mile    | 3 Miles   | 5 Miles   |
| % HISPANIC          | 26.8%     | 35.0%     | 41.3%     |

For more information contact:

### JOSH BOWER

(209) 988-8428 | jbower@pmz.com  
CalBRE Agent Lic. No. 01905264

### DAVID QUIÑONEZ

(209) 614-5653 | davidq@pmz.com  
CalBRE Agent Lic. No. 01853323