



Barnfield Retail Park Phase 2

Chichester PO19 6UX

New Development
117,200 sq ft

To follow Phase 1 which will be occupied by:



Mark Phelps
 020 7317 3773
 m.phelps@wilkinsonwilliams.co.uk



Jason Holden
 020 7494 6937
 jh@cwm.co.uk



**BARNFIELD
RETAIL PARK
PHASE 1**

**BARNFIELD
RETAIL PARK
PHASE 2**

BOGNOR REGIS



Barnfield Retail Park, Phase 2 • Chichester PO19 6UX 117,200 sq ft New Retail Park

This digitally enhanced image is published for convenience of identification only and although believed to be correct its accuracy cannot be guaranteed and it is expressly excluded from any contract.

Barnfield Retail Park Phase 2 • Chichester • May 15 • Ref: 13234.001

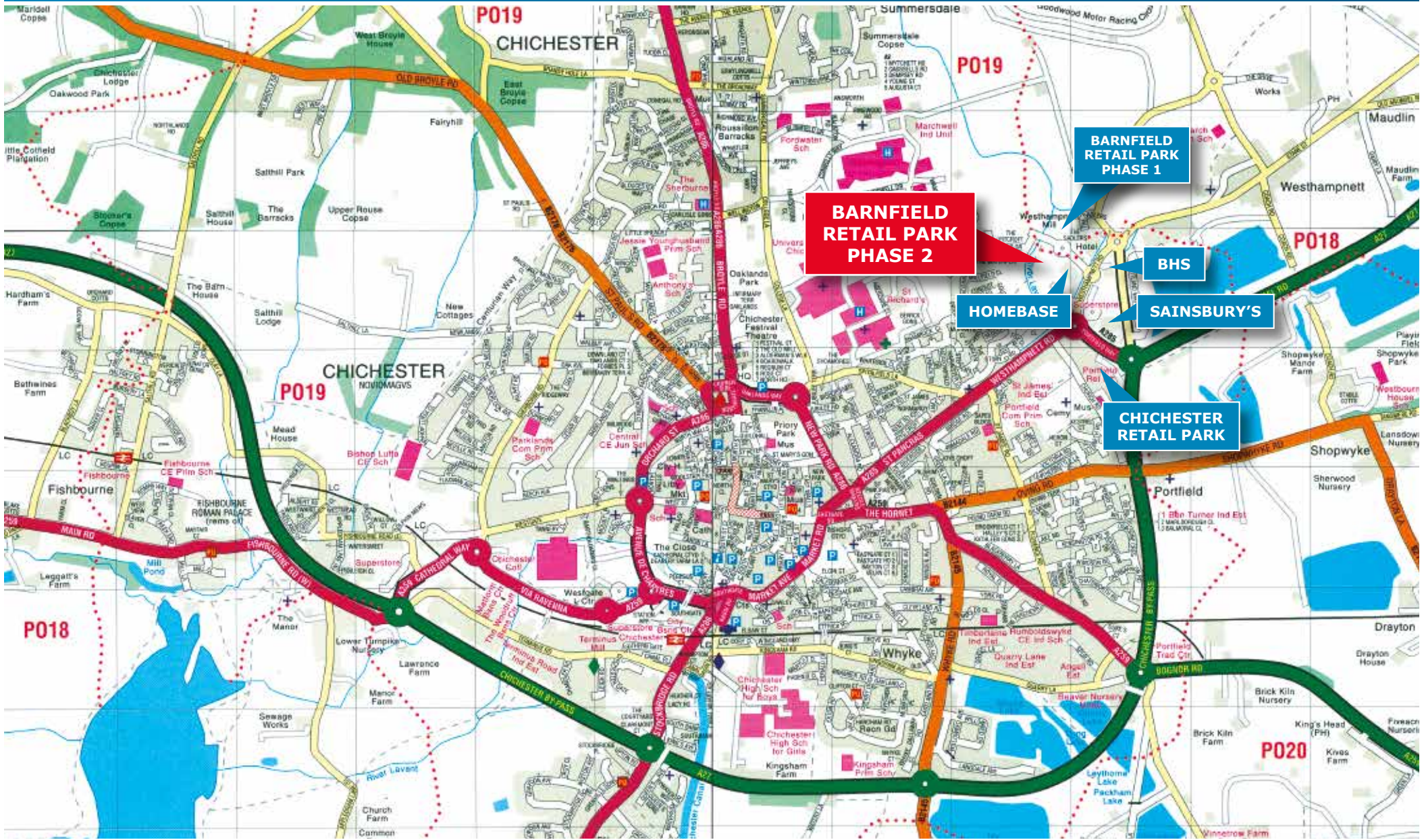

Barnfield Retail Park, Phase 2 • Chichester PO19 6UX 117,200 sq ft New Retail Park

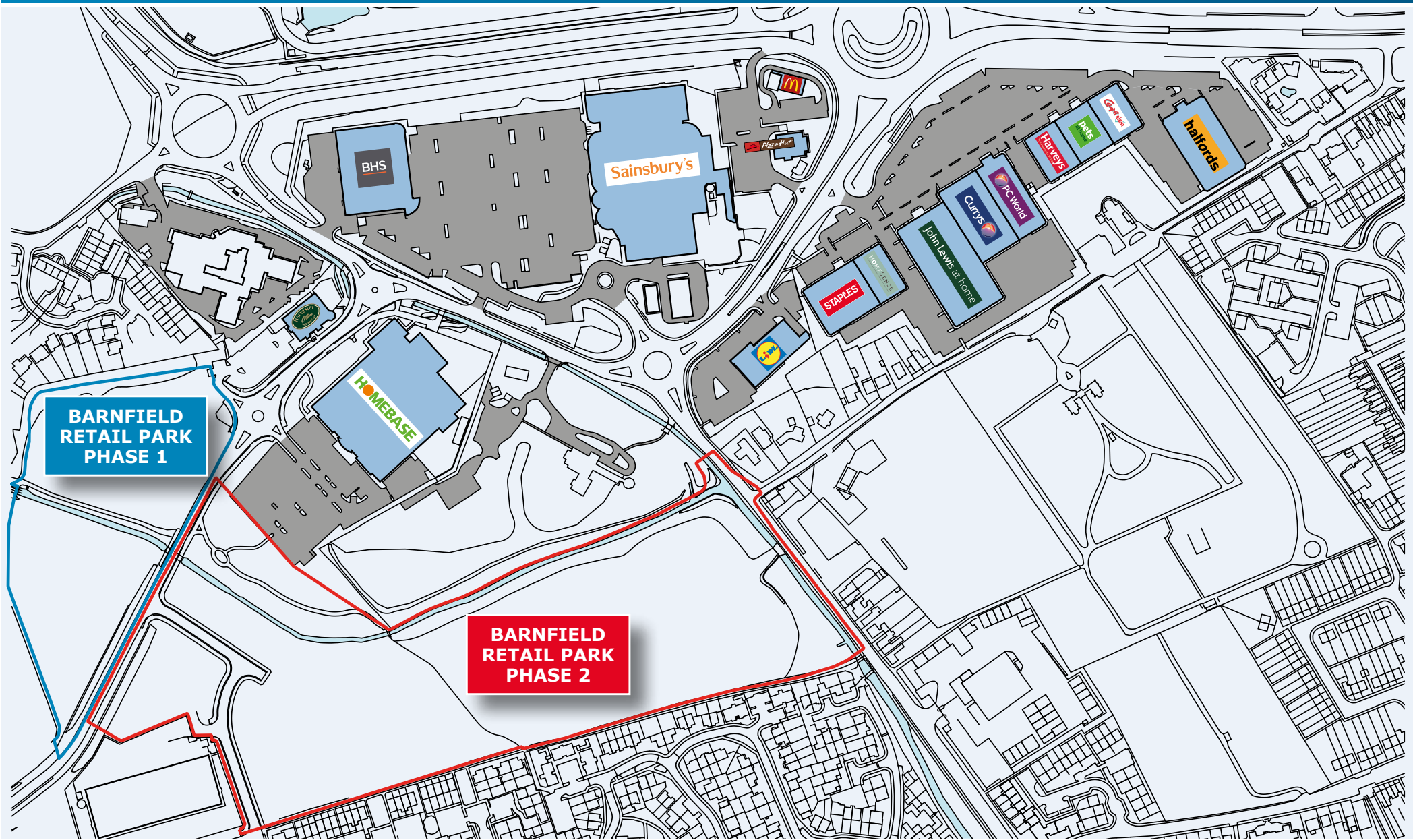

**BARNFIELD
RETAIL PARK
PHASE 1**

**BARNFIELD
RETAIL PARK
PHASE 2**



Barnfield Retail Park, Phase 2 • Chichester PO19 6UX 117,200 sq ft New Retail Park

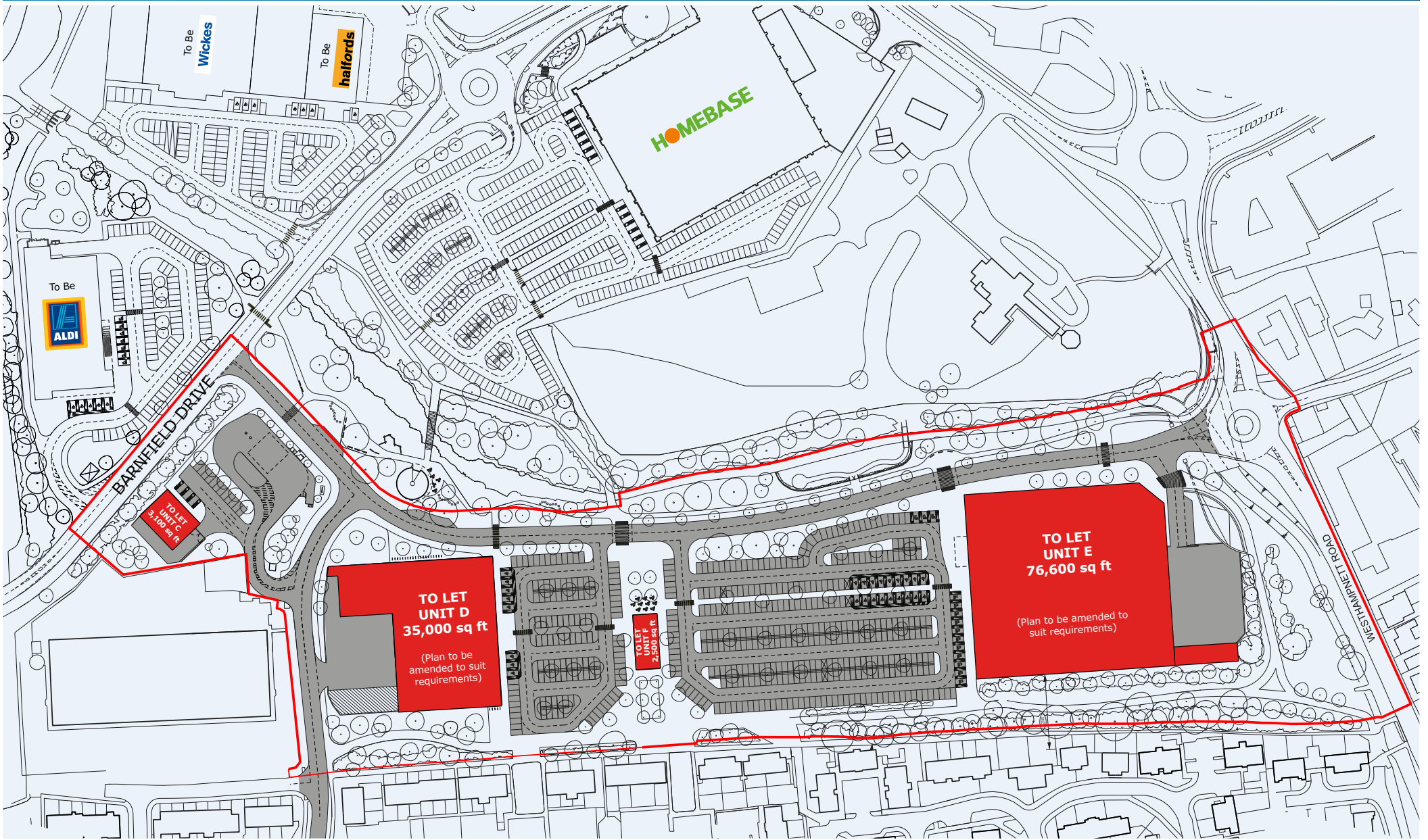

Barnfield Retail Park, Phase 2 • Chichester PO19 6UX 117,200 sq ft New Retail Park



Barnfield Retail Park, Phase 2 • Chichester PO19 6UX 117,200 sq ft New Retail Park



**BARNFIELD
RETAIL PARK
PHASE 2**

HOMEBASE



**Barnfield Retail Park, Phase 2 • Chichester PO19 6UX
117,200 sq ft New Retail Park**

Location

Between Barnfield Drive and Westhampnett Road on the east side of the city. In the heart of the existing retail warehousing, adjacent to Homebase, BHS and Sainsbury's and close to Chichester Retail Park and Lidl.

Description

- A new retail park opposite Phase 1 which is to be occupied by Aldi, Wickes and Halfords and next to the existing 67,000 sq ft Homebase, close to Sainsbury's and BHS.
- The new Phase 1 scheme will extend to approximately 55,800 sq ft.
- The proposed Phase 2 will extend to approximately 117,200 sq ft, built to a modern building specification, with the ability to install mezzanine floors.

Planning Consent

A detailed planning application will be submitted, based upon the final scheme design.

Availability

Flexible unit sizes can be provided. The layout drawings can be adapted to suit occupiers' requirements.

MISREPRESENTATION NOTICE

Brookhouse for themselves and for the Vendors of the property whose Agents they are, give notice that:-

- i. the particulars are set out as a general outline only for the guidance of intending purchasers and do not constitute, nor constitute part of, an offer or contract;
- ii. all descriptions, dimensions, references to condition and necessary permissions for use and occupation and other details are given in good faith and are believed to be correct, but any intending purchaser should not rely on them as statements or representations of fact and must satisfy themselves by inspection or otherwise as to the correctness of each of them;
- iii. no person in the employment of Brookhouse has any authority to make or give any representations or warranty whatever in relation to this property or the particulars, nor enter into any contract relating to the property on behalf of Brookhouse nor any contract on behalf of the vendors; and
- iv. no responsibility can be accepted for any expenses incurred by intending purchasers in inspecting properties which have been sold or withdrawn.



Barnfield Retail Park Phase 2

Chichester PO19 6UX

117,200 sq ft



Mark Phelps

020 7317 3773

m.phelps@wilkinsonwilliams.co.uk



Jason Holden

020 7494 6937

jh@cwm.co.uk