

MERCANTILE TECH VII

Office/Tech Facility



**5001 North Riverside Dr.
Fort Worth, Texas 76137**

Building Size:	80,000 SF	Available SF:	60,000 SF
Depth:	125'	Max SF:	60,000 SF
Clear Height:	18'	Min. Div.:	15,000 SF
Column Spacing:	40' x 40'	Office SF:	BTS
Parking:	6/1,000 SF		

Mercantile Tech VII is strategically located in north Fort Worth and is visible from NE Loop 820. Situated in Mercantile Center, a 1,300 acre locally owned business park with extensive landscaping, onsite property management, and 24/7 security.

Contact:

Brian Randolph

randolph@mercantilecenter.com

817.831.4106 or metro 817.429.5748

www.mercantilecenter.com



MERCANTILE CENTER

The Center of Business

MERCANTILE TECH VII

5001 North Riverside Drive

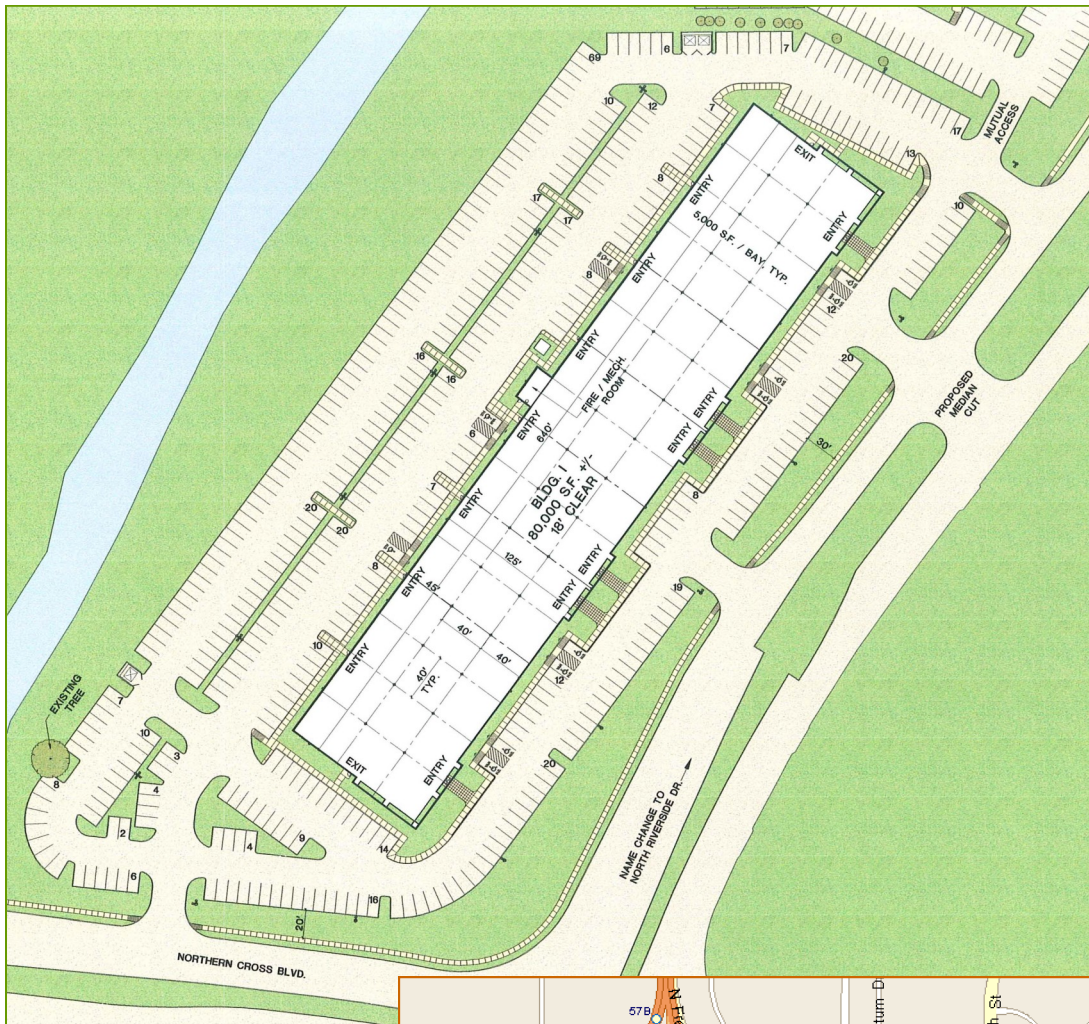

Built in 2008, **Mercantile Tech VII** is designed to be primarily office space. Grade level access would allow for light industrial uses.

Mercantile Center, one of the area's premier and most prestigious business parks, is located within five minutes of downtown Fort Worth in North Central Texas –a strategic location within the Fort Worth/Dallas Metroplex.

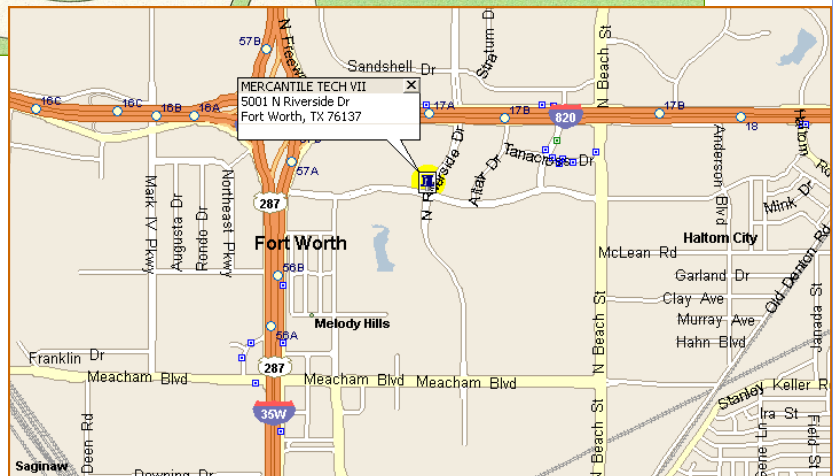

Contact:

Brian Randolph

randolph@mercantilecenter.com

817.831.4106 or metro 817.429.5748

www.mercantilecenter.com



MERCANTILE CENTER

The Center of Business