

TOWN HALL PLAZA

INFORMATION PACKAGE

27611-27701 Southfield Road
Lathrup Village, MI 48076



FOR LEASING INQUIRIES, CONTACT ROB KROCHMAL:
248.867.3304 · ROBK@SURNOW.COM

TABLE OF CONTENTS

Aerial	3
Site Plan	4
Floor Plan - 27701 Southfield Rd	5
Site Highlights	6
About The Surnow Company	7



AERIAL



SITE PLAN

27661-27701 Southfield Road, Lathrup Village, MI 48076



FLOOR PLAN - 27701 Southfield Rd

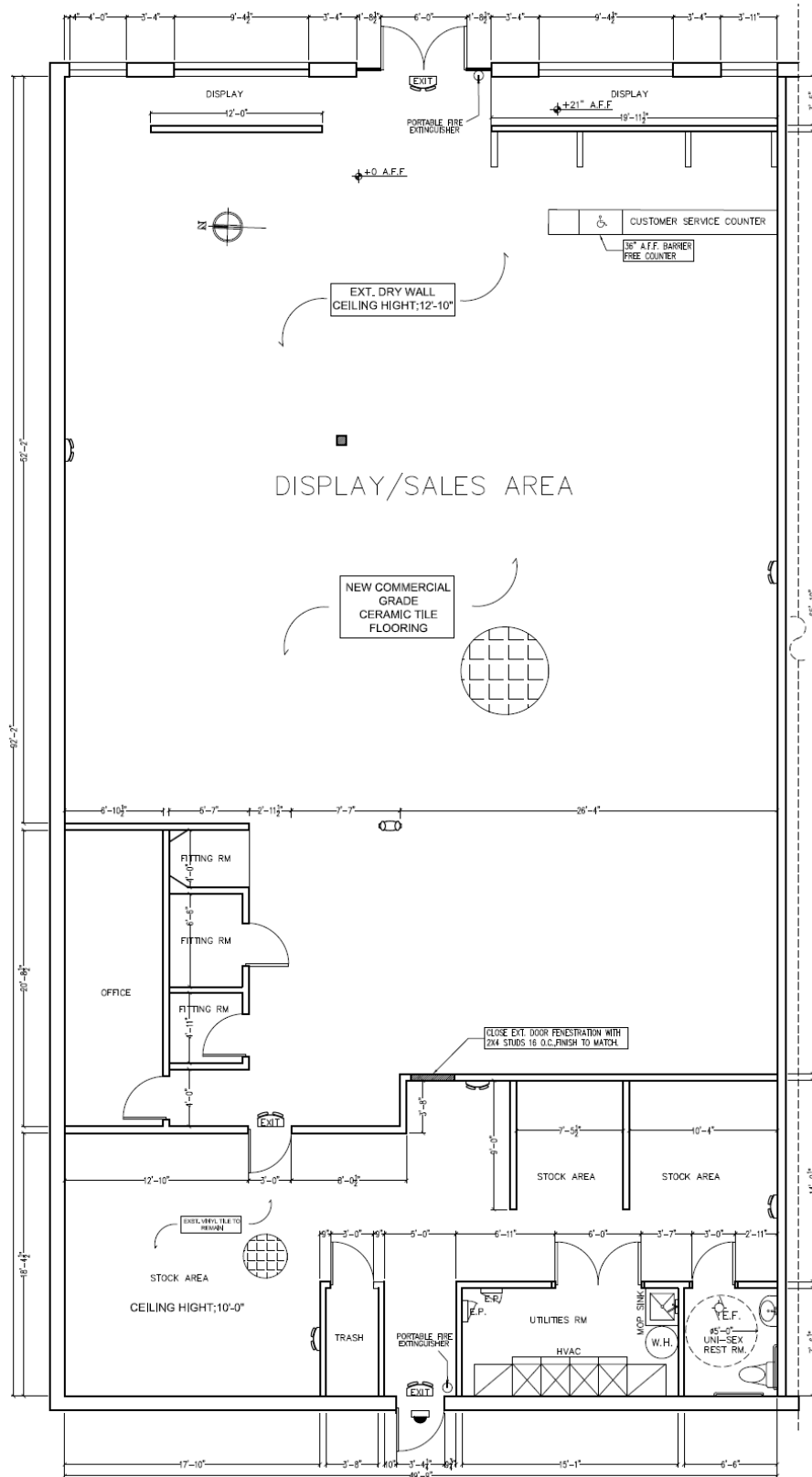

SITE HIGHLIGHTS

- Excellent exposure to northbound and southbound vehicles traveling Southfield Road - 41,240 vehicles per day
- Site is surrounded by dense residential and office population
- Convenient and abundant parking for your customers and employees
- Multiple curb cuts shared with adjoining retail centers for easy accessibility to the site
- Large façade for unparalleled signage opportunity
- Easily accessible by surrounding communities via Southfield Freeway and I-696
- Outstanding national co-tenancy in the immediate trade area including Panera Bread, FedEx Office, H&R Block, Ashley Stewart, and Lane Bryant
- Located kitty-corner to Lathrup Village's City Hall and police station, which draws crowds for community events, food truck rallies, and other city functions



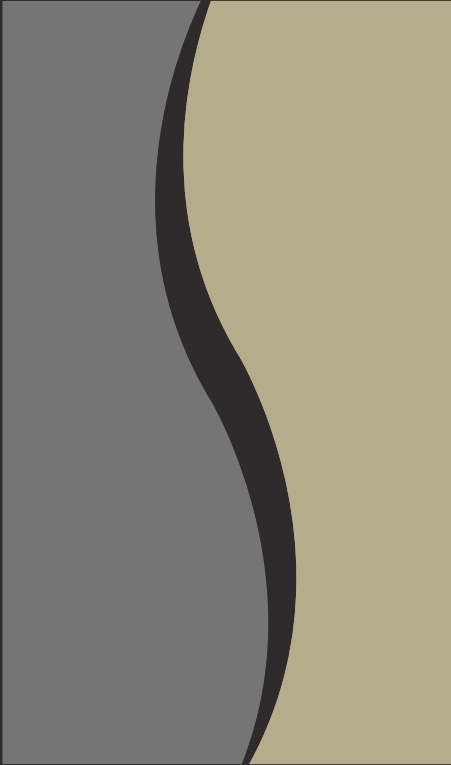

ABOUT US

The Surnow Company is a family owned, full service commercial real estate development, property management, asset management and brokerage firm.

We have a focused specialty in repurposing and redeveloping urban and suburban retail, office, and medical properties to fulfill our clients' needs, and to create greater value in the community each property is a part of.

Email or call today to discuss your commercial real estate needs, and we will proactively assist in achieving them.

