

FOR LEASE
NEW INDUSTRIAL SUITES

NEW CARMEN LOOP INDUSTRIAL

20729 Carmen Loop | Bend OR

Only 1 Space Left!



Available now! 8,400 +/- square foot industrial building. SDCs paid for warehouse use only.

Each unit has one 14 foot roll up door, one office, one ADA restroom. Gas heat in warehouse, electric heat in office and restroom. 3 phase in panel in each unit. 200 amp panel in each unit.

Suite 110: 1,800 +/- SF - LEASED
Suite 120: 2,400 +/- SF - AVAILABLE
Suite 130: 2,400 +/- SF - LEASED
Suite 140: 1,800 +/- SF - LEASED

Lease Rate:
\$0.75 /SF/Mo + NNN

- New construction
- Est. CAMs \$0.25/SF/Mo
- Zoning: Industrial Light - IL

Dan Steelhammer, Broker

dan@fratcommercial.com | O 541.306.4948 C 541.480.5756

Collier Ehlers, Broker

collier@fratcommercial.com | O 541.306.4948 C 541.602.0379



963 SW Simpson Ave., Suite 220 | Bend, OR 97702
541.306.4948 | www.fratzkecommercial.com

FOR LEASE
NEW INDUSTRIAL SUITES



FLOOR PLAN

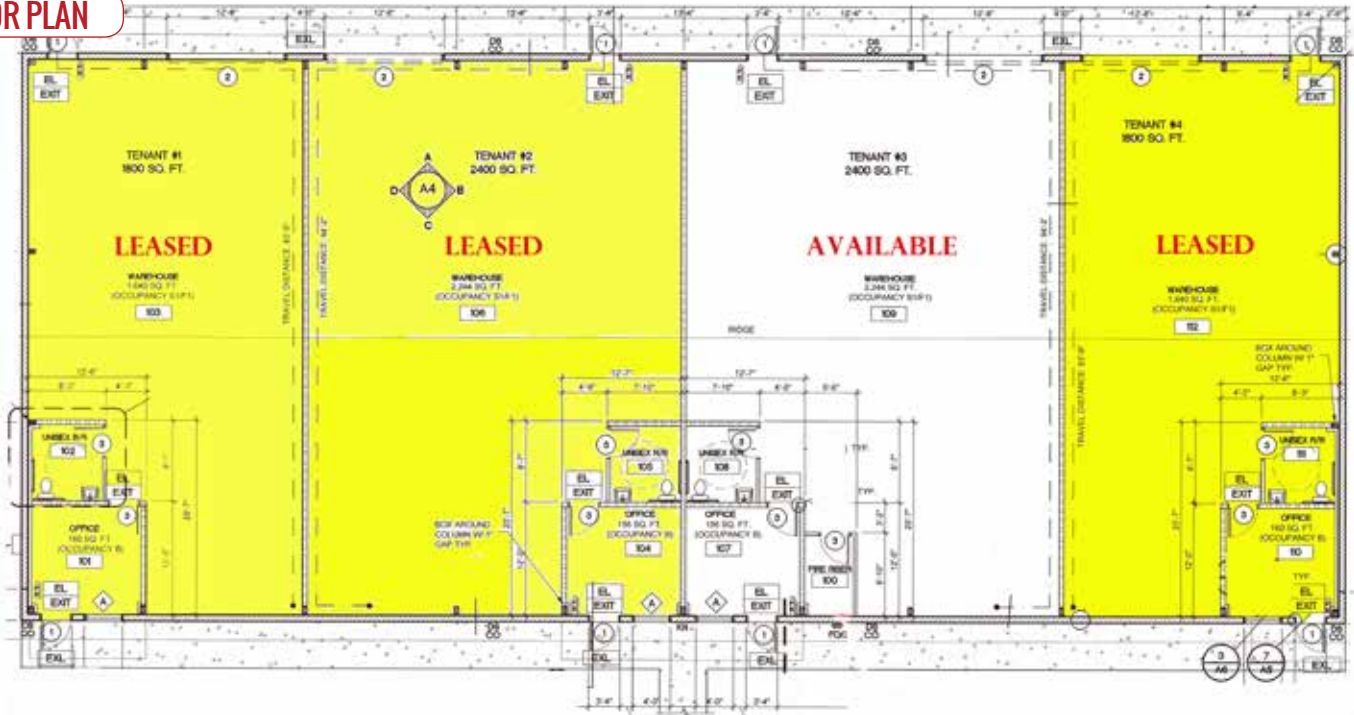

DAN STEELHAMMER
BROKER
541.480.5756 [C]
DAN@FRATCOMMERCIAL.COM



COLLIER EHLERS
BROKER
541.602.0379 [C]
COLLIER@FRATCOMMERCIAL.COM



With You Every Square Foot of the Way.

DISCLAIMER: This information is from sources we deem reliable, but for which we assume no liability. This is an exclusive listing. The information contained herein is given in confidence with the understanding that all negotiations pertaining to this property be handled through Fratzke Commercial Real Estate. All measurements are approximate.