



THE LANGHAM ESTATE

Looking for a property in
NOHO?
We've got it covered

SELF CONTAINED OFFICE BUILDING
76 Great Portland Street, London W1
FIRST-FOURTH FLOORS | 1,765 sq ft / 164 sq m



Located on the East side of Great Portland Street at its junction with Riding House Street. The area benefits from many restaurants and hotels and is within easy walking distance of Great Portland Street, Warren Street and Oxford Circus underground stations

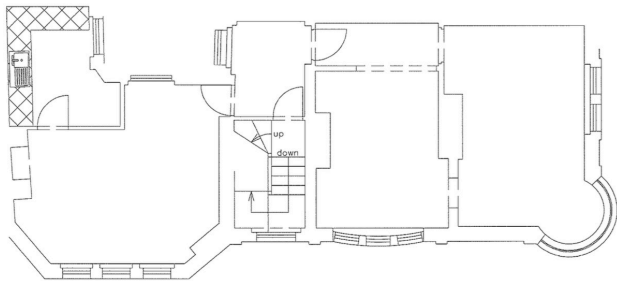

FIRST FLOOR | 485 SQ FT / 45 SQ M

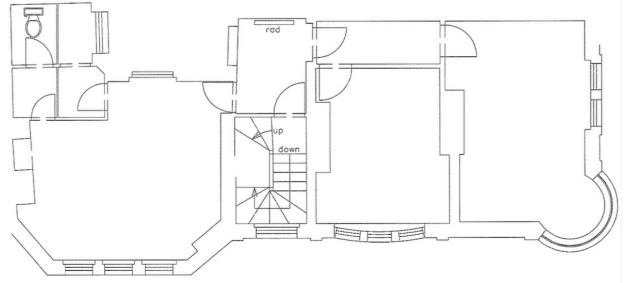

SECOND FLOOR | 485 SQ FT / 45 SQ M

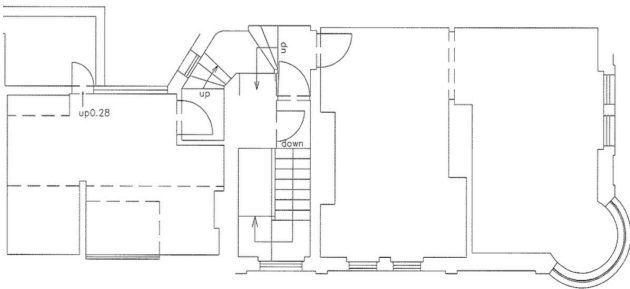

THIRD FLOOR | 515 SQ FT / 48 SQ M

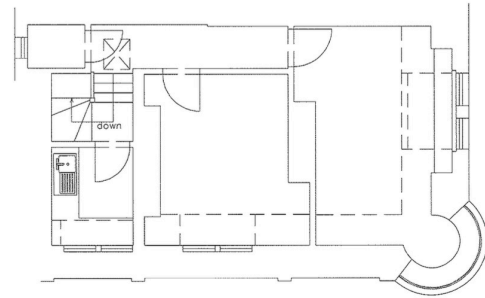

FOURTH FLOOR | 280 SQ FT / 26 SQ M (Residential Use)



Period Features
Pied a Terre
Original Sash Windows
Good Natural Light

Kitchen Facilities
WC's
Electric Heating
Entry Phone

RENT

On application

LEASE

A new Full Repairing & Insuring Lease is available for a term by arrangement, outside the Landlord & Tenant Act 1954.

POSSESSION

Immediate upon completion of legal formalities

For further information call
020 7580 5656

LanghamEstate.com | MyNoho.co.uk

MALCOLM COHEN

malcolm.cohen@langhamestate.com

020 7907 4983

07768 156 577

KELLY MYERS

kelly.myers@langhamestate.com

020 7907 4962

07739 220 411



Langham Estate Management Ltd, London House, 9A Margaret Street, London W1W 8RJ

Any property is offered subject to contract, availability, and confirmation of details. These particulars do not form part of any contract and, whilst believed to be correct, parties are recommended to satisfy themselves as to the accuracy. The Lessors or Langham Estate Management Limited, or any person in their employment, cannot make or give any representation or warranty whatsoever in relation to this property. Unless otherwise stated, all prices and rentals quoted are exclusive of any Value Added Tax to which they may be subject.