



11-13 Thames Street From Market Square



11-13 THAMES ST

KINGSTON UPON
THAMES KT1 1PH

PRIME GROUND FLOOR
RETAIL UNIT TO LET
4,982 SQ FT (463 SQ M)



- Redevelopment completing February 2021, following residential conversion of upper floors.
- Newly redeveloped retail unit at ground floor level.
- Primary frontage to Thames Street with visibility from Market Place.

Nearby retail occupiers include: ANTHROPOLOGIE





LOCATION

- Affluent London Borough of Kingston on Thames, with a total primary catchment of 897,000 residents.
- Part of a key aspirational shopping pitch.
- Prime position on Thames Street, providing an important link to John Lewis / Waitrose, Market Place and The Bentall Centre.
- The unit is located on Kingston's core retail circulation, including Clarence Street, Market Place (including the historic, thriving daily market) & Thames Street.
- Adjacent to Thames riverside restaurant quarter.

RETAIL ACCOMMODATION

INTERNAL WIDTH

44FT 3 IN (13.5M) reducing to 24FT 3IN (7.4M) at the rear

SHOP DEPTH

144 FT 3 IN (44 M)

GROUND FLOOR (GIA)

4,982 SQ FT (463 SQ M)

NEW LEASE

For a term of years to be agreed

RENT

Available on application

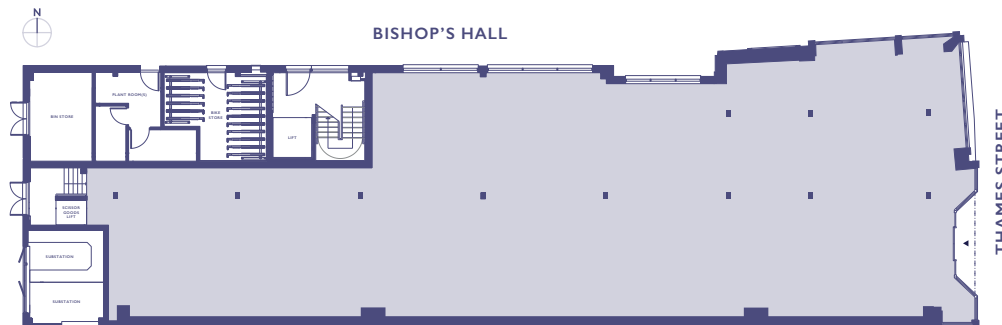

CONTACT

Viewings are strictly by prior appointment through the joint agents:

bf.
brasier freeth

DAMIAN SUMNER

07974 085738
damian.sumner@brasierfreeth.com

MARK SEGAL

07764 247875
mark.segal@brasierfreeth.com

GCW.

SIMON MORRIS

07974 170043
simon.morris@gcw.co.uk

CALLUM MORTIMER

07714 145932
callum.mortimer@gcw.co.uk



Disclaimer: These marketing details are intended as a guide and must not be relied upon as a statement of fact and they are expressly excluded from any contract. All prices/rents quoted are exclusive of VAT which may be payable. Regulated by RICS. October 2020.