

FOR LEASE

Pauley Way - 101



101 Pauley Way – Mankato, MN 56001

PROPERTY OVERVIEW

This newer multi-purpose facility offers great visibility and is located right off of Hwy 169 next to New Creation World Outreach Church and R&R Tire Shop. Built in 1995 with steel roof and siding, the current building use is for Potter's House of Prayer. Plenty of parking in a large lot that was resurfaced in 2012. The interior of this building is very clean and modern with large, open spaces. Remodeled 3,796 sq. ft. of office/retail space including new carpet, paint, offices, kitchen/break room, and restrooms. Property also features 1,440 sq. ft. of warehouse space with large overhead door which can be finished and joined with interior space.

FOR MORE INFORMATION CONTACT:

David Schooff SIOR, CCIM
david.schooff@cbcfishergroup.com

Cell

Direct (507) 625-0985
 (507) 382-2403

DETAILS

BLDG SIZE:	6,120 SQ FT
LEASE PRICE:	\$5,000.00/Month
LEASE TYPE:	Triple Net
YEAR BUILT:	1995
ZONING:	B-2

CBCFISHERGROUP.COM

Coldwell Banker Commercial and the Coldwell Banker Commercial Logo are registered service marks licensed to Coldwell Banker Commercial Affiliates. Each Office is Independently Owned and Operated. All information contained herein has been obtained from sources deemed reliable. However, no warranty or guarantee is made as to the accuracy of the information.

Coldwell Banker Commercial
 Fisher Group
 1961 Premier Drive
 Suite 404
 Mankato, MN 56001

FOR LEASE

Pauley Way - 101

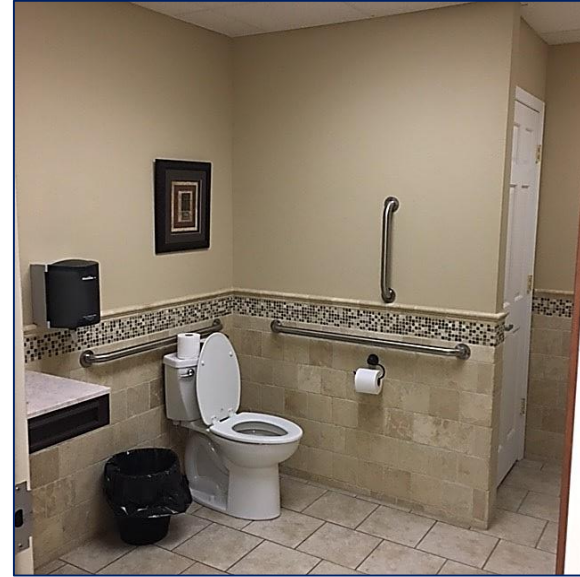

FOR MORE INFORMATION CONTACT:

David Schooff SIOR, CCIM
david.schooff@cbcfishergroup.com

Direct (507) 625-0985
 Cell (507) 382-2403

CBCFISHERGROUP.COM

Coldwell Banker Commercial and the Coldwell Banker Commercial Logo are registered service marks licensed to Coldwell Banker Commercial Affiliates. Each Office is Independently Owned and Operated. All information contained herein has been obtained from sources deemed reliable. However, no warranty or guarantee is made as to the accuracy of the information.

Coldwell Banker Commercial
 Fisher Group
 1961 Premier Drive
 Suite 404
 Mankato, MN 56001

FOR LEASE Pauley Way - 101



Floor Plan

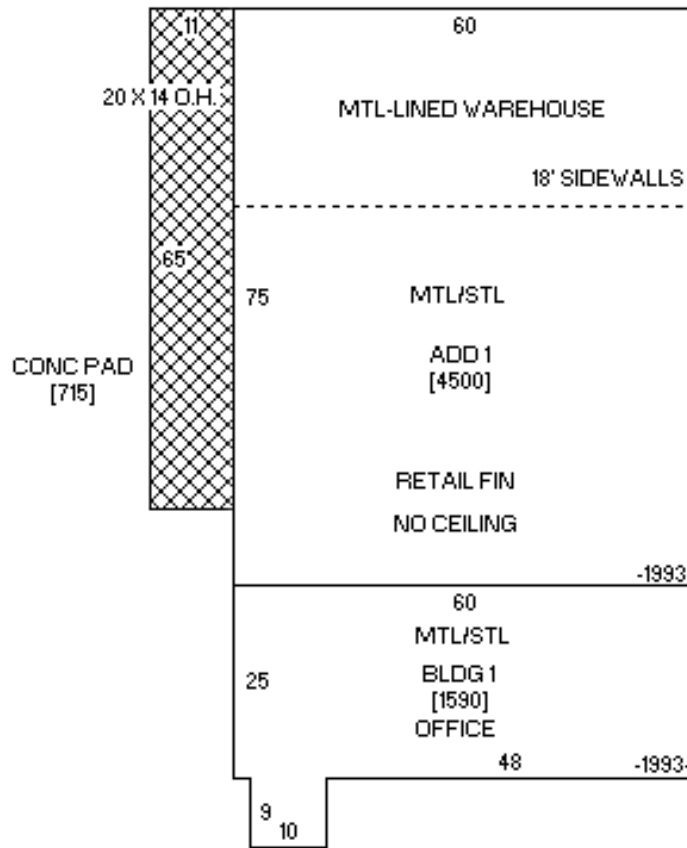

Sketch by www.camavision.com

FOR MORE INFORMATION CONTACT:

David Schooff SIOR, CCIM
david.schooff@cbcfishergroup.com

Direct (507) 625-0985
 Cell (507) 382-2403

CBCFISHERGROUP.COM

Coldwell Banker Commercial
 Fisher Group
 1961 Premier Drive
 Suite 404
 Mankato, MN 56001

Coldwell Banker Commercial and the Coldwell Banker Commercial Logo are registered service marks licensed to Coldwell Banker Commercial Affiliates. Each Office is Independently Owned and Operated. All information contained herein has been obtained from sources deemed reliable. However, no warranty or guarantee is made as to the accuracy of the information.

FOR LEASE Pauley Way - 101



FOR MORE INFORMATION CONTACT:

David Schooff SIOR, CCIM
david.schooff@cbcfishergroup.com

Direct (507) 625-0985
Cell (507) 382-2403

CBCFISHERGROUP.COM

Coldwell Banker Commercial
Fisher Group
1961 Premier Drive
Suite 404
Mankato, MN 56001

Coldwell Banker Commercial and the Coldwell Banker Commercial Logo are registered service marks licensed to Coldwell Banker Commercial Affiliates. Each Office is Independently Owned and Operated. All information contained herein has been obtained from sources deemed reliable. However, no warranty or guarantee is made as to the accuracy of the information.