



250 South Oak Way
To let: from 1,107 ft²

Positioned at the heart of Green Park on Lime Square, offering a range of facilities including WH Smith, Asda Click 'n' Collect, Nuffield Health & Fitness club, Zest Bar & Brasserie, WOLF Italian Street Food and the Green Park Day Nursery.

Specification

- VRF air conditioning
- Full access raised floors
- Suspended ceiling
- Excellent car parking ratio
- Showers and bike racks
- Two 1,000kg capacity passenger lifts
- Manned reception
- 24 hour security on the Park
- EPC – C (56)

GreenPark 
a mapletree property

250 South Oak Way

Floorplans

Schedule of areas

Suite	sq ft	sq m	Parking	Let to
Second floor				
Suite 17-23	11,939	1,109	38	Available
Suite 24	2,893	269		GMC Software
Suite 25	4,594	427		Texas Instruments
First floor				
Suite 8	5,302	493	17	Available
Suite 9-11	2,810	261		JLT
Suite 12	1,001	93		Itery
Suite 13	996	93		ISG
Suite 14	1,107	95		Available soon
Suite 15 & 16	7,606	707		LivePerson
Ground floor				
Suite 1	4,811	447		Grow @ Green Park
Suite 7	7,655	711	24	Available

All sizes are approximate IPMS areas

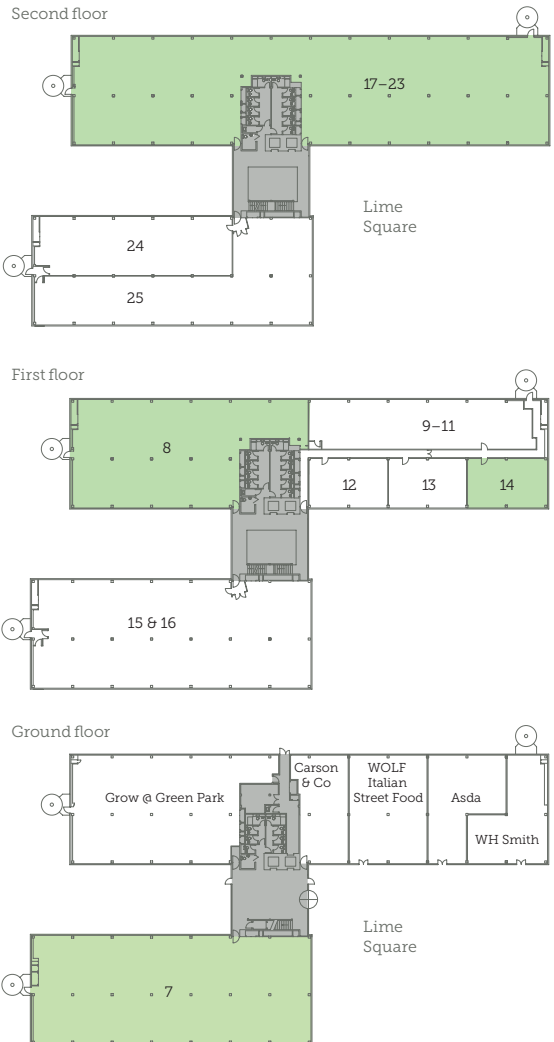

greenpark.co.uk

Letting Agents



@GreenParkUK



@greenparkreading



GreenParkUK