



INTERNATIONAL TRADEPORT

BUILDING II | 13291 VANTAGE WAY, SUITE 107 | JACKSONVILLE, FL 32218



PROPERTY HIGHLIGHTS

SUITE:	107
AVAILABLE SPACE:	14,958 SF
OFFICE SPACE:	2,011 SF
AUTO PARKING:	217 Spaces
LOADING:	Rear Load Distribution
CLEAR HEIGHT:	24'
COLUMN SPACING:	45' x 40'
FIRE PROTECTION:	Fully Sprinklered
TRUCK DOORS:	1 (9' x 10') Grade Level
ELECTRICAL:	600 AMP 480/277 V
WAREHOUSE LIGHTING:	T-5 Fluorescent
CONSTRUCTION TYPE:	Tilt-Wall

FOR MORE INFORMATION PLEASE CONTACT:

Nathan Rogers

First Vice President
+1 904 630 6375
nathan.rogers@cbre.com

CBRE, Inc. | Licensed Real Estate Broker



FLOOR PLAN

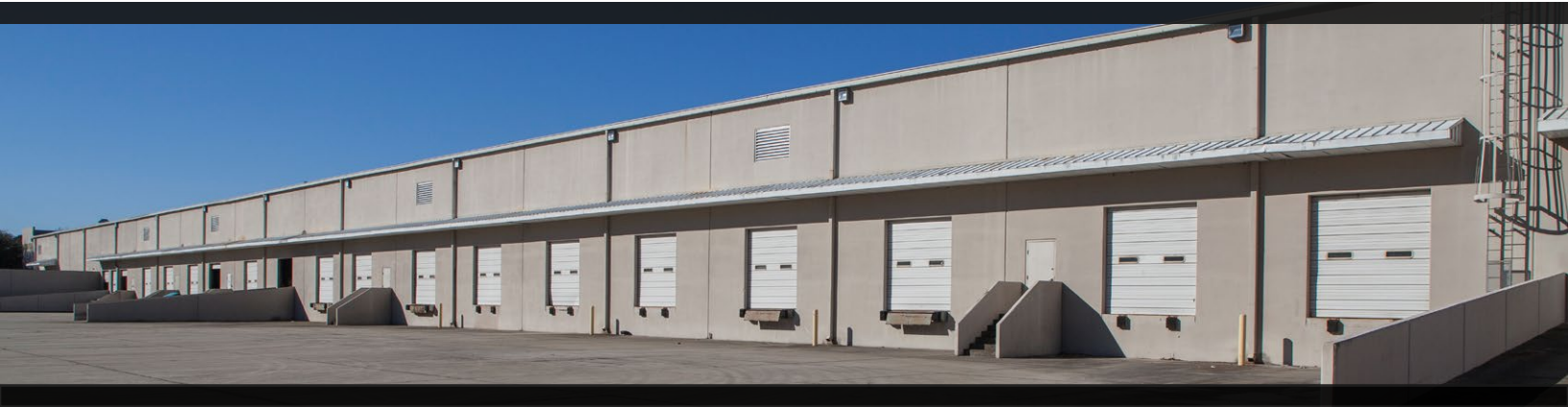
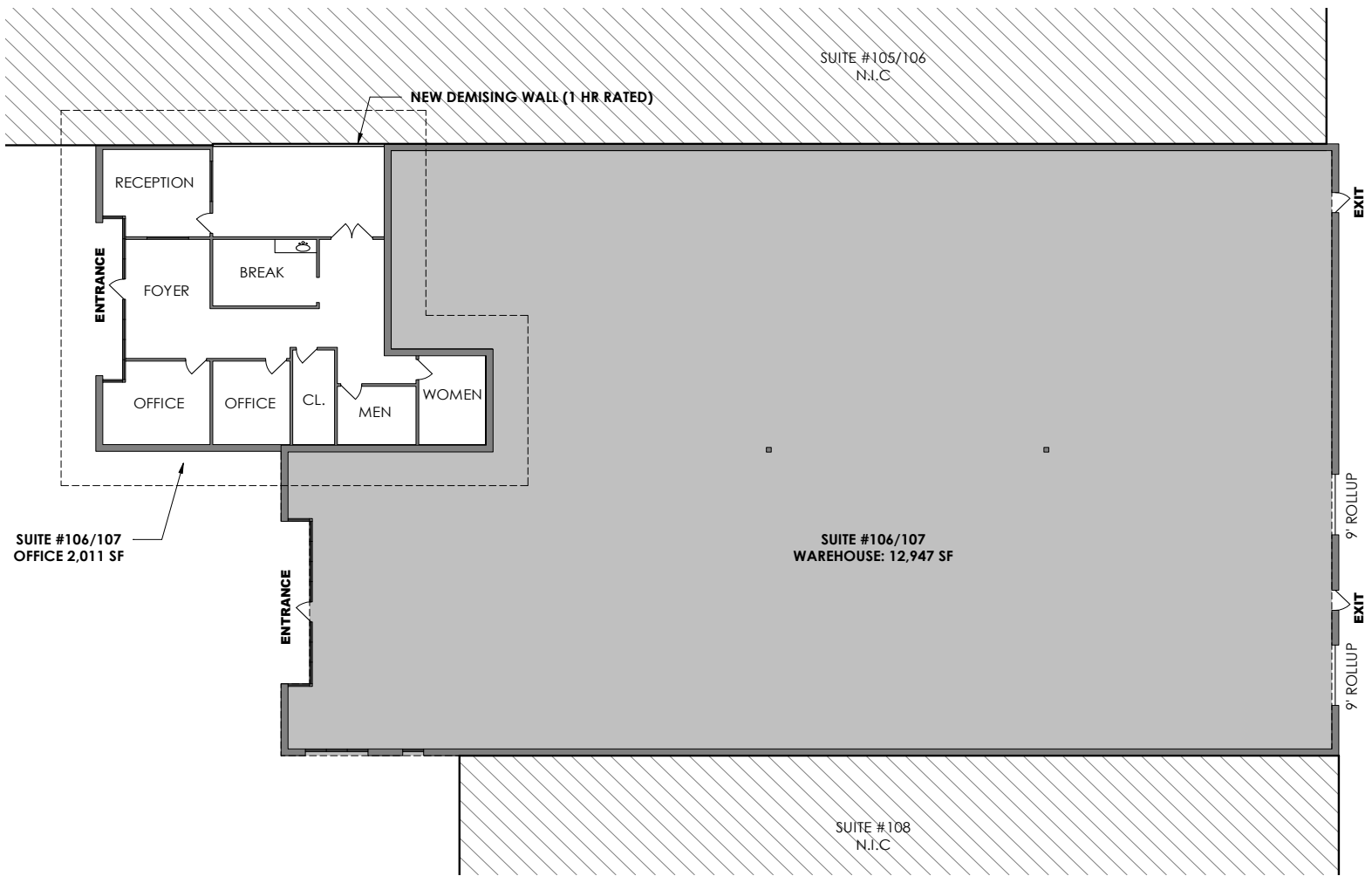

FOR MORE INFORMATION PLEASE CONTACT:

Nathan Rogers

First Vice President

+1 904 630 6375

nathan.rogers@cbre.com

CBRE, Inc. | Licensed Real Estate Broker

225 Water Street | Suite 110 | Jacksonville, FL 32202

FOR MORE INFORMATION VISIT:

[www.cbre.com/
InternationalTradeport](http://www.cbre.com/InternationalTradeport)



© 2018 CBRE, Inc. All rights reserved. This information has been obtained from sources believed reliable, but has not been verified for accuracy or completeness. You should conduct a careful, independent investigation of the property and verify all information. Any reliance on this information is solely at your own risk.